

OREGON CORNER RESTORATION FORM

Section 9 Township 5S Range 32E
 County Umatilla Date: October 25th, 2021

Corner Designation: 5S32E13 Condition report only
 Not Found
 Corner to Sections 3, 4, 9, and 10, T5S, R32E, W.M., Umatilla County, Oregon. X Remonumented
 Unrecorded
 Surveyed In
X Referenced Out

Previous Renewals, Surveys, etc...

This corner was originally set by George S. Pershin under Contract No. 390, Dated May 12th, 1881. His Record reads: Set basalt stone 14x12x4 on a rocky point, extending W. for Cor. To Secs. 3, 4, 9, & 10. A pine, 32 ins. Diam. Brs. N28°E, 137 lks. Dist. A pine, 12 ins. Diam. Brs. S44°E, 145 lks. Dist. A pine, 26 ins. Diam. Brs. S27°W 188 lks. Dist. No tree N.W.

Monument and accessories found: (condition and source)

Found the NE BT down and rotted. Found the SE BT with a healed blaze. Partially opened the blaze revealing a part of the original scribe marks. Did not completely open the blaze. Found no trace of the original stone. There was evidence of more than one rock jack being built in this location.

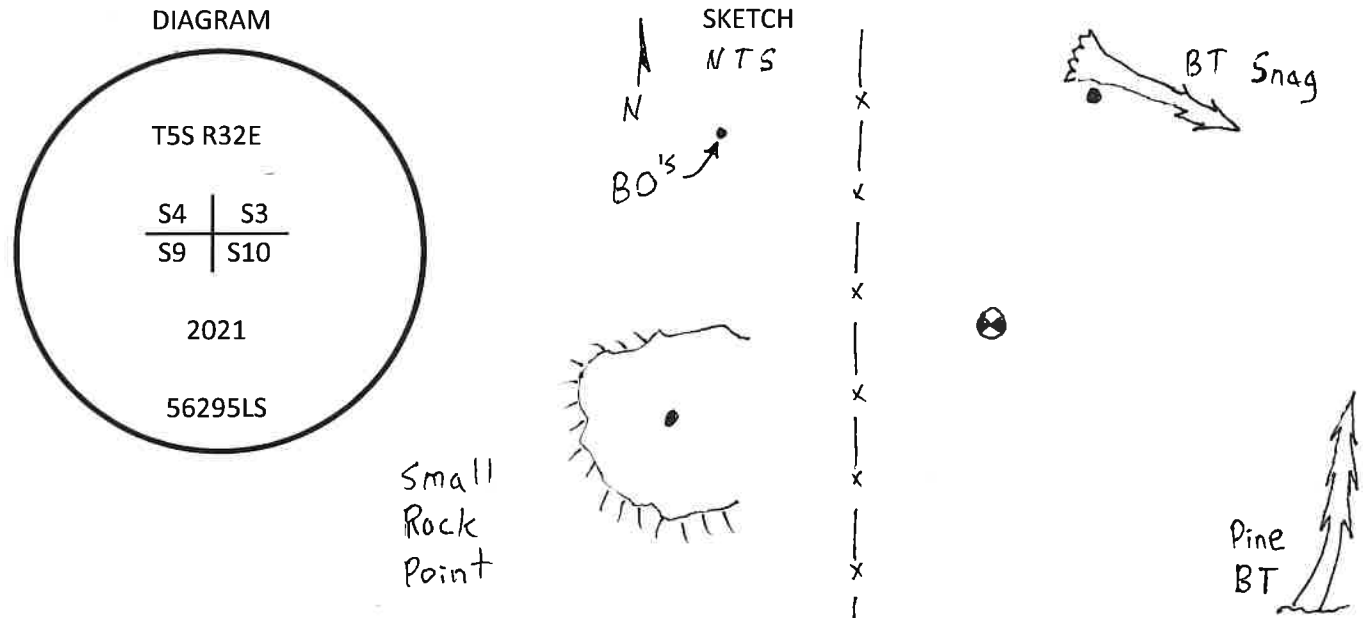

MONUMENT(S) AND ACCESSORIES SET (Procedures and Description)

At the position of the corner determined by distance-distance from the two found bearing trees, I set a 2 1/4" Brass Cap on a 30" galvanized iron pipe flush with the surface of the ground. The cap was stamped as shown in the diagram above.

For references I set three 5/8" by 24" iron rebars with 1.25" orange plastic caps stamped WTS and 56295LS as described below:

- An iron rebar bears S85°15'23"W 52.73 feet, set flush in the top of a small rock pinnacle;
- An iron rebar bears N15°05'44"W 70.56 feet;
- An iron rebar bears N25°36'49"E, 89.61 feet, at the base of the original down NE BT;
- The original SE bearing tree bears S42°41'45"E, 95.70 feet;

The monument was reset and bearing objects tied using a Trimble R8S RTK GPS system.

Location and comments:
 Approximately 240 feet east
 of Cable Creek Road.

Compass Declination
 Firm / Agency
 Witness Tree Surveying
 Address
 P.O. Box G
 Pilot Rock, OR 97868
 Party Chief
 Stephen K. Haddock

Surveyor's Seal

REGISTERED
 PROFESSIONAL
 LAND SURVEYOR
Stephen K. Haddock
 OREGON
 JULY 9, 2001
 STEPHEN K. HADDOCK
 56295LS

RECEIVED BY:
 Umatilla County Surveyor
 Date: 12/16/21
 Rec'd By: CT
 No. 21-145-B

RENEWS: 6-30-23