

CERTIFIED RECORD OF LAND CORNER MONUMENTATION

W-17

History of original corner establishment:

Corner position determined by the Bureau of Land Management by survey during 1968-1980,

Set an iron post, 28 ins. long, 2 1/2 ins. diam., 22 ins. in the ground, in a mound of stone 2 1/2 foot base to top, with brass cap marked:

From which: N 1/16

- A Fir, 15 ins diam. bears N 85 1/2°E 122 lks. dist., mkd. N 1/16 S35 BT. S34 S35 1968
- A Fir, 10 ins. diam., bears N85°W 18 lks. dist., mkd. N 1/16 S34 BT.

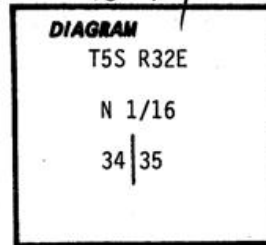

Description of corner evidence found:

Found an iron pipe, 2 1/2" diam., firmly set as described in the BLM record, with brass cap attached, marked:

From which the original BLM bearing trees:

- An 18" White Fir, alive and well-healed, bears N85 1/2°E 80.5 feet,
- And a 10" White Fir, now dead with well-healed blaze bears N85°W 11.9 ft.

U.S. Dept. of Interior
 Bureau of Land Management
 N 1/16
 S34 + S35
 1968

Description of monument and accessories established to perpetuate the original location of this corner:

We mark a new BT"

A 12" White Fir, scribed "N 1/16 S34 BT" on a double blaze, bears S 79°W 18.2 ft.

Attached brass washer marked "LS 1099" to lower blaze.

Magnetic Compass (20° East Declination)
Steel Tape

August 16, 1984

Witnesses:

- Gary Langlitz, LS 1099
- Ray Crapo
- Greg Orton

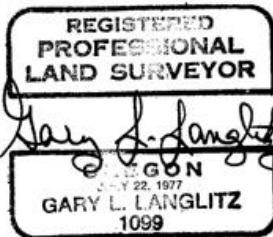

Office of Surveyor County of Umatilla

State of Oregon I hereby certify that the within instrument was filed in this office for record on the 20th day of October 1984

David Lumber by Betty Cochran

(COUNTY OFFICIAL) (DEPUTY)