

Index
File No. Z-25
T 5S R. 31E
Merid. Willamette

CORNER RECORD (SEARCH)
(Ref. FSM 7151.4)

Tract or Survey No. 5-5 Cor. No. Z-25

R.D. Ukiah County Umatilla
N.F. Umatilla State Oregon

CORNER DIAGRAM

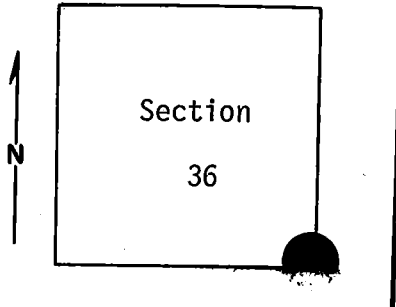

DESCRIBE CORNER MONUMENT FOUND

Material: Iron pipe with Brass Cap.
Size: 2" pipe, 3 1/4" cap.
20" above ground; good condition.
Set in stone mound, mound has 5' diameter, (cont. in block 12)

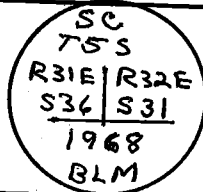

DESCRIBE BEARING TREES OR OTHER OFFICIAL ACCESSORIES FOUND

A 24" p.pine with B.T. tag bears N21°W, approximately 320 feet. Scribed T5S, R31E, S36, SC, B.T. Apparently established 1968.
A 17" p.pine with B.T. tag bears N81°E approximately 135 feet. Scribed T5S, R32E, S31, SC, B.T. Apparently established 1968.
A warning poster and an old location poster on fence near monument.

DESCRIBE CORNER LOCATION RELATIVE TO NEAR-BY FEATURES, ALSO HOW TO REACH CORNER

From forest boundary on road S-522, proceed east on road S-522 for about 1 mile. Walk north about 500 feet to fence (corner of S5 and S6, T6S, R32E is about 300 feet east on same fence line).

PHOTO IDENTIFICATION DATA

Photo No. _____
Filed At. _____
Object Ident. _____
Ident. By _____
Signature

PLANE COORDINATE POSITION DATA

State _____ Zone _____
X _____
Y _____
Estab. By _____
Agency

Signature T. Hollamon *Title* Engineering Technician *Division* Headquarters *Headquarters* S. O. *Date* March 21, 1974 7100-52-(3/68)

CORNER RECORD (PERPETUATION)

MONUMENT: DESCRIBE NEW MONUMENT SET, OR WORK DONE TO PRESERVE EXISTING MONUMENT

ACCESSORIES : DESCRIBE NEW BT'S WITNESS OBJECTS ETC. ESTABLISHED, OR WORK DONE TO PRESERVE EXISTING EVIDENCE

9

10

Work Done By _____ Title _____ Date _____ State Registration No. _____
or Agency _____

Certified Cor. Record Prepared ? Yes No Filed At: _____ Date _____ 11

REMARKS

(Block #2, cont.)
20 inches deep. (Monument 3 feet north of fence.)

12

Index File No. T. R. M. Tract or Surv. No. Cor. 13

Index
File No. Z-1

CORNER RECORD (SEARCH)
(Ref. FSM 7.151.4)

Tract or
Survey No. _____ Cor.
No. _____

T 5S R. 32E
Merid. WILLAMETTE

R.D. UKIAH County UMATILLA
N.F. UMATILLA State OREGON

CORNER DIAGRAM

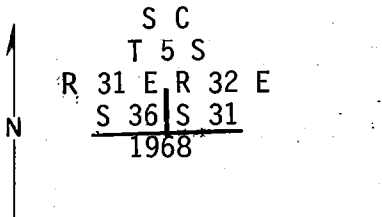

DESCRIBE CORNER MONUMENT FOUND
Found an iron pipe, firmly set,
2½ ins. diam., in a mound of
stone, 4 ft. base, to top,
with brass cap mkd.

U.S. Dept. of Interior
Bureau of Land Management

S C
T 5 S
R 31 E R 32 E
S 36 | S 31

DESCRIBE BEARING TREES OR OTHER OFFICIAL ACCESSORIES FOUND 1968

A Ponderosa Pine, 20 ins. diam., bears N. 80½°E., 205 lks. dist.,
scribing visible on partially healed blaze.
A Ponderosa Pine, 28 ins. diam., bears N. 22°W., 478 lks. dist.,
scribing visible on partially healed blaze.

PHOTO IDENTIFICATION DATA

Photo No. 280-292
Filed At. UMATILLA NAT. FOR.
Object Ident. SUB. STA.
Ident. By D. J. Smith
Signature

DESCRIBE CORNER LOCATION RELATIVE TO NEAR-BY FEATURES, ALSO HOW TO REACH CORNER

PLANE COORDINATE POSITION DATA

State _____ Zone _____
X _____
Y _____
Estd. By _____

Signature
Signature _____
Agency _____

Title LS 1099 Division _____ Headquarters _____

Date 9-18-64

CORNER RECORD (PERPETUATION)

MONUMENT: DESCRIBE NEW MONUMENT SET, OR WORK DONE TO PRESERVE EXISTING MONUMENT

NONE

ACCESSORIES : DESCRIBE NEW BT's WITNESS OBJECTS ETC. ESTABLISHED, OR WORK DONE TO PRESERVE EXISTING EVIDENCE

NONE

Work Done By: GARY LANGLITZ Title LS 1099 Date 8-84 State Registration No. or Agency _____

Certified Cor. Record Prepared? Yes No Filed At: _____ Date _____

REMARKS

Index File No. Z-1 T. 55 R. 326 M. WILLAMETTE Tract or Surv. No. _____ Cor. _____