

CERTIFIED RECORD OF LAND CORNER MONUMENTATION

Index File No. B-25

**History of original corner establishment:**

No corner was originally set.

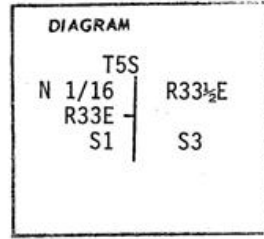

**Description of corner evidence found:**

**Description of monument and accessories established to perpetuate the original location of this corner**

At surveyed point set 3" brass tablet in mortar in large rock outcropping stamped.

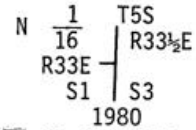

**Bearing Trees:**

A Ponderosa Pine 5" dia. bears S77°W, 106.2 ft., scribed N 1/16 S1BT. OR PLS 1294  
A Juniper 9" dia., bears N51°W, 29.7 ft., scribed N 1/16 S1 BT.

Attached 54-3 and 54-4 signs to both BTs. Attached brass washer stamped LS 1294 to foot blaze of both BTs. Painted blazes and 6" band around both BTs red. Attached 54-2 and 54-4 signs to metal post 6 ft. South of corner. Attached 54-2 and 54-9 signs to metal post 12 ft. West of corner.

I hereby certify the above corner monument was established as herein described on June 23, 1980.

Witnesses: R. Orton  
G. Orton  
D. Allen

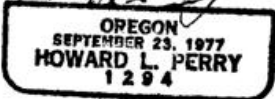
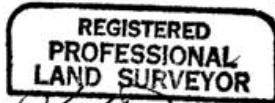

Office of County Surveyor County of Umatilla  
State of Oregon, I hereby certify that the within instrument was filed in this office for record on the December day of 1980.  
David A. Krumbein by Betty Hutto  
(COUNTY OFFICIAL) (DEPUTY)