

USDA-FOREST SERVICE

Index

File No. H-24

T 5S R. 33E

Merid. Willamette

**CORNER RECORD (SEARCH)**

(Ref. FSM 7151.4)

R.D. Ukiah County Umatilla Tract or Survey No. \_\_\_\_\_

N.F. Umatilla State Oregon Cor. No. SE 1/16

**CORNER DIAGRAM**

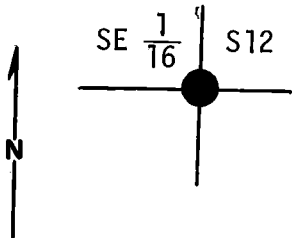

**DESCRIBE CORNER MONUMENT FOUND**

None Set

**DESCRIBE BEARING TREES OR OTHER OFFICIAL ACCESSORIES FOUND**

None Set

**PHOTO IDENTIFICATION DATA**

Photo No. \_\_\_\_\_

Filed At. \_\_\_\_\_

Object Ident. \_\_\_\_\_

Ident. By \_\_\_\_\_

*Signature*

**PLANE COORDINATE POSITION DATA**

State \_\_\_\_\_ Zone \_\_\_\_\_

X \_\_\_\_\_

Y \_\_\_\_\_

Estab. By \_\_\_\_\_

*Agency*

**DESCRIBE CORNER LOCATION RELATIVE TO NEAR-BY FEATURES, ALSO HOW TO REACH CORNER**

Corner falls on NE side of old closed off logging road, and approx. 1200 ft east on location tag on USFS Road No. 5160-410.

*Signature*  
*Howard G. [unclear]*

Title

Division  
ORLS

Headquarters  
1294

Date  
9-77

7100-52-(3/68)

**CORNER RECORD (PERPETUATION)**

**MONUMENT: DESCRIBE NEW MONUMENT SET, OR WORK DONE TO PRESERVE EXISTING MONUMENT**

At surveyed point set 2 1/2" X 30" galvanized pipe with brass cap stamped:

Set pipe 24" in ground with mound of stone to cap.

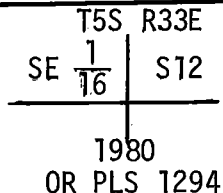

9

**ACCESSORIES : DESCRIBE NEW BT'S WITNESS OBJECTS ETC. ESTABLISHED, OR WORK DONE TO PRESERVE EXISTING EVIDENCE**

Bearing Trees:

A Lodge Pole Pine 8" dia bears N45°E, 26.2 ft., scribed SE1/16 S12 BT.

A Tamarack 18" dia bears S24°W, 47.0 ft., scribed SE1/16 S12 BT.

Attached 54-3 & 54-4 signs to both BTs. Attached brass washer stamped LS 1294 to foot blaze of both BTs. Painted blazes and 6" band around both BTs Red. Attached 54-2 & 54-4 signs to metal post 5 ft west of corner. Attached 54-2 & 54-9 signs to metal post 5 ft south of corner.

10

Work Done By R. C. Orton Title Party Chief Date 7-8-80 State Registration No. or Agency \_\_\_\_\_

Certified Cor. Record Prepared ? (Yes)  No  Filed At: \_\_\_\_\_ Date \_\_\_\_\_

11

**REMARKS**

Witnesses: R. Orton  
L. Huntsman  
D. Allen

Index File No.	T.	R.	M.	Tract or Surv. No.	Cor.
<u>H-24</u>	<u>55</u>	<u>33E</u>			U.S. G.P.O. 1977-725-576/586

12

13