

USDA-FOREST SERVICE

Index
File No. N-5
T 55 R. 33E
Merid. Willamette

CORNER RECORD (SEARCH)

(Ref. FSM 7151.4)

R.D. Ukiah County Umatilla
N.F. Umatilla State Oregon

Tract or
Survey No. _____
Cor. No. Sec Cor

CORNER DIAGRAM

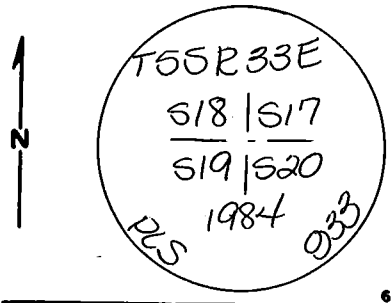

DESCRIBE CORNER MONUMENT FOUND

None

DESCRIBE BEARING TREES OR OTHER OFFICIAL ACCESSORIES FOUND

None

PHOTO IDENTIFICATION DATA

Photo No. _____
Filed At. _____
Object Ident. _____
Ident. By _____
Signature

PLANE COORDINATE POSITION DATA

State _____ Zone _____
X _____
Y _____
Estab. By _____
Agency

DESCRIBE CORNER LOCATION RELATIVE TO NEAR-BY FEATURES, ALSO HOW TO REACH CORNER

A fence corner is 16 feet North and 55 feet East. Fence runs West and North. From Hiway Springs take Rd 5450 South 1.5 mi. to road on right, take road 0.7 mi. to fork, corner is West along fence line

Signature David H Khan Title PLS 933 Division _____ Headquarters _____ Date 7/16/84 7100-52-(3,68)

CORNER RECORD (PERPETUATION)

MONUMENT: DESCRIBE NEW MONUMENT SET, OR WORK DONE TO PRESERVE EXISTING MONUMENT

Set a 2 1/2" dia. Brass Cap on a 2 1/2" x 30" galvanized pipe 12" in the ground.

Built a stone mound around the Brass Cap

ACCESSORIES : DESCRIBE NEW BT'S WITNESS OBJECTS ETC. ESTABLISHED, OR WORK DONE TO PRESERVE EXISTING EVIDENCE

A 10" dia. Ponderosa Pine bears S57°E, 242.0 feet

A 8" dia. Ponderosa Pine bears N89°E, 332.4 feet

Set 5/8" x 30" iron pins with a 1 1/2" aluminum cap stamped with an arrow and distance. A 5/8" bears S67°W, 13.30 feet, and a 5/8" bears N28°W, 22.1 feet

BT's have signs #54-3 & 54-4 and Brass Washers

Work Done By R Panches Title Party Chief Date 8-1-84 State Registration No. or Agency

Certified Cor. Record Prepared? Yes No Filed At: Umatilla County Surveyor Date 8-7-84

REMARKS

Index

File No. N-5

CORNER RECORD (SEARCH)

(Ref. FSM 7151.4)

Tract or

Survey No. _____

Cor.

No. _____

T 55 R. 33E

R.D. UKIAH County UMATILLA

Merid. WILL

N.F. UMATILLA State OREGON

CORNER DIAGRAM

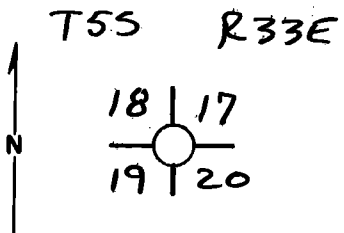

DESCRIBE CORNER MONUMENT FOUND

NONE -

DESCRIBE BEARING TREES OR OTHER OFFICIAL ACCESSORIES FOUND

NONE SET - SEARCH AREA IN VICINITY OF FENCE CORNER - FENCES RUN N & W. REMAINS OF OLD FENCE RUNS S & E.

PHOTO IDENTIFICATION DATA

Photo No. _____

Filed At. _____

Object Ident. _____

Ident. By _____

Signature

PLANE COORDINATE POSITION DATA

State _____ Zone _____

X _____

Y _____

Estab. By _____

Agency

Signature

Title

Division

Headquarters

Date

7100-52 (3. 68)

Dennis L. Gaylord PLS 1636

8-27-82

CORNER RECORD (PERPETUATION)

MONUMENT : DESCRIBE NEW MONUMENT SET, OR WORK DONE TO PRESERVE EXISTING MONUMENT

ACCESSORIES : DESCRIBE NEW BT'S WITNESS OBJECTS ETC. ESTABLISHED, OR WORK DONE TO PRESERVE EXISTING EVIDENCE

Work Done By _____ Title _____ Date _____ State Registration No. _____
or Agency _____
Certified Cor. Record Prepared ? Yes No Filed At: _____ Date _____

REMARKS

Index File No. T. R. M. Tract or Surv. No. Cor.

Index
File No. N-5

CORNER RECORD (SEARCH)

(Ref. FSM 7151.4)

Tract or Survey No. 5-90 Cor. No. N-5

T 5S R. 33E

R.D. Ukiah County Umatilla

Merid. Willamette

N.F. Umatilla State Oregon

CORNER DIAGRAM

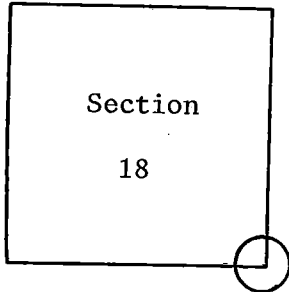

DESCRIBE CORNER MONUMENT FOUND

Material: None.

DESCRIBE BEARING TREES OR OTHER OFFICIAL ACCESSORIES FOUND

Fences only.

Corner location in open field.

PHOTO IDENTIFICATION DATA

Photo No.

Filed At.

Object Ident.

Ident. By

Signature

PLANE COORDINATE POSITION DATA

State Zone

X

Y

Estab. By

Agency

DESCRIBE CORNER LOCATION RELATIVE TO NEAR-BY FEATURES, ALSO HOW TO REACH CORNER

Signature
T. Hollamon

Title
Engineering Technician

Division
S. O.

Date
December 9, 1974

7100-52-(3/68)

CORNER RECORD (PERPETUATION)

MONUMENT: DESCRIBE NEW MONUMENT SET, OR WORK DONE TO PRESERVE EXISTING MONUMENT

ACCESSORIES : DESCRIBE NEW BT'S WITNESS OBJECTS ETC. ESTABLISHED, OR WORK DONE TO PRESERVE EXISTING EVIDENCE

Work Done By _____ Title _____ Date _____ State Registration No. _____
or Agency _____

Certified Cor. Record Prepared ? Yes No Filed At: _____ Date _____

REMARKS

Index File No. T. R. M. Tract or Surv. No. Cor. _____