

USDA-FOREST SERVICE

Index File No. N-9

T 55 R. 33E

Merid. Willamette

CORNER RECORD (SEARCH)

(Ref. FSM 7151.4)

R.D. Ukiah

N.F. Umatilla

Tract or

Survey No. _____

Cor.

No. Sec Cor

County Umatilla

State Oregon

CORNER DIAGRAM

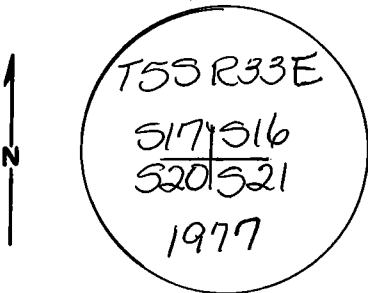

DESCRIBE CORNER MONUMENT FOUND

A 2 1/2" dia Brass Cap set by BLM

DESCRIBE BEARING TREES OR OTHER OFFICIAL ACCESSORIES FOUND

A 18" dia Fir bears N72° E, 44 IKS

A 7" dia Fir bears S43° E, 27 IKS

A 5" dia Fir bears S53° W, 87 IKS

A 10" dia Fir bears N72° W, 94 IKS

PHOTO IDENTIFICATION DATA

Photo No. _____

Filed At. _____

Object Ident. _____

Ident. By _____

Signature

PLANE COORDINATE POSITION DATA

State _____ Zone _____

X _____

Y _____

Estab. By _____

Agency

DESCRIBE CORNER LOCATION RELATIVE TO NEAR-BY FEATURES, ALSO HOW TO REACH CORNER

Corner is South 0.2 mile from pool at
Hideway Springs

David H. Klein

Signature

PLS 933

Title

Division

Headquarters

Date

7/16/84

7100-52 (3/68)

CORNER RECORD (PERPETUATION)

MONUMENT: DESCRIBE NEW MONUMENT SET, OR WORK DONE TO PRESERVE EXISTING MONUMENT

None

ACCESSORIES : DESCRIBE NEW BT'S WITNESS OBJECTS ETC. ESTABLISHED, OR WORK DONE TO PRESERVE EXISTING EVIDENCE

None

Work Done By R Ritches Title Party Chief Date 7/9/84 State Registration No. or Agency

Certified Cor. Record Prepared? Yes No Filed At: _____ Date _____

REMARKS

Index File No. N-9 T. 55 R. 33E M. W Tract or Surv. No. _____ Cor. Sec Cor