

USDA-FOREST SERVICE

Index

File No. R-15

T 5S R. 33E

Merid. W11

CORNER RECORD (SEARCH)

(Ref. FSM 7151.4)

R.D. Ukiab County \_\_\_\_\_

N.F. Umatilla State Ore.

Tract or Survey No. \_\_\_\_\_ Cor. No. \_\_\_\_\_

CORNER DIAGRAM

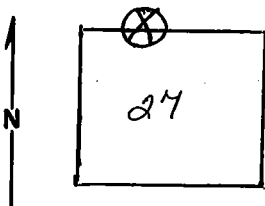

DESCRIBE CORNER MONUMENT FOUND

Stone, Approximately call size.  $\frac{1}{4}$  marked on North face. Sets in small stone mound at North edge of flat creek bottom. Corner stone is painted red. There is a steel post with 2 attention posters approximately 2 feet southwest of stone.

DESCRIBE BEARING TREES OR OTHER OFFICIAL ACCESSORIES FOUND

26" Western Larch bears S12° E, approximately 50 feet. It has closed blaze. It has attention poster and B.T. Tag and red painted ring and closed scar is painted red.

No evidence of N.E. B.T.

DESCRIBE CORNER LOCATION RELATIVE TO NEAR-BY FEATURES, ALSO HOW TO REACH CORNER

Corner is approximately 150. feet south of road.

PHOTO IDENTIFICATION DATA

Photo No. \_\_\_\_\_

Filed At. \_\_\_\_\_

Object Ident. \_\_\_\_\_

Ident. By \_\_\_\_\_

Signature \_\_\_\_\_

PLANE COORDINATE POSITION DATA

State \_\_\_\_\_ Zone \_\_\_\_\_

X \_\_\_\_\_

Y \_\_\_\_\_

Estab. By \_\_\_\_\_

Agency \_\_\_\_\_

Signature T. Hollamon

Title \_\_\_\_\_

Division \_\_\_\_\_

Headquarters \_\_\_\_\_

Date \_\_\_\_\_

11/79

7100-52-(3/68)

**CORNER RECORD (PERPETUATION)**

**MONUMENT: DESCRIBE NEW MONUMENT SET, OR WORK DONE TO PRESERVE EXISTING MONUMENT**

**ACCESSORIES : DESCRIBE NEW BY'S WITNESS OBJECTS ETC. ESTABLISHED, OR WORK DONE TO PRESERVE EXISTING EVIDENCE**

I placed a location poster on an 18" Ponderosa Pine approximately 20 feet North of road (170 feet North of corner).

Signs, post, and painting established by Mel Christian & Gary Collier, 6/77.

Work Done By \_\_\_\_\_ Title \_\_\_\_\_ Date \_\_\_\_\_ State Registration No. or Agency \_\_\_\_\_  
Certified Cor. Record Prepared ? Yes No Filed At: \_\_\_\_\_ Date \_\_\_\_\_

**REMARKS**

Index File No. T. R. M. Tract or Surv. No. Cor. U.S. G.P.O. 1977-725-576/586