

USDA-FOREST SERVICE

Index
File No. G-21

CORNER RECORD (SEARCH)

(Ref. FSM 7151.4)

Tract or
Survey No. _____ No. G-21

T 5S R. 33½E

R.D. Ukiah County Umatilla

Merid. Willamette

N.F. Umatilla State Oregon

CORNER DIAGRAM

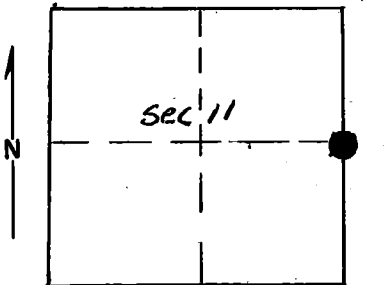

DESCRIBE CORNER MONUMENT FOUND

None

DESCRIBE BEARING TREES OR OTHER OFFICIAL ACCESSORIES FOUND

None

PHOTO IDENTIFICATION DATA

Photo No. _____

Filed At. _____

Object Ident. _____

Ident. By _____

Signature _____

PLANE COORDINATE POSITION DATA

State _____ Zone _____

X _____

Y _____

Estab. By _____

Agency _____

DESCRIBE CORNER LOCATION RELATIVE TO NEAR-BY FEATURES, ALSO HOW TO REACH CORNER

From intersection of Road S552 and S 534, which is West 800 feet from Frazier Guard Station, go South on Road S534 0.1 mile to old jeep road up Frazier Creek. Go about 1.4 miles on road. The corner is South 3 chains about 100 feet in elevation lower than road.

Signature

Terry C. Hamby

Title

Division

O.P.L.S.

Headquarters

1638

Date

8/78

7100-52-(3/68)

5

CORNER RECORD (PERPETUATION)

MONUMENT: DESCRIBE NEW MONUMENT SET, OR WORK DONE TO PRESERVE EXISTING MONUMENT

T 5S R 33½E

Set 2½" x 30" iron pipe with brass cap.

¼

Pipe is 24" in ground.

Stamped:

S 11 | S 12

1978

PLS 933

9

ACCESSORIES : DESCRIBE NEW BT's WITNESS OBJECTS ETC. ESTABLISHED, OR WORK DONE TO PRESERVE EXISTING EVIDENCE

Tamarack 16" diameter bears North 30°59' West 14.00 feet with signs 54-3 and 54-4.
Pine 32" diameter bears South 38°53' East 36.0 feet with signs 54-3 and 54-4.

Set steel post East 5 feet with signs 54-4.
Painted red band around trees.

10

Work Done By T. Hamby Title Surveyor Date 7/25/78 State Registration No. O.P.L.S. 1638
or Agency

Certified Cor. Record Prepared? Yes No Filed At: Umatilla County Surveyor Date B-B-78

11

REMARKS

Witness by Richard Barton and William Hampton.

12

Index File No. T. R. M. Tract or Surv. No. Cor. 13