

Index

File No. N-5

CORNER RECORD (SEARCH)

(Ref. FSM 7151.4)

Tract or

Survey No. _____

Cor.

No. _____

T 5 S R. 34 SR.D. La GrandeCounty UnionMerid. WillametteN.F. Wallowa-WhitmanState Oregon

CORNER DIAGRAM

T 5 S R 34 E

S 18 | S 17

S 19 | S 20

1993

PLS 1106

PHOTO IDENTIFICATION DATA

Photo No. _____

Filed At. _____

Object Ident. _____

Ident. By _____

Signature

PLANE COORDINATE POSITION DATA

State _____ Zone _____

X _____

Y _____

Estab. By _____

Agency

DESCRIBE CORNER MONUMENT FOUND

No trace of corner post in area of previous heavy logging.

DESCRIBE BEARING TREES OR OTHER OFFICIAL ACCESSORIES FOUND

A 16" western larch stump bears N12°E, 20 lks (13.2') with blaze and axe marks visible... scribing burnt out.
A stump hole bears S35°E, 9 lks (5.9') with pieces of rotted blaze alongside.

DESCRIBE CORNER LOCATION RELATIVE TO NEAR-BY FEATURES, ALSO HOW TO REACH CORNER

Corner is approx. 125' - 150' West of Road 5160-340.
Corner is visible from cut bank West of Road.

Signature

Will R. Walls

Title

Land Surveyor

Division

Headquarters

Pendleton, OR.

Date

10-26-93

FS-7100-52 (3/68)

CORNER RECORD (PERPETUATION)

MONUMENT: DESCRIBE NEW MONUMENT SET, OR WORK DONE TO PRESERVE EXISTING MONUMENT

At position established by record bearing and distance from recovered remnants of Section 17 bearing tree...
 Set a 2½" aluminum cap on 2½"x30" aluminum pipe 27" in ground surrounded with mound of earth and stone. Set a fence post next to corner and attached sign 54-9 and 54-2. Compass declination 18° East.

9

ACCESSORIES: DESCRIBE NEW BT'S, WITNESS OBJECTS ETC. ESTABLISHED, OR WORK DONE TO PRESERVE EXISTING EVIDENCE

New bearing trees established:
 A 7½" diam. western larch brs. N12°E, 98.3' scribed T5SR34ES17 BT.
 A 9" diam. alpine fir brs S30°E, 51.8' scribed T5SR34ES20 BT.
 A 13½" diam. alpine fir brs S33°W, 76.4' scribed T5SR34ES19 BT.
 A 7" diam. alpine fir brs N68°W, 88.3' scribed T5SR34ES18 BT.
 New bearing trees have a brass washer stamped PLS 1106 nailed to face of blaze. Attached sign 54-3 & 54-9, painted face of blaze &

10

Work Done By. W.R. Wells Title Land Surveyor Date 10-26-93 State Registration No. PLS 1106
 or Agency

Certified Cor. Record Prepared? Yes XXXX Filed At Unatilla County Surveyor Date 8/94

11

REMARKS

a 6" red band around each BT.

12

Index File No. N-5 5 S R. 34 E W. M. Tract or Surv. No. Cor.

13

USDA-FOREST SERVICE

Index File No. N-5

CORNER RECORD (SEARCH)

(Ref. FSM 7151.4)

Tract or Survey No. _____

Cor. No. 18, 17
19, 20

T 55 R. 34E

R.D. LA GRANDE

County UMATELLA

Merid. WILL.

N.F. W-W

State ORE.

CORNER DIAGRAM

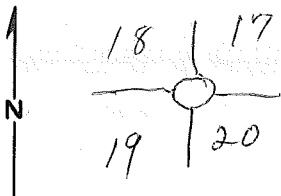

DESCRIBE CORNER MONUMENT FOUND

None

DESCRIBE BEARING TREES OR OTHER OFFICIAL ACCESSORIES FOUND

None. Heavy logging over the past 10 yrs, and road-constr. may have gone through location. Lots of w.l. stumps in area all are about 12" or less tall.

PHOTO IDENTIFICATION DATA

Photo No. _____

Filed At. _____

Object Ident. _____

Ident. By _____

Signature

PLANE COORDINATE POSITION DATA

State _____ Zone _____

X _____

Y _____

Estab. By _____

Agency

Signature *Dave Dableton*

Title *CET*

Division *La Grande* Headquarters _____

Date *8-28-84*

FS-7100-52 (3/68)

CORNER RECORD (PERPETUATION)

MONUMENT : DESCRIBE NEW MONUMENT SET, OR WORK DONE TO PRESERVE EXISTING MONUMENT

9

ACCESSORIES : DESCRIBE NEW BT'S WITNESS OBJECTS ETC. ESTABLISHED, OR WORK DONE TO PRESERVE EXISTING EVIDENCE

10

Work Done By _____ Title _____ Date _____ State Registration No. or Agency _____

Certified Cor. Record Prepared ? Yes No Filed At: _____ Date _____

11

REMARKS

12

Index File No. T. R. M. Tract or Surv. No. Cor. _____

13