

USDA-FOREST SERVICE

Index  
File No. R-13

CORNER RECORD (SEARCH)

(Ref. FSM 7151.4)

Tract or  
Survey No. \_\_\_\_\_ Cor.  
No. Sec. Cor.

T 5 S R. 34 E

R.D. LaGrande County Union

Merid. Willamette

N.F. WW-16 State Oregon

CORNER DIAGRAM

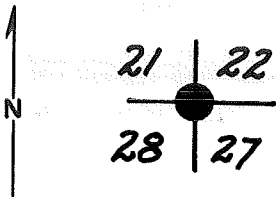

DESCRIBE CORNER MONUMENT FOUND

4 x 4 wood post leaning against a tree w/visible scribing on two sides.

DESCRIBE BEARING TREES OR OTHER OFFICIAL ACCESSORIES FOUND

13" tamarack bears N 59 E, 8 lks. w/blaze healed over  
16" tamarack bears N 43 W, 48 lks. w/blaze healed ov  
16" tamarack bears S 50 W, 9 lks. w/blaze healed over  
12" fir bears S 54 E, 16 lks. w/blaze partly healed  
w/scrolling still visible.

All old BT's and alive and in good condition.

DESCRIBE CORNER LOCATION RELATIVE TO NEAR-BY FEATURES, ALSO HOW TO REACH CORNER

Approx. 550 ft. S of Squaw Cr.

PHOTO IDENTIFICATION DATA

Photo No. \_\_\_\_\_  
Filed At. \_\_\_\_\_  
Object Ident. \_\_\_\_\_  
Ident. By \_\_\_\_\_

*Signature*

PLANE COORDINATE POSITION DATA

State \_\_\_\_\_ Zone \_\_\_\_\_  
X \_\_\_\_\_  
Y \_\_\_\_\_  
Estab. By \_\_\_\_\_

*Agency*

Signature  
**H ambleton**

Title

Division  
**ORLS**

Headquarters  
**645**

Date  
**8-78**

7100-52-(3/68)

## CORNER RECORD (PERPETUATION)

MONUMENT: DESCRIBE NEW MONUMENT SET, OR WORK DONE TO PRESERVE EXISTING MONUMENT

Set a  $2\frac{1}{2}$ " x 30" iron pipe w/brass cap mid:  
Set 24" in ground; no stone available.

T 5 S  
S 21 | S 22  
S 28 | S 27  
R 34 E  
1978  
ORLS 645

9

ACCESSORIES : DESCRIBE NEW BT'S WITNESS OBJECTS ETC. ESTABLISHED, OR WORK DONE TO PRESERVE EXISTING EVIDENCE

Painted blaze and band of BT's red & yellow. Tagged trees w/54-3&4 signs.  
Set steel fence post by mound of stone w/signs 54-5&6.

10

Work Done By J. Hambleton Title Surveyor Date 8-78 State Registration No. ORLS 645  
or Agency \_\_\_\_\_  
Certified Cor. Record Prepared? Yes  No \_\_\_\_\_ Filed At: Union CS Date \_\_\_\_\_

11

## REMARKS

Witnesses: L. Green  
L. Shirley

12

Index File No. T. R. M. Tract or Surv. No. Cor. 13