

**OREGON CORNER RESTORATION FORM**

Section 31 Township 6N Range 35E  
 County Umatilla Date: November 21, 2002

Corner Designation: 6N34Z1

Corner to section 36, T6N, R33E, section 31, T6N, R34E, section 1, T5N, R33E, and section 6, T5N, R34E, W.M., Umatilla County, Oregon.

Condition Report Only  
 Not found  
 Remonumented  
 Unrecorded  
 Surveyed in  
 Referenced out

State Plane Coordinates, Oregon North, 83(1991)  
 N = 836560.86 E = 8679963.52

Previous Renewals / Surveys, etc.

Corner originally set by Deputy Surveyors Odell & Lewis under contract No. 110 dated February 7th, 1865. Their record reads: Set post Cor., for Tps. 5 & 6 N, Rs. 33 & 34 E. & Secs. 1, 6, 31 & 36. Drove Charred stake; dug pits & raised mound, as per instructions. John Kimbrell set a stone stone 20 x 10 x 8 inches" by three way proportioning from the west, east and north.

Monument and Accessories found: ( condition and source )

The stone set by Kimbrell, firmly in place in a mound of stone and visibly notched with 6 notches on the north, east, and west edges.

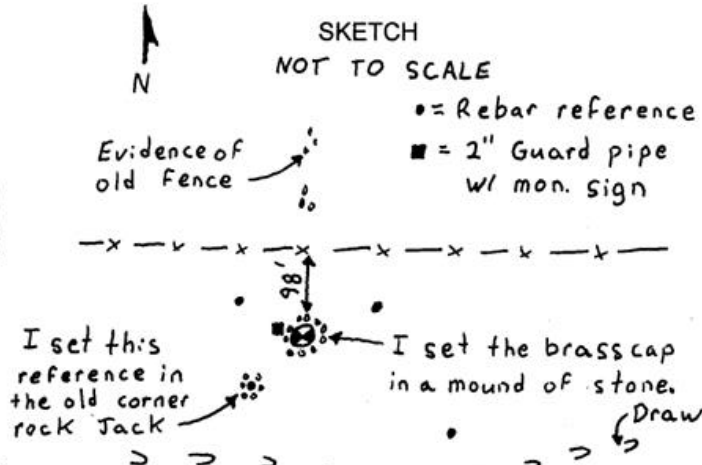
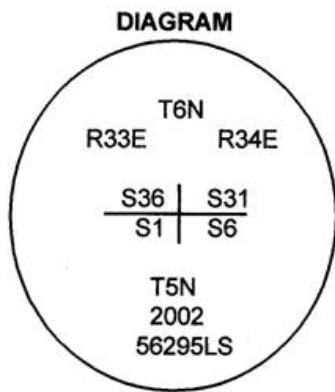

**Monument and Accessories set:**

Set a 2 1/4" brass cap on a 30" galvanized iron pipe stamped as shown in the diagram above at the position of Kimbrell's stone. I buried the stone along the east side and placed a 30" collar of stone around the cap. I set a 2" x 48" iron pipe with a county monument sign attached along side.

For references, I set four 5/8" x 24" green coated iron rebars with orange plastic caps stamped WTS and 56295LS as described below.

- an iron rebar bears N54°17'51"W, 30.04';
- an iron rebar bears N23°22'01"E, 31.05';
- an iron rebar bears S15°34'13"W, 19.82' in an old fence corner rock jack;
- an iron rebar bears S70°40'26"E, 63.97';

The monument and references were tied using a LIECA system 300 RTK GPS.

Location and comments  
 Kimbrell's stone was witnessed in place by PLS 852, David L. Haddock

Compass Declination

Surveyors Seal

RECEIVED BY:  
Umatilla County Surveyor  
 Date: 2-25  
 Rec'd By: KK  
 No. 03-21-0

Firm / Agency  
 Witness Tree Surveying  
 Address  
 P.O. Box G  
 Pilot Rock, Or. 97868  
 Party Chief  
 Stephen K, Haddock

REGISTERED PROFESSIONAL LAND SURVEYOR

*Stephen K. Haddock*

OREGON  
 JULY 9, 2001  
 STEPHEN K. HADDOCK  
 56295LS

RENEWAL DATE 6-30-03