

OREGON CORNER RESTORATION FORM

Section: 29, 30, 31, 32
Township: 6 North
Range: 35 East of the Willamette Meridian
County: Umatilla
Date: June 1, 2002

Corner Indexing Information: Township 6N Range 35E Corner Code V 5 (Willamette Meridian)

Additional Identifier: (e.g. BLM designation for the corner, street intersection, plat name, block, lot, etc.)

This corner is common to sections 29, 30, 31, 32.

Oregon Plane Coordinates: N: 843300.192 E: 8716814.231

Zone: North Order: second Datum: NAD83-91 Convergence: 1°26'07.7" Scale Factor: .99995259

Previous Renewals/Surveys, etc.: Originally surveyed by U.S. Deputy Surveyor William Odell under his contract No. 110, dated 8-23-1875. The Surveyor General's notes state, "set post corner for sections 29,30,31, and 32. Drove a charred stake, dug pits and raised mounds as per instructions. County Survey No. 35, Book 1, Page 188, dated October 15, 1888, Arnold found a stone set by land owner William Weaver, circa 1884, over the remains of the original charred stake. In 1973, Streamer found a 1/2" steel pin of unknown origin as shown on survey No. I-089-AX.

Monument(s) & Accessories Found (Condition & Source):

At the southwest corner of section 29, T6N R35E, we found 1/2" rebar 1" below the surface pavement.

Monument Set (Procedures & Description):

Drove 1/2" iron rebar to 3" depth. Drove 1 1/2" x 15 1/2" galvanized iron pipe around rebar placed 10" of concrete around the pipe. Then filled the pipe with concrete and set 2" brass disc on the top of the pipe at surface pavement stamped (see example below)
T6N R35E
LS 2360
S30 S29
S31 S32
2001

Monument Detail:

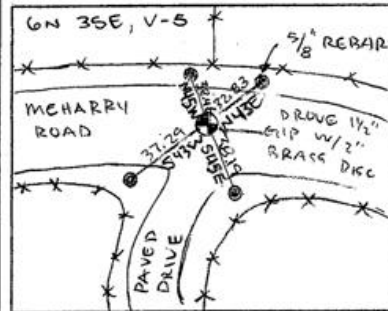

New Accessories: WE SET:

A 5/8 rebar with yellow plastic cap stamped 'Tomkins Surveying' which bears N 43° E ~ 32.83 from the corner. Attached a Umatilla County Bearing object to the southwest face of power pole. A 5/8 rebar with yellow plastic cap stamped 'Tomkins Surveying' which bears S 45° E ~ 38.19 feet from the corner. Attached a Umatilla County Bearing object to the northwest face of round wood fence post. A 5/8 rebar with yellow plastic cap stamped 'Tomkins Surveying' which bears S 43° W ~ 37.29 feet from the corner. Attached a Umatilla County Bearing object to a t-post. A 5/8 rebar with yellow plastic cap stamped 'Tomkins Surveying' which bears N 45° W ~ 38.46 feet from the corner. Attached a Umatilla County Bearing object to t-post.

Location & Comments:

Compass Declination:

19° East

Firm/Agency: Tomkins Land Surveying, Inc.
20 E. Poplar, Suite 204
Walla Walla, WA 99362

Party Chief: Bryan Martin
Notes: Bryan Martin
Witness: Eric Flowers

Surveyor's Seal

REGISTERED
PROFESSIONAL
LAND SURVEYOR

Handwritten signature of Paul W. P. Tomkins

OREGON
JULY 26, 1988
PAUL W. P. TOMKINS
2360

renews 6/30/04
6/30/02