

OREGON CORNER RESTORATION FORM

Section 35 Township 6 N Range 35E
 County Umatilla Date: Jan. 2001

Corner Designation: 6n35w18

Previous Renewals / Surveys, etc.

This corner was established by Aubrey Perry under survey 427 in 1919.

Condition Report Only
 Not found
 Remonumented
 Unrecorded
 Surveyed in
 Referenced out

Monument and Accessories found: (condition and source)

I found a 1" iron bar 18" below the pavement surface on the centerline of Locust Road as called for by Perry in Survey 427. This monument agrees closely with older development in the area.

DIAGRAM

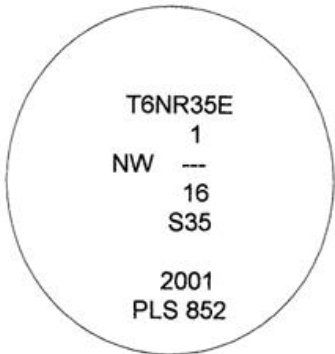

SKETCH

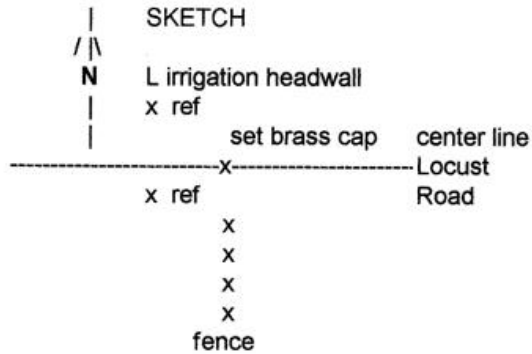

MONUMENT (S) AND ACCESSORIES SET (Procedures and Description)

I set a 1 1/4" x 30" GIP with a 2 1/2" brass cap directly over Perry's found iron bar. The surface of the brass cap is at the top of the asphalt surface.

REFERENCES SET:

I set two 5/8"x 24" iron rebars with red plastic caps stamped ORLS 852 and WALS 13922 as follows: N35°08'44"W, 22.39' and S43°56'00"W, 31.29'.

Location and comments

Compass Declination

Surveyors Seal

RECEIVED BY:

Date: 2-02
 Rec'd By: KK
 No. 02-18-B

Firm / Agency

David L. Haddock, PLS 852
 Haddock Surveying
 P. O. Box 1574
 Pendleton, OR 97801.

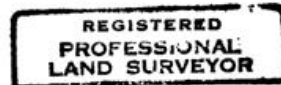

David L. Haddock

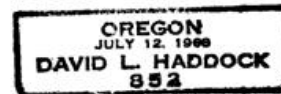

RENEWS 6-30-03