

OREGON CORNER RESTORATION FORM

Section: 32 & 33
Township: 6 North
Range: 35 East of the Willamette Meridian
County: Umatilla
Date: June 28, 2002

Corner Indexing Information: Township 6N Range 35E Corner Code X 9 (Willamette Meridian)

Additional Identifier: (e.g. BLM designation for the corner, street intersection, plat name, block, lot, etc.)

This quarter corner is common to sections 32 & 33.

Oregon Plane Coordinates: N: 840746.308 E: 8722167.516

Zone: North Order: second Datum: NAD83-91 Convergence: 1°27'00.8" Scale Factor: .99994789

Previous Renewals/Surveys, etc: Originally surveyed by U.S. Deputy Surveyor William Odell under his contract No. 110, dated 8-23-1865. The Surveyor Generals notes state, "set quarter section post corner, drove charred stake, dug pits, and raised mounds as per instructions." Survey No. 280-A, Book 2, Page 107, dated March 16, 1909, Kimbrell set a stake for quarter section point. Survey No. I-89-AX, dated April 25, 1973, Streamer found a 1/2" pin, no previous record for this found pin was discovered.

Monument(s) & Accessories Found (Condition & Source):

At the west quarter corner of section 33, T6N R35E, we found 1/2" rebar 2' below the surface gravel.

Monument Set (Procedures & Description):

Monument Detail:

Set 1" x 30" flared end galvanized iron pipe with 2 1/2" brass cap 5" below the surface gravel stamped (see example below)
T6N R35E
LS 2360
S32 S33
1/4
2001

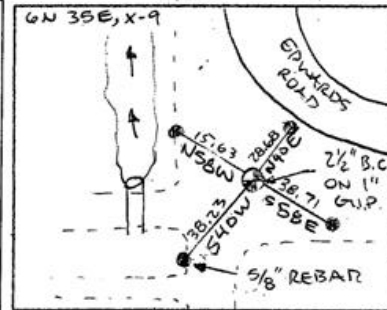

New Accessories: WE SET:

A 5/8 rebar with yellow plastic cap stamped 'Tomkins Surveying' which bears N 40°E ~ 28.68 from the corner. No Umatilla County Bearing object sign or t-post set. A 5/8 rebar with yellow plastic cap stamped 'Tomkins Surveying' which bears S 58°E ~ 38.71 feet from the corner. Attached a Umatilla County Bearing object sign to the west face of telephone junction box at the bottom. A 5/8 rebar with yellow plastic cap stamped 'Tomkins Surveying' which bears S 40°W ~ 38.23 feet from the corner. Attached a Umatilla County Bearing object sign to the northeast face of light pole. A 5/8 rebar with yellow plastic cap stamped 'Tomkins Surveying' which bears N 58°W ~ 15.63 feet from the corner. Attached a Umatilla County Bearing object sign to t-post.

Location & Comments:

Compass Declination:

19° East

Surveyor's Seal

Firm/Agency: Tomkins Land Surveying, Inc.
20 E. Poplar, Suite 204
Walla Walla, WA 99362

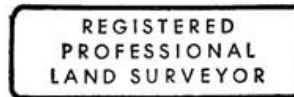

Handwritten signature of Paul W. Tomkins.

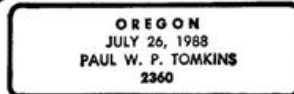

Party Chief: Bryan Martin
Notes: Bryan Martin
Witness: Eric Flowers

Handwritten notes: renew 6/30/09, 6/30/02