

OREGON CORNER RESTORATION FORM

Section 34 Township 6 N Range 35E
 County Umatilla Date: Jan. 2001

Corner Designation: **6n35z17**

____ Condition Report Only
 ____ Not found
 Remonumented
 ____ Unrecorded
 ____ Surveyed in
 Referenced out

Previous Renewals / Surveys, etc.

This corner was established by Odell and Lewis under Contract 110 dated Feb. 7, 1865. The corner was monumented with posts and pits.

In or before 1879, the Oregon-Washington Railroad & Navigation Co. tied it from station 578+66 at an angle right of 66°54' at 1549.7 feet and also from station 577+00 at an angle right of 61°28' at 1618 feet. My copy of this survey is dated 1916.

In 1974 under survey I-198-A, Harris set a 1/2" pin.

In 1981 under survey S-157-C, Krumbein set a brass cap at the position of the 1/2" pin.

Monument and Accessories found: (condition and source)

Found Krumbeins brass cap 1" below the road surface in good condition.

DIAGRAM

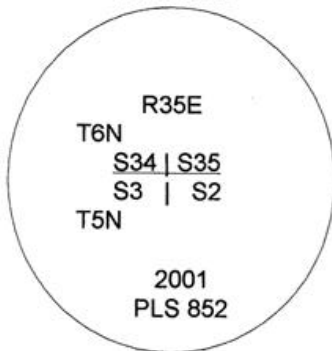

SKETCH

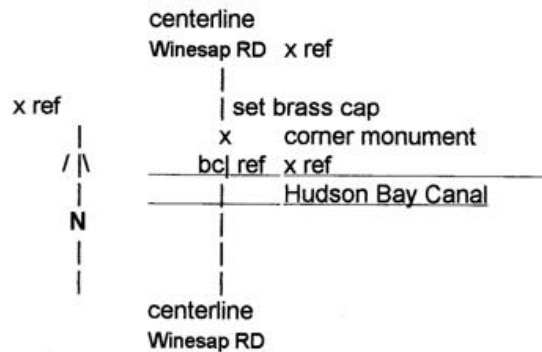

MONUMENT (S) AND ACCESSORIES SET (Procedures and Description)

At a point based on the railroad's record distance north from the tracks and at the approximate centerline of the county road, I set a 1 1/4" x 30" galvanized iron pipe with a 2 1/2" brass cap stamped as shown in the diagram above. The top of the cap is 1/4" below the paved surface.

REFERENCES SET:

The previous corner monument, a 2 1/2" brass cap by PLS 933 bears S2°34'25"E, 14.71'. 5/8" x 24" rebars with 1.3" red plastic caps stamped ORLS 852 and WALS 13922 were set & bear: N80°16'24"W, 35.57'; N16°28'48"E, 54.75'; S58°25'00"E, 25.45'.

Location and comments

Compass Declination

Surveyors Seal

RECEIVED BY:

Date: 2-02
 Rec'd By: KK
 No. 02-18-B

Firm / Agency

David L. Haddock, PLS 852
 Haddock Surveying
 P. O. Box 1574
 Pendleton, OR 97801.

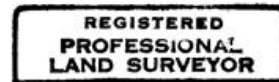

David L. Haddock

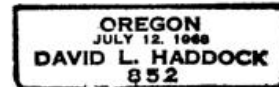

RENEWS 6-30-03