

OREGON CORNER RESTORATION FORM

COUNTY: Umatilla. DATE: 07/31/08

CORNER DESIGNATION: N-19, The North One-Quarter Corner Section 23, Township 6 North, Range 36 East, W.M..

PREVIOUS RENEWALS/SURVEYS ETC: Corner originally set by Odell & Lewis under GLO Contract No. 110, dated February 7, 1865. Notes state: Set 1/4 Sec. post. Drove charred stake; dug pits & raised mound, as per instructions.

MONUMENT AND ACCESSORIES FOUND: None. Corner falls in farmed field with no features nearby.

MONUMENT MARKING DETAIL:

T6N R36E
1 S14
4 S23
2008
PLS 1106

MONUMENT SET: Reestablished corner position by single proportion measure between the recovered Northwest Corner and reestablished Northeast Corner of Section 23. At the reestablished corner point, set a 2 3/8" brass cap on a 1 1/4" x 24" galvanized iron pipe, with cap buried 24" below ground level and marked as shown in "Monument Marking Detail".

New accessories:

- A silver deep-1 magnet bears North 37° East, 33.7 feet.
 - A purple deep-1 magnet bears South 61° East, 30.5 feet.
 - A blue deep-1 magnet bears South 22° West, 37.3 feet.
 - An orange deep-1 magnet bears North 62° West, 39.0 feet.
- All magnets are buried 20" below ground level with bearing object signs.

LOCATION AND COMMENTS: Corner falls in farmed, fallow field, no features.

OREGON STATE PLANE COORDINATE, North Zone, NAD 83(91), International Feet:

N = 855264.59
E = 8766878.60

FIRM: Wells Surveying
P.O. Box 1696
Pendleton, OR 97801

COMPASS DECLINATION: 18° East

Surveyor's Seal

Witnesses: Jason Wells, LSIT

\6N36N19

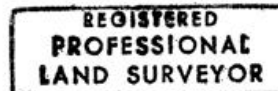

William R. Wells

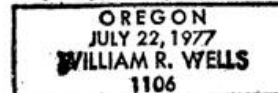

renews 6-30-10

09-10-0