

OREGON CORNER RESTORATION FORM

Section 27 Township 6N Range 36E  
County UMATILLA Date 7/1/03

CORNER DESIGNATION

R-17 (NORTHEAST CORNER)

- Condition Report Only
- Not Found
- Renewed
- Unrecorded
- X Surveyed In
- X Referenced Out

Previous Renewals/Surveys, etc.:

Odell and Lewis, under Contract No. 110, dated February 7, 1865, drove charred stake, dug pits, and raised mound.

Monument (s) & Accessories Found: (Condition and Source)

None

Sketch  
(Not to Scale; Bearings and Distances are NAD '83 ('91) grid)

Monument Detail

Monument is a railroad spike stamped "LS2627" with punch mark set flush with asphalt road surface.

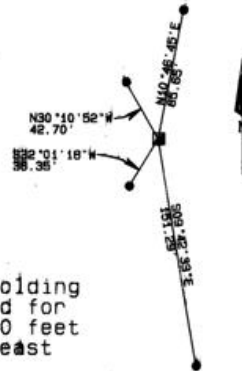

Monument Set (Procedures and Description):

Set the spike at the location determined by holding the center of the asphalt surface of Hood Road for easting and the record G.L.O. distance of 5280 feet from the Tomkins brass cap found at the Northeast Corner of Section 22 for northing.

New Accessories:

- A 5/8" X 30" iron rebar with yellow plastic cap marked "UCPWD...LS2627" bears N30°10'52"W, 42.70' (A wood fence post with bearing object tag bears west 1' +/- from pin).
- A 5/8" X 30" iron rebar with yellow plastic cap marked "UCPWD...LS2627" bears S32°01'18"W, 36.35' (A wood fence post with bearing object tag bears west 1' +/- from pin).
- A 5/8" X 30" iron rebar with yellow plastic cap marked "UCPWD...LS2627" bears S09°42'33"E, 151.29' (bearing object tag is attached to pin).
- A 5/8" X 30" iron rebar with yellow plastic cap marked "UCPWD...LS2627" bears N10°48'45"E, 85.65' (bearing object tag is attached to pin).

Location and Comments: Compass Declination: N/A

From the intersection of Birch Creek Road and Hood Road, travel north on Hood Road for approximately 1/4 mile to the top of a hill. The monument is located just west of the painted yellow stripe as it exists this date.

Firm/Agency :  
Umatilla County  
Road Department  
Address:  
3920 Westgate  
Pendleton, Oregon 97801  
Party Chief:  
Gary Roberts  
Notes:  
Gary Roberts  
Witness:  
None

Surveyor's Seal

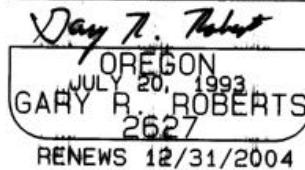
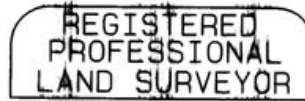

Oregon State Plane Coordinates  
NAD '83 ('91) - International Feet

Northing: 849,919.78

Easting: 8,764,356.96

03-105-C