

**OREGON CORNER RESTORATION FORM**

COUNTY: Umatilla. DATE: 04/04/08

CORNER DESIGNATION: R-19, The South One-Quarter Corner of Section 23, Township 6 North, Range 36 East, W.M..

PREVIOUS RENEWALS/SURVEYS ETC.: Corner originally established by Odell & Lewis under GLO Contract No. 110, dated February 7, 1865. Notes state: Set 1/4 Sec. post. Drove charred stake; dug pits & raised mound, as per instructions.

MONUMENT AND ACCESSORIES FOUND: None.

MONUMENT MARKING DETAIL:

T6N R36E  
1 S23  
4 S26  
2008  
PLS 1106

MONUMENT SET: Held field intersection with field berms East and West and field line North. There is a white metal well casing, about 6 feet above ground just North of the corner monument. Set a 2 3/8" brass cap on 1 1/4" x 30" galvanized iron pipe, with cap set flush with the ground, marked as shown in "Monument Marking Detail".

New accessories:

- A silver deep-1 magnet bears North 55° East, 27.5 feet.
  - A purple deep-1 magnet bears South 43° East, 37.1 feet.
  - A blue deep-1 magnet bears South 50° West, 34.7 feet.
  - An orange deep-1 magnet bears North 42° West, 25.9 feet.
- All deep-1 magnets are buried 20 inches below ground level with bearing object signs.

LOCATION AND COMMENTS: Corner is in East-West field berm intersection with field line North. Corner is 1 foot South of 6 inch well casing that is 6 feet above ground level. There is a witness sign attached to the well casing.

OREGON STATE PLANE COORDINATE, North Zone, NAD 83(91), International Feet:

N = 849968.09  
E = 8767013.93

FIRM: Wells Surveying  
P.O. Box 1696  
Pendleton, OR 97801

COMPASS DECLINATION: 18° East

Surveyor's Seal

Witnesses: Jason Wells, LSIT

16N36R19

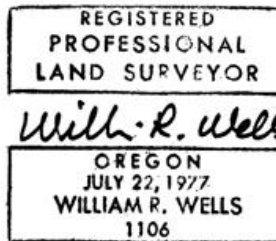

*Expires 6-30-10*

*09-10-C*