

OREGON CORNER RESTORATION FORM

COUNTY: Umatilla DATE: 07/25/08

CORNER DESIGNATION: V-21, The Northwest Corner of Section 36, Township 6 North, Range 36 East, W.M..

PREVIOUS RENEWALS/SURVEYS ETC: Corner originally set by Odell & Lewis under GLO Contract No. 110, dated February 7, 1865. Notes state: Set post Cor. for Secs. 25, 26, 35 & 36. Drove charred stake; dug pits & raised mound, as per instructions.

MONUMENT AND ACCESSORIES FOUND: None. There is an old E-W fence line in the corner area.

MONUMENT MARKING DETAIL:

T6N R36E
S26|S25
S35|S36
2008
PLS 1106

MONUMENT SET: Reestablished corner position holding the old East-West fence line for latitude. For departure, I proportioned against the Odell and Lewis record, between the reestablished South One-Quarter Corners of Sections 35 and 36. At the reestablished corner point, set a 2 3/8" brass cap on a 1 1/4 x 30" galvanized iron pipe, with cap flush with ground level and marked as shown in "Monument Marking Detail". Placed two stones just East of the corner monument.

New accessories:

A 5/8" x 24" rebar with a red plastic cap marked "OR PLS 1106, WA PLS 17372", in newer fence line, bears North 90° East, 29.3 feet.

A 5/8" x 24" rebar with a red plastic cap marked "OR PLS 1106, WA PLS 17372", in newer fence line, bears South 87° East, 56.0 feet.

A 5/8" x 24" rebar with a red plastic cap marked "OR PLS1106, WA PLS 17372", at South edge of wheat field, on a sloping bank, bears North 41° East, 39.9 feet.

A 5/8" x 24" rebar with a red plastic cap marked "OR PLS 1106, WA PLS 17372", at edge of wheat field, on a sloping bank, bears North 03° West, 54.6 feet.

Wired witness sign to metal fence post about 15' East of corner.

Attached bearing object signs to the rebar accessories.

LOCATION AND COMMENTS: Corner falls in old East-West fence 100 feet, +- East of Birch Creek. There are two fences, the old one is North. A newer fence, with metal posts, is about 3 feet South of the old fence. The older fence to the North was held for latitude for the corner.

OREGON STATE PLANE COORDINATE, North Zone, NAD 83(91), International Feet:

N = 844703.03
E = 8769918.62

FIRM: Wells Surveying
P.O. Box 1696
Pendleton, OR 97801

COMPASS DECLINATION: 18° East

Surveyor's Seal

Witnesses: Jason Wells, LSIT

V6N36V21

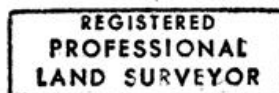

William R. Wells

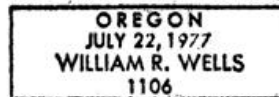

Renews 6-30-10

09-10-C