

OREGON CORNER RESTORATION FORM

Section 33 Township 6N Range 36E
 County Umatilla Date: November 27, 2007

Corner Designation: 6N36V9

Corner to sections 28, 29, 32, and 33, T6N, R36E,
 W.M., Umatilla County, Oregon.

Previous Renewals / Surveys, etc.

Corner originally set by Odell and Lewis under contract No. 110 dated February 7, 1865. Their record reads: Set post Cor. for Secs. 28, 29, 32 & 33. Drove charred stake, dug pits & raised mound as per instructions.

Monument and Accessories found: (condition and source)
 None. The point falls in a farmed over plow berm.

Condition Report Only
 Not found
 Remonumented
 Unrecorded
 Surveyed in
 Referenced out

DIAGRAM

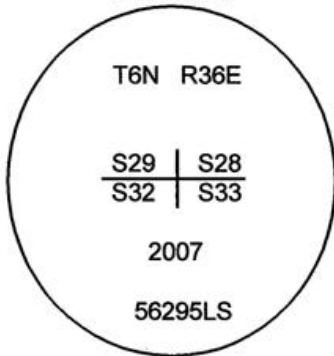

SKETCH

MONUMENT (S) AND ACCESSORIES SET (Procedures and Description)

I set a 1 1/2" x 30" galvanized iron pipe with a 2 1/4" brass cap stamped as shown in the diagram above by proportioning the departure and holding the plow berm for latitude.

For references, I set four, 5/8" by 24" rebars with 1 1/8" orange plastic caps attached, stamped WTS and 56295LS as described below:

- an iron rebar bears N53°20'25"W, 20.41 feet ;
- an iron rebar bears N43°47'05"E, 17.73 feet;
- an iron rebar bears S45°46'24"W, 23.34 feet;
- an iron rebar bears S46°09'20"E, 19.81 feet;

The monument and references are 2' below the surface of the plowed field.

The monument was set and references were tied using a Trimble R7/R8 RTK GPS.

Location and comments

Compass Declination

Surveyors Seal

RECEIVED BY:
Umatilla County Surveyor
 Date: 02-08
 Rec'd By: JK
 No. 08-039-C

Firm / Agency
 Witness Tree Surveying
 Address
 P.O. Box G
 Pilot Rock, Or. 97868
 Party Chief
 Stephen K, Haddock

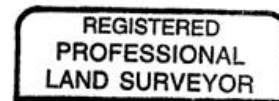

Stephen K. Haddock

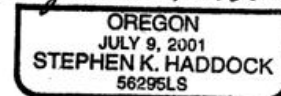

RENEWAL DATE 6-30-09