

A 22 inch diameter fir with a healed blaze and bearing tree tag bears S81¼°E 19.8 Feet.
An 18 inch diameter fir with a healed blaze and bearing tree tag bears S69°W 28.4 Feet.

No evidence of the other two 1965 bearing trees remain.

MOUNUMENT MARKING DETAIL:



MOUNUMENT AND ACCESSORIES SET:

A 12 inch diameter White fir bears N23°W 17.3 feet marked T6N R37 S23 BT
A 10 inch diameter Douglas fir bears N28°E 26.4 feet marked T6N R37E S24 BT

LOCATION AND COMMENTS:

Bearings taken with Silva hand compass and distances measured with a steel tape.

OREGON STATE PLANE COORDINATE, North Zone, NAD 83(91), International Feet:

N = 851258.15
E = 8801060.43

COMPASS DECLINATION: 15° East

SURVEYORS' SEAL:

FIRM: HDJ Design Group
5 N. Colville, Suite 200
Walla Walla WA 99362

WITNESSES: Thomas J. Boshart
Felipe G. Hernandez

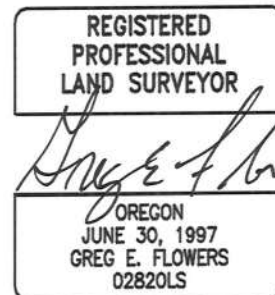

RENEWS 12/31/15

06/29/2015

OREGON CORNER RESTORATION FORM

COUNTY: Umatilla DATE: 06/09/2014

CORNER DESIGNATION: R-21, Section Corner for Sections 23, 24, 25, and 26, Township 6 North, Range 37E, W.M.

PREVIOUS RENEWALS/SURVEYS ETC:

Originally surveyed by George Williams in 1872 his notes state "Set post for corner to Secs 23, 24, 25, & 26, from which:

- A White Fir 8 inch diameter bears S26°E 11 links distance
- A White Fir 6 inch diameter bears S45°W 12 links distance.
- A fir stump 10 inch diameter bears N27°W, 35 links distance.

BLM Cadastral Surveyor C. Alfred White in his April 21, 1965 for Group 572, stated in his notes: "Beginning at the Cor. of secs. 23, 24, 25, and 26, determined at record bearing and distance from the remaining original bearing tree:

- A fir, 36 ins. diam., bears S. 26° E., 11 lks. dist., with scribe marks BT visible on an opened blaze.
- At the corner point
- Set an iron post 28 ins. long, 2½ ins. diam., 24 ins. in the ground with a brass cap marked.

T 6 N R 37 E	
S 23	S 24
S 26	S 25
1965	

From which new bearing trees

- A fir 7 ins. diam., bears N. 25¼° E 47 lks. dist., marked T6N R37E S24 BT.
- A fir 13 ins. diam., bears S. 81¼° E 30 lks. dist., marked T6N R37E S25 BT.
- A fir 12 ins. diam., bears S. 69° W 43 lks. dist., marked T6N R37E S26 BT.
- A fir 7 ins. diam. bears N. 12° W 42 lks. dist., marked T6N R37 ES 23 BT.

Surveyor Paul W.P. Tomkins noted in his February 15, 1996 survey, shown on Umatilla County Survey record of surveys 99-121-B, "North ¼ Corner of Section 26, Corner common to Sections 23, 24, 25 and 26. History: Corner was originally established in 1872, by George Williams, U.S. Deputy Surveyor, under contract No. 176, as a post, from which a White fir, 8" in diam., bears S. 26°E., 11 lks. dist., A White fir, 6" in diam., bears S. 45° W., 12 lks. dist., and a fir stump, 10" in diam., bears N. 27° W., 35 lks. dist. The BLM (Bureau of Land Management) in 1965 restored the 1872 survey by George Williams by setting for the corner a brass cap stamped T 6N, R 37E S23,24, 26 and 25,1965" used the following bearing trees for accessories: A fir, 7" in diam., bears S. 25¼° E., 47 lks. dist., marked T6N R 37E S24 BT., A fir 13" in diam., bears S. 81½° E., 30 lks. dist., marked T6N R37E S25 BT., A fir, 12" in diam., bears S. 69° W., 43 lks. dist., marked T 6N R37E S23 BT., and a fir, 12" in diam. Bears N. 12° W., 42 lks. dist., marked T 6N R 37E S23 BT. Evidence found: Standard ¾" BLM brass cap on 2½" x 28" iron post, protruding 4," stamped "T 6N, R 37E S 23, 24, 26 and 25, 1965" with the following bearing trees for accessories; The N.E., S.E, and S.W., BLM bearing trees. Corner Perpetuation: None.

MOUNUMENT AND ACCESSORIES FOUND:

Found a ¾ BLM brass cap on a 2½ inch iron pipe marked T6N, R37E S23, S24, S25, S26 1965, from which the remains of the original bearing tree: a 36 inch diameter fir snag with rotted blaze bears S26°E 7.3 feet.