

Index  
File No. T 18

**CORNER RECORD (SEARCH)**  
(Ref. FSM 7151.4)

Tract or  
Survey No. \_\_\_\_\_ Cor.  
No. \_\_\_\_\_

T 6N R. 38E R.D. Walla Walla County Umatilla  
Merid. Willamette N.F. Umatilla State Oregon

**CORNER DIAGRAM**

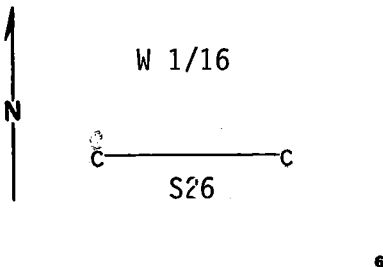

**DESCRIBE CORNER MONUMENT FOUND**

Found 3" BLM brass cap on 2½ pipe protruding 4" above ground.  
Few stones piled on downhill side. Stamped 1991

**DESCRIBE BEARING TREES OR OTHER OFFICIAL ACCESSORIES FOUND**

- 1) Found 36" dia Fir with 54-3 reading T6 R 38 E S26 S86 W 31 lks. RJ 9/91
- 2) Found 22" Pine tree with 54-3 reading T6N R38E S 26 N 11½ E 67 lks. RJ 9/91

**PHOTO IDENTIFICATION DATA**

Photo No. \_\_\_\_\_  
Filed At. \_\_\_\_\_  
Object Ident. \_\_\_\_\_  
Ident. By \_\_\_\_\_  
*Signature* \_\_\_\_\_

**DESCRIBE CORNER LOCATION RELATIVE TO NEAR-BY FEATURES, ALSO HOW TO REACH CORNER**

Drive east 1½ miles on Tiger Mountain Road from upper switch-back. Head west 250' down open ridge then 100' north to corner.

**PLANE COORDINATE POSITION DATA**

State \_\_\_\_\_ Zone \_\_\_\_\_  
X \_\_\_\_\_  
Y \_\_\_\_\_  
Estab. By \_\_\_\_\_  
*Agency* \_\_\_\_\_

Signature

Title

Division

Headquarters

Date

FS-7100-52 (3/68)

PAUL TOMKINS

PLS 2360

7/92

**CORNER RECORD (PERPETUATION)**

**MONUMENT: DESCRIBE NEW MONUMENT SET, OR WORK DONE TO PRESERVE EXISTING MONUMENT**

**ACCESSORIES : DESCRIBE NEW BT'S WITNESS OBJECTS ETC. ESTABLISHED, OR WORK DONE TO PRESERVE EXISTING EVIDENCE**

Work Done By \_\_\_\_\_ Title \_\_\_\_\_ Date \_\_\_\_\_ State Registration No. \_\_\_\_\_  
or Agency \_\_\_\_\_

Certified Cor. Record Prepared ? Yes ( No ) Filed At: \_\_\_\_\_ Date \_\_\_\_\_

**REMARKS**

Index File No. T 18 T. 6N R. 38E M. W.M. Tract or Surv. No. Cor.

USDA-FOREST SERVICE

Index  
File No. T-18

CORNER RECORD (SEARCH)

(Ref. FSM 7151.4)

Tract or  
Survey No. \_\_\_\_\_  
Cor.  
No. \_\_\_\_\_

T 6N R. 3BE R.D. WALLA WALLA County UMATILLA

Merid. WILLAMETTE N.F. UMATILLA State OREGON

CORNER DIAGRAM

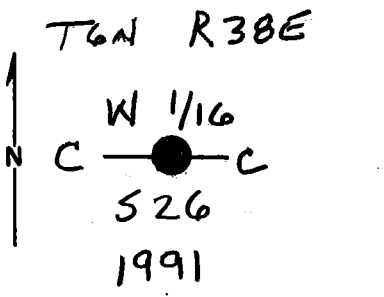

DESCRIBE CORNER MONUMENT FOUND

BRASS-CAPPED STEEL PIPE SET BY SURVEY BY B.L.M.

DESCRIBE BEARING TREES OR OTHER OFFICIAL ACCESSORIES FOUND

PHOTO IDENTIFICATION DATA

Photo No. \_\_\_\_\_  
Filed At. \_\_\_\_\_  
Object Ident. \_\_\_\_\_  
Ident. By \_\_\_\_\_  
*Signature*

DESCRIBE CORNER LOCATION RELATIVE TO NEAR-BY FEATURES, ALSO HOW TO REACH CORNER

PLANE COORDINATE POSITION DATA

State \_\_\_\_\_ Zone \_\_\_\_\_  
X \_\_\_\_\_  
Y \_\_\_\_\_  
Estab. By \_\_\_\_\_  
*Agency*

Signature

Title

Division

Headquarters

Date

1991

FS-7100-52 (3/68)

**CORNER RECORD (PERPETUATION)**

**MONUMENT: DESCRIBE NEW MONUMENT SET, OR WORK DONE TO PRESERVE EXISTING MONUMENT**

9

**ACCESSORIES : DESCRIBE NEW BT's WITNESS OBJECTS ETC. ESTABLISHED, OR WORK DONE TO PRESERVE EXISTING EVIDENCE**

10

Work Done By \_\_\_\_\_ Title \_\_\_\_\_ Date \_\_\_\_\_ State Registration No. or Agency \_\_\_\_\_

Certified Cor. Record Prepared ? Yes No Filed At: \_\_\_\_\_ Date \_\_\_\_\_

**REMARKS**

12

Index File No. T. R. M. Tract or Surv. No. Cor. 13