

CERTIFIED RECORD OF LAND CORNER MONUMENTATION

History of original corner establishment: Corner established in 1881
by Henry Meldrum, under Contract No. 380

Surveyor General Record States:

80.00 set basalt stone 18x10x9 in a mound of stone for
cor. to Secs. 1, 6, 7, 12 from which:

A pine 15" in diam. brs. N. 17° E. 140 lks.

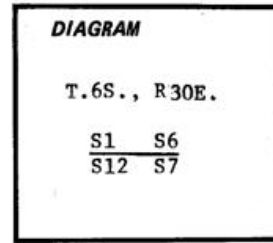

No record of subsequent remonumentation found in County Records.

Description of corner evidence found:

Found original section corner: A basalt stone 16"x9"x8" marked with 5 notches on
south edge and 1 notch on north edge firmly set in a mound of stone, From which:

Original Bearing Tree:

A 20" pine bears N. 17° E., 96.4 ft. mkd T6 in opened weathered blaze.

Description of monument and accessories established to perpetuate the
original location of this corner:

At the corner point: Set a 2½"x30" galvanized iron pipe 12" in the ground with brass
cap marked as shown. From which I scribe NEW BEARING TREES:

- An 11" pine bears S. 36° E. 43.1 ft. mkd. T6S R31E S7 BT.
- A 10" pine bears S. 30° W. 46.4 ft. mkd. T6S R30E S12 BT.
- A 12" pine bears N. 54° W. 14.0 ft. mkd. T6S R30E S1 BT.

I Nailed a brass washer marked "OPLS 598" to the BT blaze of the new BTs. Set a steel
fence post 5 ft. South of corner. Buried original corner stone West and alongside
iron pipe. Raised mound of stone, 4.5 ft. base, to top of pipe. Used compass with
20° East variation and steel tape, measuring to center of new BTs.

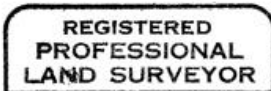

Robert D. Baggett



Sept. 30, 1976

Office of..... County Surveyor..... County of..... Umatilla
Oregon
State of....., I hereby certify that the within instrument was filed in this office
for record on the..... day of....., 19.....
..... by
(COUNTY OFFICIAL) (DEPUTY)

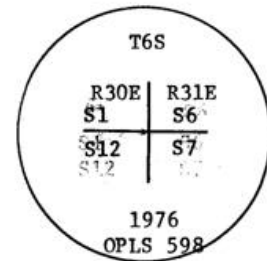

E-25

S-60-M