

LAND CORNER RECORD

5680-2

1. T 6S R 29E No. L-25 Cor. 1/4 Mer. W State Oregon (Rectangular) N. F. Umatilla Dist. Ukiah 24

2. Corner Status

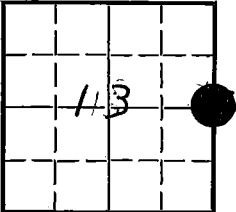

3. Original Description _____ Vol. _____ Page _____ Where Recorded _____

4. Description of Corners: Corner is a post from which:
 a Pine 20" in dia. bears N. 79°W. 56 lks.
 A Pine 28" in dia. bears East 23 lks.
 ● See mon. file, Brass Cap,

7. Photo Identification
 Photo No. E.B.I. 7-51
 Ident. By: KRJ

5. Investigation Notes:
 Sec. 13 B.T. 29 $\frac{1}{2}$ " Ponderosa pine, vigorous, painted red stripe around tree, and placed form 54-3 on tree.
 Sec. 18 B.T. is dead and fallen, but scribing is visible in old catface. Post has been placed at approx. corner.

8. Plane Coordinate Position Data
 State _____ Zone _____
 X _____
 Y _____
 Estab. By _____
 Field Book No. _____
 Where Filed _____

9. Evaluation
 Authentic _____
 Needs Verif. _____ Monument No
 Re-estab. X Survey _____
 Land Status Public Domain

6. Signed Kenneth R. Johnson Forester Title _____ Date 6-3-65

PERPETUATION RECORD

10. Monument:

11. Accessories

Field Book _____ Page _____

12. Set By _____ Title _____

License _____ Agency _____ Date _____

13. Recorded By _____ Volume _____ Page _____

(Agency)

(Date) _____ (City) _____ (County) _____ (State) _____

14. Remarks:

L-25

Index
File No. L-1

CORNER RECORD (SEARCH)
(Ref. FSM 715T.4)

Tract or
Survey No. _____ Cor.
No. L-1

T 6S R. 30E R.D. NK19b County Morrow-Umatilla Co. Line

Merid. Wil. N.F. Umatilla State Oregon

CORNER DIAGRAM

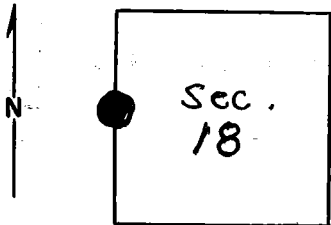

DESCRIBE CORNER MONUMENT FOUND

Brass Cap monument.
see L-25, T.6S, R.29E, monumentation
file.

2

DESCRIBE BEARING TREES OR OTHER OFFICIAL ACCESSORIES FOUND

3

DESCRIBE CORNER LOCATION RELATIVE TO NEAR-BY FEATURES, ALSO HOW TO REACH CORNER

4

PHOTO IDENTIFICATION DATA

Photo No. _____
Filed At. _____
Object Ident. _____
Ident. By. _____
Signature

6

7

PLANE COORDINATE POSITION DATA

State _____ Zone _____
X _____
Y _____
Estab. By. _____
Agency

8

Signature
F. Hollamon

Title _____ Division _____ Headquarters _____

Date
1/75

5

CORNER RECORD (PERPETUATION)

MONUMENT: DESCRIBE NEW MONUMENT SET, OR WORK DONE TO PRESERVE EXISTING MONUMENT

9

ACCESSORIES : DESCRIBE NEW BT'S WITNESS OBJECTS ETC. ESTABLISHED, OR WORK DONE TO PRESERVE EXISTING EVIDENCE

10

Work Done By _____ Title _____ Date _____ State Registration No. or Agency _____

Certified Cor. Record Prepared ? Yes No Filed At: _____ Date _____

11

REMARKS

12

Index File No. T. R. M. Tract or Surv. No. Cor. _____

13