

USDA-FOREST SERVICE

Index  
File No. E-25

CORNER RECORD (SEARCH)  
(Ref. FSM 7151.4)

Tract or  
Survey No. Sec 1 Cor. SE COR

T 6S R. 31E

R.D. Dale County Umatilla

Merid. Willamette

N.F. Umatilla State Oregon

CORNER DIAGRAM

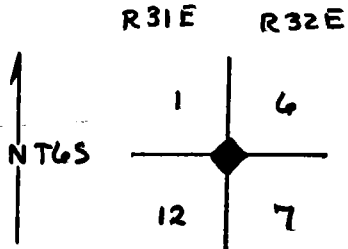

DESCRIBE CORNER MONUMENT FOUND

Old rock crib in fence, 4x4x 1 1/2 feet, in a fence extending north and south. This point is accepted as the best available evidence of the position of the original corner and is in good harmony with surrounding identified corners.

DESCRIBE BEARING TREES OR OTHER OFFICIAL ACCESSORIES FOUND

Section corner

PHOTO IDENTIFICATION DATA

Photo No. \_\_\_\_\_

Filed At. \_\_\_\_\_

Object Ident: \_\_\_\_\_

Ident. By \_\_\_\_\_

Signature \_\_\_\_\_

DESCRIBE CORNER LOCATION RELATIVE TO NEAR-BY FEATURES, ALSO HOW TO REACH CORNER

PLANE COORDINATE POSITION DATA

State \_\_\_\_\_ Zone \_\_\_\_\_

X \_\_\_\_\_

Y \_\_\_\_\_

Estab. By \_\_\_\_\_

Agency \_\_\_\_\_

Signature

Title

Division

Headquarters

Date

7100-52-(3/68)

/s/ J.C. Ives

Cadastral Surveyor

1968

5

CORNER RECORD (PERPETUATION)

MONUMENT: DESCRIBE NEW MONUMENT SET, OR WORK DONE TO PRESERVE EXISTING MONUMENT

Set an iron post, 28" x 2 1/2", 16" in the ground, to bedrock, and in a mound of stone, 3 1/2 ft. base, to top, with brass cap marked.

ACCESSORIES: DESCRIBE NEW BT'S WITNESS OBJECTS ETC. ESTABLISHED, OR WORK DONE TO PRESERVE EXISTING EVIDENCE

No suitable bearing trees available

Work Done By J. C. Ives Title Cadastral Surv Date 1968 State Registration No. or Agency \_\_\_\_\_

Certified Cor. Record Prepared? Yes  No  Filed At: \_\_\_\_\_ Date \_\_\_\_\_

REMARKS

Info copied from file card E-1 T63 R322

Index File No. E-25 T. 65 R. 31E M. Willamette Tract or Surv. No. Sec 1 Cor. SE COR

Index File No. E-25  
T 6S R. 31E  
Merid. Willamette

CORNER RECORD (SEARCH)

Tract or Survey No. 5-10 Cor. No. E-25

R.D. Ukiah County Umatilla  
N.F. Umatilla State Oregon

CORNER DIAGRAM

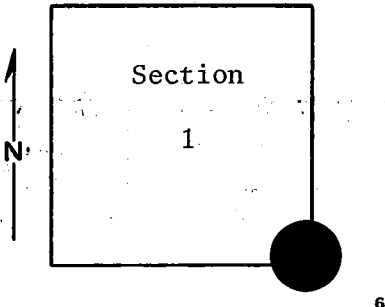

DESCRIBE CORNER MONUMENT FOUND Brass cap monument.  
See E-1, T6S, R32E.

DESCRIBE BEARING TREES OR OTHER OFFICIAL ACCESSORIES FOUND

PHOTO IDENTIFICATION DATA  
Photo No. \_\_\_\_\_  
Filed At. \_\_\_\_\_  
Object Ident. \_\_\_\_\_  
Ident. By. \_\_\_\_\_  
*Signature*

DESCRIBE CORNER LOCATION RELATIVE TO NEAR-BY FEATURES, ALSO HOW TO REACH CORNER

PLANE COORDINATE POSITION DATA  
State \_\_\_\_\_ Zone \_\_\_\_\_  
X \_\_\_\_\_  
Y \_\_\_\_\_  
Estab. By \_\_\_\_\_  
*Agency*

Signature \_\_\_\_\_ Title \_\_\_\_\_ Division \_\_\_\_\_ Headquarters \_\_\_\_\_ Date \_\_\_\_\_

T, Hollamon Engineering Technician S, O, March 21, 1974

**CORNER RECORD (PERPETUATION)**

**MONUMENT. DESCRIBE NEW MONUMENT SET, OR WORK DONE TO PRESERVE EXISTING MONUMENT**

9

**ACCESSORIES : DESCRIBE NEW BT'S WITNESS OBJECTS ETC. ESTABLISHED, OR WORK DONE TO PRESERVE EXISTING EVIDENCE**

10

Work Done By \_\_\_\_\_ Title \_\_\_\_\_ Date \_\_\_\_\_ State Registration No. or Agency \_\_\_\_\_

Certified Cor. Record Prepared ? Yes No Filed At: \_\_\_\_\_ Date \_\_\_\_\_

11

**REMARKS**

12

Index File No. T. R. M. Tract or Surv. No. Cor. 13

Index  
File No. E-1

**CORNER RECORD (SEARCH)**  
(Ref. FSM 7151.4)

Tract or Survey No. 5-9 Cor. No. E-1

T 6S R. 32E

R.D. Ukiah County Umatilla

Merid. Willamette

N.F. Umatilla State Oregon

**CORNER DIAGRAM**

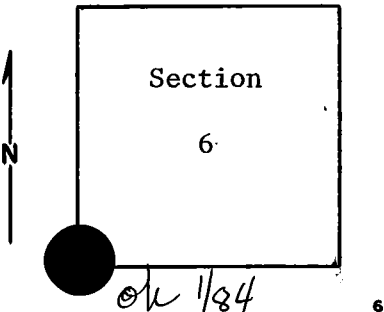

**DESCRIBE CORNER MONUMENT FOUND**

Material: Iron pipe with brass cap.  
Size: 2" pipe, 3/4" cap.  
12" above ground; good condition.  
Set in stone mound. Mound has 3' diameter, is 10" deep. (cont. block 12)

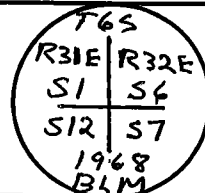

**DESCRIBE BEARING TREES OR OTHER OFFICIAL ACCESSORIES FOUND**

None.

Located in open ground. Easy to find.

**PHOTO IDENTIFICATION DATA**

Photo No. \_\_\_\_\_  
Filed At. \_\_\_\_\_  
Object Ident. \_\_\_\_\_  
Ident. By \_\_\_\_\_  
*Signature*

**DESCRIBE CORNER LOCATION RELATIVE TO NEAR-BY FEATURES, ALSO HOW TO REACH CORNER**

Monument sets 3 feet west of north-south fence, at head of drainage. (Small tributary of Bridge Creek.)

**PLANE COORDINATE POSITION DATA**

State \_\_\_\_\_ Zone \_\_\_\_\_  
X \_\_\_\_\_  
Y \_\_\_\_\_  
Estab. By \_\_\_\_\_  
*Agency*

From road S-522 at forest boundary, proceed 1 mile south along fence line.

Signature  
T, Hollamon

Title Division  
Engineering Technician

Headquarters  
S, O,

Date  
March 21, 1974

7100-52-(3/68)

**CORNER RECORD (PERPETUATION)**

**MONUMENT : DESCRIBE NEW MONUMENT SET, OR WORK DONE TO PRESERVE EXISTING MONUMENT**

**ACCESSORIES : DESCRIBE NEW BT'S WITNESS OBJECTS ETC. ESTABLISHED, OR WORK DONE TO PRESERVE EXISTING EVIDENCE**

Work Done By \_\_\_\_\_ Title \_\_\_\_\_ Date \_\_\_\_\_ State Registration No. \_\_\_\_\_  
or Agency \_\_\_\_\_

Certified Cor. Record Prepared ? Yes No Filed At: \_\_\_\_\_ Date \_\_\_\_\_

(Block #2, cont.)

**REMARKS**

Sets 3 feet west of fence.

Index File No. T. R. M. Tract or Surv. No. Cor. \_\_\_\_\_