

USDA-FOREST SERVICE

Index

File No. 7-18

T6S

R32E

Merid. Willanette

R.D.

N.F.

CORNER RECORD (SEARCH)

Ref. FSM 7151.4

North Fork John Day

Umatilla

Tract or

Survey No

County Umatilla

State Oregon

Cor.

No.

x

Corner Diagram

1 | 535
W--|---
16 | S2
1968

1 Describe corner monument found
1 Standard BLM brass cap stamped as shown in the corner diagram.

x

Photo Identification Data

Photo No.

filed at

Object Ident.

Ident. by

Signature

1 Describe bearing trees or other official accessories found
1 A 8" White Fir bears S38 W, 4.2'.
1 A 13" Douglas Fir bears N57 E, 32.5'.

x

Plane Coordinate Position Data

State

Zone

X

Y

Estab. by

Agency

1 Describe corner location relative to near-by features, also how to reach corner
1 From the junction of roads 55 and 5505, follow road 5505 southeast 2.2 miles
1 to road 050. Follow road 050 0.1 mile to the beginning of the first switchback.
1 From this point, go west 200' to a fenceline. Then go north 100' along the
1 fence to the corner.

x

Signature

Title

Division

Headquarters

Date

7100.52

David L. Halden
Land Surveyor

Pendleton, OR

July 1988

CORNER RECORD (PERPETUATION)

X _____ X
Monument: Describe new monument set, or work done to preserve existing monument

None

X _____ X
Accessories: Describe new BT's witness objects etc. established, or work done to preserve existing evidence

Made bands around trees and painted bands and scribe blazes red. Attached Forest Service Land Survey Monument and Bearing Tree signs to the trees.

X _____ X
Work done by David L. Haddock Title Land Surveyor Date July 1988 State Registration No. 852
Certified cor. record prepared? yes no x Filed at Date

X _____ X
REMARKS

X _____ X

Index File No. 2-18 T65, R32E
T R 32 E R.D. 32 E
Merid. Willamette N.F. Umatilla

CORNER RECORD (SEARCH)
(Ref. FSM 7151.4)
Date _____ County _____ State _____
Grant _____ Oregon _____

Tract or Survey No. _____ Cor. No. _____

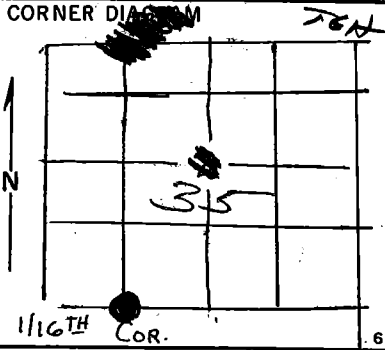

DESCRIBE CORNER MONUMENT FOUND
Brass Cap $3\frac{1}{4}$ dia. 5" high good condition
Markings - W 1/16 S 35 - 1968
Cadastral Survey S2 BLM *see mon. file T65, R32E*

DESCRIBE BEARING TREES OR OTHER OFFICIAL ACCESSORIES FOUND
Bearing Tree - 7" DBH - Blazed on NE side with 1/16 in blaze.
Tag 54-3 - S 57 W - 49 links to corner - T7S, R 32 E, Sec. 35 W
1/16 D.B. - 9-10-68 - Douglas Fir - Same tree - G.P. Tag -
T7S, R32E. - .06 ch. N 34 E - 1/16 cor. IP - Rs.

PHOTO IDENTIFICATION DATA
Photo No. EXR-78-4-233
Filed At. 2210 CENTRAL DESOL. C&H
Object Ident. Photo Punched / I.D.
Ident. By 8-10-71
Signature _____

Range office

DESCRIBE CORNER LOCATION RELATIVE TO NEAR-BY FEATURES, ALSO HOW TO REACH CORNER
Bearing Tree - D. Fir blazed on S.E. side - Metal Tag 54-3
Corner is approx. N 38 E - 6 links. T7S, R32E, Sec.2
Corner W 1/16 D.B. 9-10-68
Bearing Tree - D. Fir - blazed on SW side - metal tag - G.P.
T6S R32E - JP - RS - 0.21 ch. S 30 W 1/16 corner

PLANE COORDINATE POSITION DATA
State _____ Zone _____
X _____
Y _____
Estab. By _____ Agency _____

Signature Emery Swann Title Range Conser. Division Range Headquarters Dale Date 8-25-72
7100-52 (3/68) *7*

CORNER RECORD (PERPETUATION)

MONUMENT: DESCRIBE NEW MONUMENT SET, OR WORK DONE TO PRESERVE EXISTING MONUMENT

Bearing Tree - G.P. Tag - P.Ponderosa - 35" DBH just below main spur road off Turner Basin road after making big horse shoe turn approx. 1/3 rd. mile from Turner Basin Main road. off ~~main~~ road. approx. 10 feet - easily seen. T7S,R32E. HBS - 7 ch. N 1/16 cor.

9

ACCESSORIES : DESCRIBE NEW BT's WITNESS OBJECTS ETC. ESTABLISHED, OR WORK DONE TO PRESERVE EXISTING EVIDENCE

10

Work Done By _____ Title _____ Date _____ State Registration No. or Agency _____

Certified Cor. Record Prepared ? Yes No Filed At: _____ Date _____

11

REMARKS

12