

CERTIFIED RECORD OF LAND CORNER MONUMENTATION

History of original corner establishment:

Corner established in April, 1883, by Frank W. Campbell, under contract No. 468.

Set 12" x 12" x 12" in stone 8" in ground marked $\frac{1}{4}$ on the North faces.

A pine 30 in. diam. brs. S 36° W 57 lks. marked $\frac{1}{4}$ S31 BT
A pine 30 in. diam. brs. N 9° E 63 lks. marked $\frac{1}{4}$ S30 BT

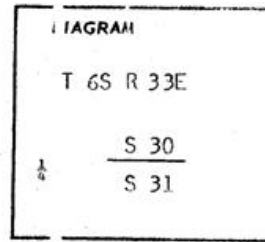

No record of subsequent remonumentation found in County Records.

Description of corner evidence found:

None found.

Description of monument and accessories established to perpetuate the original location of this corner

Set $2\frac{1}{2}$ " x 30" iron pipe 23" in ground with brass cap marked as shown from which I scribed bearing trees:

A fir 10 in. diam. brs. N $28^{\circ}10'$ E 34.55 ft. marked $\frac{1}{4}$ S30 BT
A pine 16 in. diam. brs. S $68^{\circ}45'$ W 31.30 ft. marked $\frac{1}{4}$ S31 BT

Nailed a brass washer marked PLS 933 to the BT blaze of all trees. Set steel post 3 ft. East of corner. The corner is North 28° East 200 ft. of a road which runs Northeast by Southwest. Used T-2 and steel tape, measuring a horizontal distance to the center of the bearing trees.

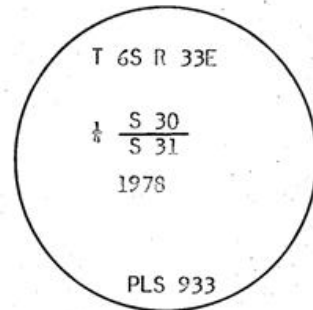
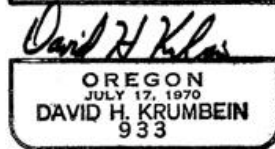
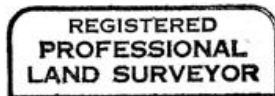

Office of County Surveyor County of Umatilla
State of Oregon, I hereby certify that the within instrument was filed in this office for record on the day of
by (COUNTY OFFICIAL) (DEPUTY)

Q-917