

USDA-FOREST SERVICE

Index

File No. X-21

CORNER RECORD (SEARCH)

(Ref. FSM 7151.4)

Tract or
Survey No. _____

Cor.
No. W 1/4

T 6 S. R. 34 E.

R.D. NORTH FORK JOHN DAY County UMATILLA

Merid. WILLAMETTE

N.F. UMATILLA State OREGON

CORNER DIAGRAM

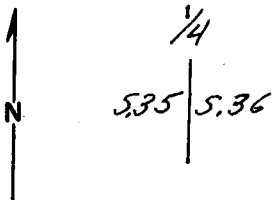

DESCRIBE CORNER MONUMENT FOUND

NONE

DESCRIBE BEARING TREES OR OTHER OFFICIAL ACCESSORIES FOUND

NONE

PHOTO IDENTIFICATION DATA

Photo No. 580-58

Filed At. PENDLETON

Object Ident. PRECISE

Ident. By _____

Signature

PLANE COORDINATE POSITION DATA

State _____ Zone _____

X _____

Y _____

Estab. By _____

Agency

DESCRIBE CORNER LOCATION RELATIVE TO NEAR-BY FEATURES, ALSO HOW TO REACH CORNER

TAKE R.R. 52 TO POSTED BOUNDARY, CORNER IS EASILY SEEN NORTH OF ROAD

Signature

Clayton J. [Signature]

Title

LAND SURVEYOR

Division

Headquarters

Date

10/24/86

FS-7100-52 (3/68)

CORNER RECORD (PERPETUATION)

MONUMENT: DESCRIBE NEW MONUMENT SET, OR WORK DONE TO PRESERVE EXISTING MONUMENT

SET CORNER AT PROPORTIONATE MEASURE, A 2 1/2" DIAM. ALUM. CAP ON A 2 1/2" X 30" ALUM. PIPE W/FLARE AT BOTTOM. CAP MKD. PER SKETCH.

RAISED STONE MOUND.

SET STEEL POSTS 4'E. & S. W/ATN., PROP. BNDRY., AND MON. SIGNS ATTACHED.

T65 R34E

1/4

S35|S36

RPLS 1910

1986

9

ACCESSORIES : DESCRIBE NEW BT'S WITNESS OBJECTS ETC. ESTABLISHED, OR WORK DONE TO PRESERVE EXISTING EVIDENCE

① 16" D.B.H. TAMARACK, N. 52 1/2° E, 25.5', SCRIBED 1/4 S36 BT.

② 7" D.B.H. WHITE FIR, N. 25 1/2° W, 92.5', SCRIBED 1/4 S35 BT.

SET BRASS WASHER MKD. RPLS 1910 BTWN. B&T OF EACH BT. SET B.T. TAGS, ATN. SIGNS, PAINTED BANDS AND FACES RED.

10

Work Done By C.J. MARTIN

Title LAND SURVEYOR

Date 10/24/86

State Registration No. or Agency

L 5 1910

Certified Cor. Record Prepared ? Yes

(No)

Filed At:

Date

11

REMARKS

Index File No.

X-21

T. 6 S.

R. 34 E.

M. WILLAMETTE Tract or Surv. No.

Cor. 1/4

S35|S36

12

13