

Area	
Section	Acres
17	817.23
18	818.93
19	821.22
20	823.52
21	825.82
22	828.12
23	830.42
24	832.72
25	835.02
26	837.32
27	839.62
28	841.92
29	844.22
30	846.52
31	848.82
32	851.12
33	853.42
34	855.72
35	858.02
36	860.32
37	862.62
38	864.92
39	867.22
40	869.52
41	871.82
42	874.12
43	876.42
44	878.72
45	881.02
46	883.32
47	885.62
48	887.92
49	890.22
50	892.52
51	894.82
52	897.12
53	899.42
54	901.72
55	904.02
56	906.32
57	908.62
58	910.92
59	913.22
60	915.52
61	917.82
62	920.12
63	922.42
64	924.72
65	927.02
66	929.32
67	931.62
68	933.92
69	936.22
70	938.52
71	940.82
72	943.12
73	945.42
74	947.72
75	950.02
76	952.32
77	954.62
78	956.92
79	959.22
80	961.52
81	963.82
82	966.12
83	968.42
84	970.72
85	973.02
86	975.32
87	977.62
88	979.92
89	982.22
90	984.52
91	986.82
92	989.12
93	991.42
94	993.72
95	996.02
96	998.32
97	1000.62
98	1002.92
99	1005.22
100	1007.52
Total	14625.84

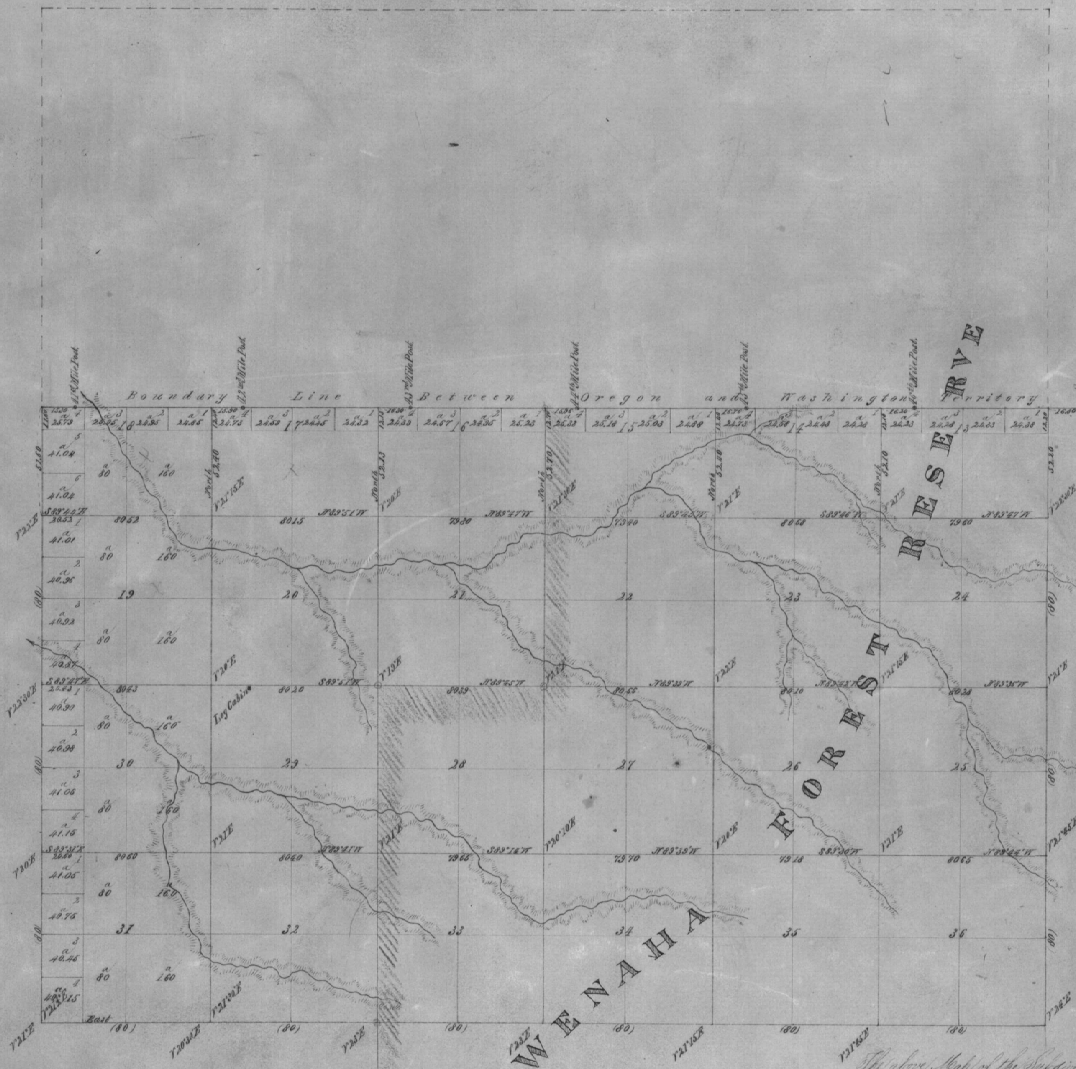

### General Description.

This township is out by map, census, and is well suited for agricultural purposes. The timber consists of Pine, Spruce, Fir, Hemlock, Alder, Birch, Alder, Cottonwood, and fir, growing on mountain sides and in patches is very valuable, being owned by the settlers of Wentaaha Valley.

Lines	Contractors	Contract Date	Subdivided into Acres	Commenced	Completed
Subdivisions	George Williams	178 July 20, 1872	36 25 12	October 5, 1872	October 15, 1872
Subdivisions			1 01 12		
		Total	37 25 24		

The above Map of the Subdivisional lines of Township 6 North, Range 38 East, Will. Mer. Oregon is strictly conformable to the original field notes of the survey thereof on file in this office, which have been examined and approved.  
 J. S. Savage, General Office,  
 Eugene City, Oregon,  
 September 15, 1872.

W. A. Cole  
 Surveyor Genl. of Oregon.