

PLAT AND RECORD OF SURVEY No. 20

Survey of H. N. Burton's Land bought of J. M. Mc Cullough

Course.	Degrees.	Minutes.	Chains.	Links.	
					Commenced at the corner of S. 33 34. 27 & E. 28. E. of N. R. 28. E. of W. M.
East			7	00	from which we run East Set Post for the N. W. corner from which we run
South			10	00	thence
S 30° E			17	50	Amatilla River thence along the meanders of <sup>River</sup> said
" 50° "			29	50	"
" 70° "			25	00	"
N 40° E			29	50	"
North			32	00	"
N 67° W			36	00	"
North			39	50	leave Amatilla River
"			50	00	Intersect line between Secs 34 & 27 Town 4 North Range 28 E of W. M. and set Post for N. E. corner thence West on said line
West			10	00	To the N. W. corner containing 15 acres more or less T. 4 N. R. 28 E. of W. M.

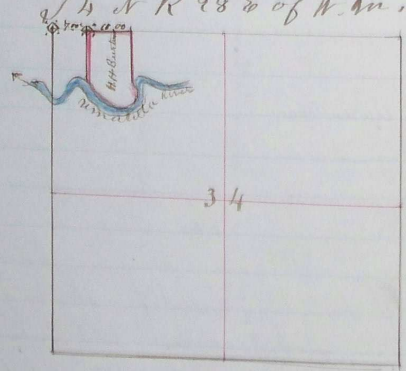

I hereby certify that the above is a true and correct plat and Survey of H. N. Burton's Land this 20<sup>th</sup> day of Oct. 1853. A. L. Coffey County Surveyor Matilla