

PLAT AND RECORD OF SURVEY No. 3519

Request of J. C. Hodgens et al. Oct 15. 1888

Subdivision of Sec. 29 T 6 N. R 35 E. W. 7 M.

Course. Degree. Minutes. Chains. Links.

Assisted by Louis Hodgens and J. E. McCoy, sworn chainmen, and J. C. Hodgens and Chas. Sanders, sworn flagmen, with a Burtis improved Solar Compass, adjusted to the sun's declination for Oct. 15. 1888.

Commence at $\frac{1}{4}$ sec. cor. bet. secs. 31 & 32, T 6 N. R 35 E, which is some parts of a very old post, much decayed, but showing scales of charred exterior, 12 ins. in ground, in slight mound, with plain pits E & W of same, 6 ft. dia. Set, over charred end of post, a boulder 15 x 7 x 7 ins., 7 mks. $\frac{1}{4}$ on W.

This cor. is 60 links E. of a small draw that runs N. into a hollow, coarse m. Iron, thence, on random line bet. secs. 31 & 32, α . 20° 30' E.

North

- 250 Old road, course E & W.
- 300 harrow, course W. - ascend.
- 530 Summit.
- 1500 Small draw, course W.
- 3500 Descend.
- 3930 Old ditch fence, bears E & W.
- 40.00 Set temp. sec. cor. - Find no indications of original cor.
- 42.50 Irrigating ditch, bears N E & S W.
- 48.70 Spring creek, 7 links wide, runs west.
- 57.34 Ditch fence, E & W.
- 60.00 Set temp. $\frac{1}{16}$ sec. cor.
- 78.75 Int. E & W. line, 144 links west of $\frac{1}{4}$ sec. cor. bet. secs. 29 & 30, which is the charred end of original $\frac{1}{4}$ sec. post, 12 ins. in ground at cor. of fences rung. E, S & W. of cor.

Set, over the charred end of the original $\frac{1}{4}$ sec. post, an oval shaped porous basaltic stone 16 x 9 x 7 ins., 7 mks. $\frac{1}{4}$ on west, 12 ins. deep.

Therefore, move temp. $\frac{1}{16}$ sec. cor. on $\delta \frac{1}{2}$ of line bet. secs. 29 & 30, South 93 $\frac{3}{4}$ links, then East 108 links and set a smooth boulder 16 x 6 x 4 ins., 7 mks. $\frac{1}{16}$ on W. face, 16 ins. deep.

Move temp. cor. to secs. 29-30-31-32, South 62 $\frac{1}{2}$ links, then East 108 links and set a smooth basalt boulder 16 x 6 x 5 ins., 7 mks. 5 notches on E. and 1 notch on S, set in N. edge of E & W. ditch.

Dist. Acres. Acres. Chain. Links.

East on random line bet secs. 29+32. 2 ac. 22 1/2

8 20 Ditch fence bears N. & S. on W. side of lane.

8 67 " " " N. & S. " E. " " " " " "

13 10 Spring creek, 10 lks. W. runs N.

30 00 Set temp. $\frac{1}{4}$ sec. cor.

22 98 Spring creek, 8 lks. W. runs S. W.

27 26 " " " 15 " " " N. W.

29 35 Rail fence bears N. & S. on W. side of lane.

40 00 Set temp. $\frac{1}{4}$ sec. cor. - Find no. satisfactory evidences of orig. $\frac{1}{4}$ sec. corner, further than, 10 links East, at cor. fences N. & S. I find 2 plain, old pits, N. & S. of each other, about 18 links apart; without further present investigation, I saw it in interview with S. W. Hodgens, who is reputed to know the locality of true cor.

45 35 Old ditch fences bears N. & S.

55 00 Swamp.

60 00 Set temp $\frac{1}{4}$ sec. cor.

65 50 Leave swamp.

66 04 Ditch fence bears N. W. & S. E.

74 96 Int. N. & S. line 23 links N. of cor. to secs. 28, 29, 32, 33, which is the original charred end of sec. post, 12 ins. in ground, under a stone, in center of road in lane course N. & S. J. C. Hodgens says that Mr. Wearer put this stone here about 4 years ago, when the cor. was all plain.

I cut 4 notches on E. and 1 notch on S. of said stone, a basalt, 1 1/2 inches and reset the same, as I found it

Mr. S. W. Hodgens appears and says that the pits, found near temp $\frac{1}{4}$ sec. cor. on line bet secs. 29+32, have been growing less distinct for the past 16 years, since which time he has known of the same; says that the original post stood here, and that it has been acknowledged and unquestioned corner since he has known it. I dig and find, midway bet. the pits described, remnants of decayed post, over which I set a smooth boulder, 16 x 5 x 4 ins. in dia. $\frac{1}{2}$ on N. face, 16 ins. deep, about 50 lks. N. and 10 lks. E. of temp. cor.

Remove temp $\frac{1}{4}$ sec. cor. on E. $\frac{1}{2}$ of line bet. secs. 29+32 East 7 links and set right pole, on line bet. $\frac{1}{4}$ sec. & sec. cor. = E. $\frac{1}{2}$ of S. boundary sec. 29.

Course.	Degrees.	Minutes.	Chains.	Links.
---------	----------	----------	---------	--------

- North, on a random line bet. sec. 28 & 29 of T. 7. R. 33 E. 72. 21. 18 E.
- 15 00 Cross ditch fence on E. side of N. & S. lane - in ravine. -
- 19 70 Random course west.
- 20 00 Set temp. to sec. cor.
- 31 60 Ditch fence, bears E. & W.
- 40 00 Set temp. to sec. cor. - Find no traces of original cor.
- 40 20 Ditch fence, bears E. & W.
- 44 20 Spring branch, 10 lks. wide, course N. & W.
- 48 70 Old ditch fence.
- 60 00 Set temp. to sec. cor.
- 64 20 Center little mud creek, 10 lks. wide, course N. & W.
- 72 00 Jno. M. Cannon's house bears 110 lks. E.
- 79 93 Int. E. & W. line 74 links East of cor. to sec. 28 21 28 29, which is the original sec. post with charred end lying in ditch, course E. & W.

At a point certified to by Jno. M. Cannon, and J. C. Hodgson, et al. in center of ditch as described, I set a flat oval shaped boulder 12x7x4 ins. mkd. 4 notches on E. face and 2 notches on S. face, 8 ins. below bottom of ditch; set by it the original sec. post, with lower end charred.

I move temp. to sec. cor. on S $\frac{1}{2}$ of line bet. sec. 28 & 29, South 1 $\frac{1}{2}$ links, then west 18 $\frac{1}{2}$ links, and set 2 small unmarked stones over a brick mkd. F.

I move temp. to sec. cor. on line bet. sec. 28 & 29, South 5 $\frac{1}{2}$ links, then west 37 links, and set a smooth boulder 14x8x6 ins. 10 ins. deep, mkd. 4 on W. 25 lks. South of ditch fence course E. & W.

I move temp. to sec. cor. on N $\frac{1}{2}$ of line bet. sec. 28 & 29, South 5 $\frac{1}{4}$ lks. then west 55 $\frac{1}{2}$ links, and set smooth boulder, 17x9x5 ins. 12 ins. in ground, mkd. 7 on top.

West on a random bet. sec. 20 & 29 of T. 7. R. 33 E.

- 7 10 Spring branch (Little mud creek) course N. & W.
- 20 00 Set temp. to sec. cor.
- 20 75 Center of bend of N. & S. lane.

PLAT AND RECORD OF SURVEY No. 3519

Course	Degrees	Minutes	Chains	Links
--------	---------	---------	--------	-------

22 30 Descend.

24 00 Gravel flat Foot of descent.

40 00 Set temp. $\frac{1}{4}$ sec. cor. - Find no traces of original $\frac{1}{4}$ sec. cor., yet, there are 3 stone mounds, near by, (within a radius of 25 links) neither, however, containing, mkd stones, stakes, nor deposits.

42 00 Old wagon road, nearly N. & S.

52 85 Irrigating ditch 2 links wide, course N. W.

60 00 Set temp. to sec. cor., 4 lks. E. of N. & S. fence.

64 25 Old dry bed of Irrigating ditch, course N.

71 40 " road, bears N. W. & S. E.

80 44 Int. N. & S. line, 31 links south of cor. to secs. 19, 20, 29, 30, which is, the charred end of the original sec. post, 12 ins. in ground, in E. & W. lane, with fences running N. & S., from points on opposite sides of cor.

I set, over original charred end of post, a smooth boulder 18 x 6 x 5 ins., mkd. 5 notches on E. and 2 notches on S., 18 ins. in ground.

I move temp. to sec. cor. on E. $\frac{1}{2}$ of line bet. secs. 20 & 29, west 11 links, then north $7\frac{3}{4}$ links, and set a smooth boulder, 14 x 8 x 6 ins., mkd. + on top.I move temp. $\frac{1}{4}$ sec. cor., on line bet. secs. 20 & 29, west 22 links, then north, $15\frac{1}{2}$ links, and set a smooth boulder, 12 x 7 x 5 ins., mkd. $\frac{1}{4}$ on N. and + on top.I move temp. to sec. cor., on W. $\frac{1}{2}$ of line bet. secs. 20 & 29, west 33 links, then N., $23\frac{1}{4}$ links, and drive stake to mark the point.

I run straight lines N. & S. and E. & W. through the center of sec. 29 and at their intersection, I set a smooth boulder 16 x 7 x 6 ins., mkd. C.S. 29 on N., 12 ins. in ground, 5 links N. of N. Spring creek.

The N. & S. line 76 chs. in length + the E. & W. line 80.20 chs. in length. Intersection pt 40.04 chs. west of $\frac{1}{4}$ sec. cor. on E. body, and 39.12 chs. N. of $\frac{1}{4}$ sec. cor. on S. body, of sec. 29.On true N. & S. center line, I set, midway bet. $\frac{1}{4}$ S. cor. on S. body, and center sec. cor., a smooth boulder, 15 x 6 x 4 ins., 12 ins. in ground, mkd. + on W., for to sec. cor., 34 link N. of old ditch fence, with growing poplar trees along it, course E. & W.

PLAT AND RECORD OF SURVEY No. 35. 19

Chains Degrees Minutes Seconds Links

Midway bet. center cor. to sec. 29 S. 67. R. 35 E., and the 1/4 sec. cor. on N. brdy, on true center sec. lines I set a smooth boulder, 12x6x5 ins. 1/2 in. ground for 1/2 sec. cor. mkd. + on top.

I set 1/2 sec. cor. on E. & W. center sec. lines, midway bet. center sec. cor. and 1/2 sec. cor. on E. brdy, = a basalt stone mkd. + on top, in N. & S. lane.

I find point of intersection of lines joining N. & S. and E. & W. through center of S. E. 1/4 sec. 29 and set smooth boulder 16x7x6 ins. mkd. + on top 16 in. from center of north of lane course S.

In same way I find intersection of cross lines, and for center cor. to N. E. 1/4 sec. 29. I set smooth boulder 13x7x7 ins., mkd. + on top, set 13 ins. deep, in the center of north of lane course S.

Survey commenced Oct. 15 and ended Oct. 19 1888.

Jno. L. Arnold, County Surveyor.

Plat of Twp. 6 N. R. 35 E. N. 7 W.

Explanations.

40 chs = 1 inch

Directions same as for

all maps

o = stone corner

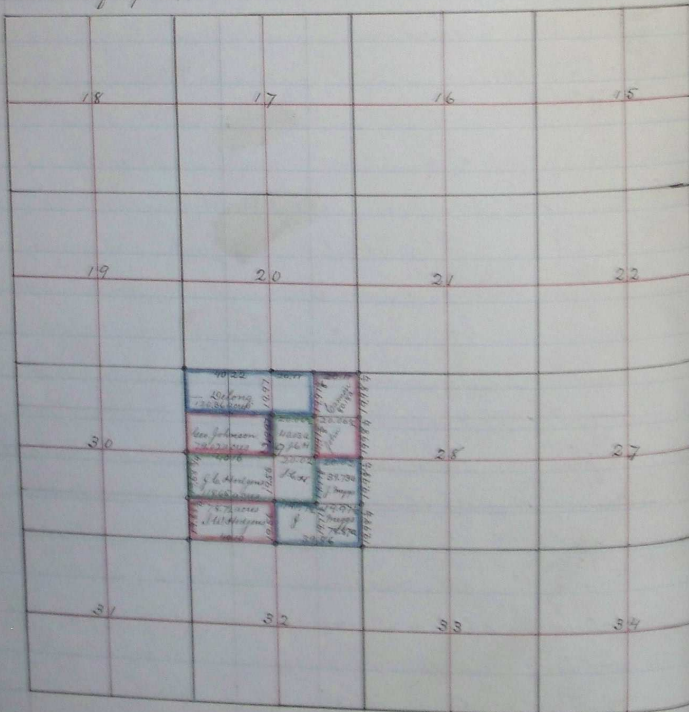

Jno. L. Arnold, County Surveyor.