

PLAT AND RECORD OF SURVEY No. 36

Request of A. M. Elam, et al., Oct. 23^d. 1888

Subdivision of Sec. 11 T. 5 N. R. 35 E. W. 7 M.

assisted by J. E. McCoy and J. Frazier, sworn chmn., and Eugene Cummins & pro. B. Frazier, sworn flagmen, with a Burts improved Solar Compass, properly adjusted, for date, Oct. 23^d, 1888. (Extremely windy and dust flying so that it is impossible to see beyond a few chains distance.)

I commence at cor. to secs. 13-14-23-24 T. 5 N. R. 35 E., which is a basalt stone of a size, and as deep in ground, as may be, in center of road, in N. & S. lanes, set by A. L. Coffey, County Surveyor, at true point for original sec. cor., and over charred end of original sec. post; this cor. is verified by S. K. Coe, Wm. Nichols, pro. B. Frazier and L. L. Berry

- | | | |
|--------|--|------------|
| | North, on a random line bet. secs. 13+14 T. 5 N. R. 35 E. — | ra. 21° E. |
| 40 00 | no indications of any cor. | |
| 40 57 | Post 4x6 ins., at intersection of roads in lanes E. and E. & W. | |
| 41 25 | Wire fence on N. side of E. & W. lane. | |
| 60 00 | Set temp. $\frac{1}{16}$ sec. on $N\frac{1}{2}$ of line bet. secs. 13+14. | |
| 80 00 | Set temp. cor. to secs. 11, 12, 13, 14 | |
| 84 20 | Int. E. & W. line 66 lks E. of disputed cor. = a post 4x4 ins. + 2 ft. out of ground. | |
| 100 00 | Set temp. $\frac{1}{16}$ sec. cor. on $E\frac{1}{2}$ of line bet. secs. 11+12 | |
| 104 80 | Fence, bears E. & W. | |
| 112 25 | " " " S. side of Cemetery | |
| 118 27 | " " " N. " " " | |
| 120 00 | Set temp. $\frac{1}{4}$ sec. cor. | |
| 140 00 | " " $\frac{1}{16}$ " " on $N\frac{1}{2}$ of line bet. secs. 11+12 | |
| 166 44 | Int. E. & W. line 90 links East of cor. to secs. 12-11-12, which is a smooth basalt stone, as deep as may be in ground, nicked on pointed top end, generally known as the Kirkland cor., and by which all land owners about it, are said to swear. | |

Corrections:—

$$166.44 \div 8 = 20.80\frac{1}{2}; \quad 90 \div 8 = 11\frac{1}{4}$$

Therefore, move temp. $\frac{1}{16}$ sec. cor. on $N\frac{1}{2}$ of line bet. secs. 13-14, north 241 $\frac{1}{2}$ lks., then west 33 $\frac{3}{4}$ links, and set a smooth stone, 12x8x4 ins., mkd. + on top, 29 lks. west of fence, N. & S., on a gentle East slope.

PLAT AND RECORD OF SURVEY No. 36.19

Course. Degree. Minutes. Chains. Links.

I move temp. cor. to secs. 11, 12, 13, 14 North 322 links, then west 45 links, and set a basalt stone 18x11x5 ins. mkd. 4 notches on S., and 1 on E. 18 ins. in ground, on gentle E slope, from which I measure 796 links, then west 20 links to disputed sec. cor. - Before setting this cor. I made diligent search, and examinations, running East bet. Secs. 12 & 13 and West bet. Secs. 11 & 14 and could find no traces of original cor.

I move temp. to sec. cor., on S. 1/2 of line bet. Secs. 11 & 12, North 40 1/2 links, then west 56 1/2 links, and set a smooth basalt stone 10x6x4 ins., 10 ins. in ground for to sec. cor., mkd. + on top on N hill side.

I move temp. to sec. cor., bet. Secs. 11 & 12, North 483 links, then west 67 1/2 links and set a basalt 11x7x5 ins., 11 ins. in ground for 1/4 sec. cor., mkd. 1/4 on on W. face, on N.W. slope.

I move temp. to sec. cor. on N. 1/2 of line bet. Secs. 11 & 12, North 56 3/4 links, then west 78 3/4 links and set a smooth basalt stone 12x6x5 ins., 12 ins. in ground for to sec. cor.

West, on random line bet. Secs. 11 & 14 - var. by sun, 21° E

40 00 Set temp. 1/4 sec. cor. Find no indications of any other cor.

51 10 Ravine, course S.W.

68 00 Int N & S line 71 links South of cor. to Secs. 10, 11, 14 & 15, which is an unmarked stake, in mound, with pit in each sec. cor., 5 1/2 ft. dist from the stake, under angle of fencing lines N, S. E. W on S. slope.

I find charcoal in this mound, but different from that I have generally found, this being more cubical than common; I find, also, the lower charred end of a cotton wood post, which is, without doubt, a portion of the original Sec. post. - I find the upper part of the original post, lying near by, upon the ground. - Statements: Mr. J. S. Richey, owner of land affected by this sec. cor. and being here present, says that he is well satisfied this is the correct, or true sec. cor. to Secs. 10, 11, 14, 15, S. 5 N. R. 35 E; that it has always ^{been} considered and taken as such, without question, in this neighborhood; that he has often seen the 1/4 sec. cor., on S. side of Sec. 11, as described, about 1/2 mile E. of said cor. to Secs. 10, 11, 14 & 15, on S. E. slope of hill; that for more than 10 yrs he has been well acquainted with this sec. cor.

Chains Links
Degrees Minutes Chains Links

Mr. F. J. Monic says, "About eleven years ago, I built a fence, south, from where I found the old post, lying on the ground, near a badger hole, into which I stuck the post. Some three years after this, Mr. Jas. Raley, County Surveyor, was surveying on this line; Lewis Berry and Geo. Berry had first found the stake, and told me about it. We told Mr. Raley these facts, and showed him the post in the badger hole. Mr. Raley, by digging, found rotten end of charred post, of cottonwood, in the ground about a foot and a half. The ground had not been dug into by any one, before Mr. Raley came to survey. Mr. Raley set the post in a mound, over the bits of charcoal, and dug the pits as found. The ^{point} ^{is} ^{sec.} ^{E.} of this, stood on S. E. slope, and was, by measure, one rod over full length" (This is Mr. Monic's statement to me verbatim, Co. Surveyor)

Mr. Wm. Bade says, he has been well acquainted with this cor. to secs. 10, 11, 14, 15, T. 57. R. 35 E. for more than ten years, that he has seen the Gov. stake, with mound and four pits, at this point; that he believes this to be the identical place of mound and pits, made by the original surveyor; that he has known of no other cor. in this vicinity; that he is not mistaken in the location of this cor., which he identifies by courses of old fences, position on hill side and frequent observation.

Over the charred end of original post, I set a basaltic boulder 19x9x8 ins. 18 ins. in ground, for cor. to secs. 10, 11, 14, 15, mkd. 4 notches on S. and 2 notches on E., on south slope at angle of fences northw'd, S. E. & W. (witness full crew, Jno. Frazer, Jas. Frazer, Eugene Cummins, J. E. McCoy, and, supernumeraries, J. S. Richey and Jas. G. Kirkland.) From this cor., I run on true line bet. secs. 11 & 14.

58 00 34 00 Set a porous basalt stone, 14x12x7 ins. mkd. 7/4 on N., on level, 14 ins. in ground. This cor. is 120 links S. of E. & W. fence, and 47 lks. E. of S. end of a division fence, rung. N. bet. Jas. Frazer and A. M. Elam.

51 00 Set smooth stone 9x11x4 ins. mkd. + on top, for 7/6 sec. cor. on E. 1/2 of line bet. secs. 11 & 14.

68 00 The stone cor. to secs. 11, 12, 13, 14, T. 57. R. 35 E.

North on a random line bet. secs. 10 & 11, parallel to a fence, claimed to have been built on true sec. lines, and which shows a bearing of about 71.9° W. ascend - rolling land.

Course.	Degrees.	Minutes.	Chains.	Links.
---------	----------	----------	---------	--------

40 00 Set temp. $\frac{1}{4}$ sec. cor., find no traces of original cor.

41 00 Fence runs E.

81 91 Int. E & W. line $3\frac{1}{2}$ links west of cor. to sec. 2, 3, 10 & 11, which is an unmarked post, in a mound by a stone $14 \times 6 \times 5$ ins., porous, basaltic, unmarked. This cor., as far as I am able to ascertain is accepted without question, to be correct.

I, therefore, cut 5 notches on the south and 3 notches on the east side, and reset same, as I found it.

I move temp. $\frac{1}{4}$ sec. cor., $95\frac{1}{2}$ links north, then east $1\frac{1}{4}$ links and set a smooth boulder, $12 \times 10 \times 9$ ins. 12 ins. in ground for $\frac{1}{4}$ sec. cor., mkd. $\frac{1}{4}$ on west face, on a gentle N. W. slope.

East on a random line bet sec. 2 & 11 va. 228

15 40 Ravine, course N. - Ascend. 50'

20 14 Cor. fences, N. & W.

22 00 Summit. Descend.

25 85 Ravine, course N. - Ascend. 40'

40 00 Set temp. $\frac{1}{4}$ sec. cor., Find no traces of original sec. cor.

40 54 Fence runs S.

44 32 Ravine, course N.

60 00 Set temp. to sec. cor., near E. brow of bluff.

67 00 Foot of bluff.

71 80 Irregular ditch, 8 lks. wide, runs N. W.

80 10 Int. N. & S. line, 17 links South of cor. to sec. 1, 2, 11 & 12, (Hickland cor.)

I move temp. $\frac{1}{4}$ sec. cor., East 20 links, then north $8\frac{1}{2}$ links, and set a smooth boulder, $18 \times 9 \times 5$ ins. 16 ins. in ground, for $\frac{1}{4}$ sec. cor., mkd. $\frac{1}{4}$ on N. side, on N. E. slope.

I move temp. to sec. cor., on E. $\frac{1}{2}$ of line, bet. sec. 2 & 11, East 30 lks. then north $12\frac{3}{4}$ lks., and set a smooth boulder, $9 \times 4 \times 3$ ins., mkd. + on top, set 9 ins. deep on E. brow of hill.

I run from $\frac{1}{4}$ sec. cor. on N. body sec. 11 to $\frac{1}{4}$ sec. cor. on S. body of sec. 11, measured 82.46 chs. on true line. The true line E & W through center sec. 11, measured 74.20 chs. - At the intersection of these center sec. lines, I set a smooth basalt stone $14 \times 8 \times 6$ ins. for center cor. to sec. 11, mkd. C. S. 11 on N.

PLAT AND RECORD OF SURVEY No. 36.19

Course Degrees Minutes Chains Links

face, set 14 ins. ground on gentle N.E. slope, and raised stone mound over stone.

On true E. & W. center line, and midway bet. center cor. and the 1/4 sec. cor. on E. bdy, sec. 11, I set a smooth stone, 12 x 8 x 3 ins. 12 ins. in ground, for 1/4 sec. cor. on E. 1/2 of E. & W. center sec. 11, on gentle N.E. slope.

Survey commenced Oct. 23^d. and ended Oct. 27th 1888.

Jno. C. Arnold, Co. S.

Plat of Secs 11 & 12

T. 5 N. R. 35 E.

Explanations.

Scale 80 chs. = 3 ins.

Course same as for all maps

of stone corner.

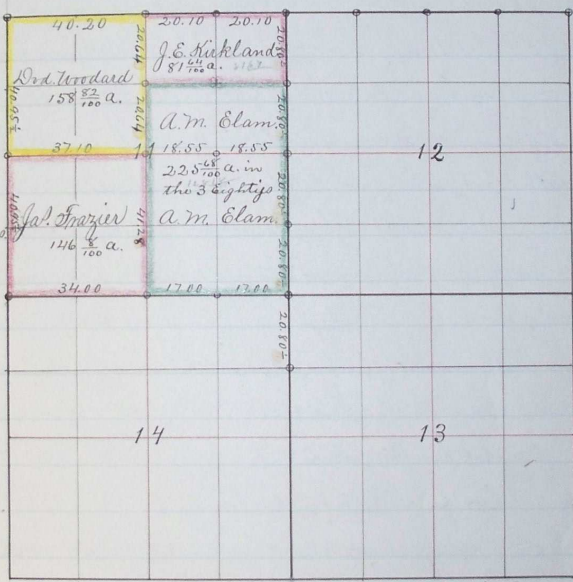

Jno. C. Arnold, Co. Surveyor.

Corrected line bet. secs. 11 & 12 T. 5 N. R. 35 E., also corners corrected.

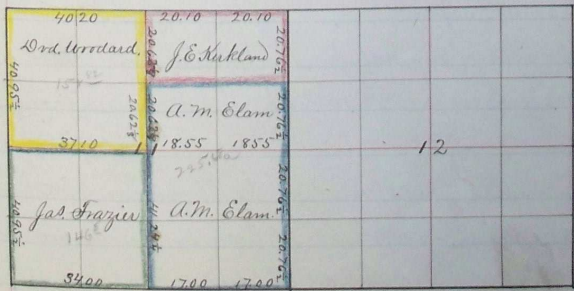

Jno. C. Arnold, Co. Surveyor.