

PLAT AND RECORD OF SURVEY No. 89.11

A. L. Swaynt April 3rd 1897
 T. 4. N. 16. 35. E. 11. 716 Sec 6 97

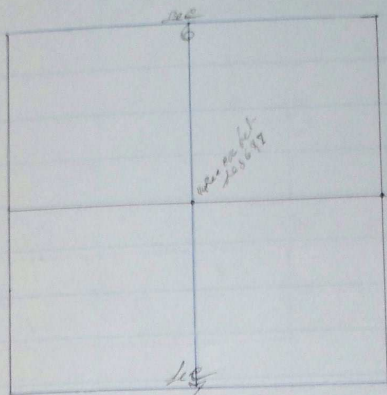

I commenced at the corner to Sec 5-6-7-88 which is a stone corner
 W on the west side of point of old cottonwood the original
 line west on random line bet Sec 6 97

Var 28° 15' W

1 35 Spring branch runs North

40 25 Intersect 25 lbs north of a point which is said by J. W. Tompkins as witness
 from the fact that he helped W. F. Mallock build the fence 2 rods south
 of Old State mound & lots which fence runs E & W and Hill
 stands I therefore set stone 20' x 6" at point as designated
 to perpendicular to corner.

John W. Tompkins County Surveyor
 Assisted by S. W. Bush and A. L. Swaynt
 Town Chairman and A. L. Swaynt Mayor
 J. A. Howard & C. K. Wade

I commenced at the N.E. cor Sec 1 there west on
 random line bet Sec 1 & 12 over 21° 15' E

10 00 Set Tompkins 1/32 cor

20 26 The 1/16 cor there east on true line

10 18 Set Stone for 1/32 come from the 1/4 sec cor on East by Sec 1
 there west on random line through center 6th Sec 1

40 54 The center Sec 6 East on true line

20 27 Set Stone for 1/16 cor

30 41 Set Stone for 1/32 corner. John W. Tompkins County Surveyor
 assisted by J. H. Hutchinson and Jas. Brink Chairman
 Gary Tompkins Mayor

