

Roman Hassell

T 4 N R 36 E N 71 W

July 1st 1897

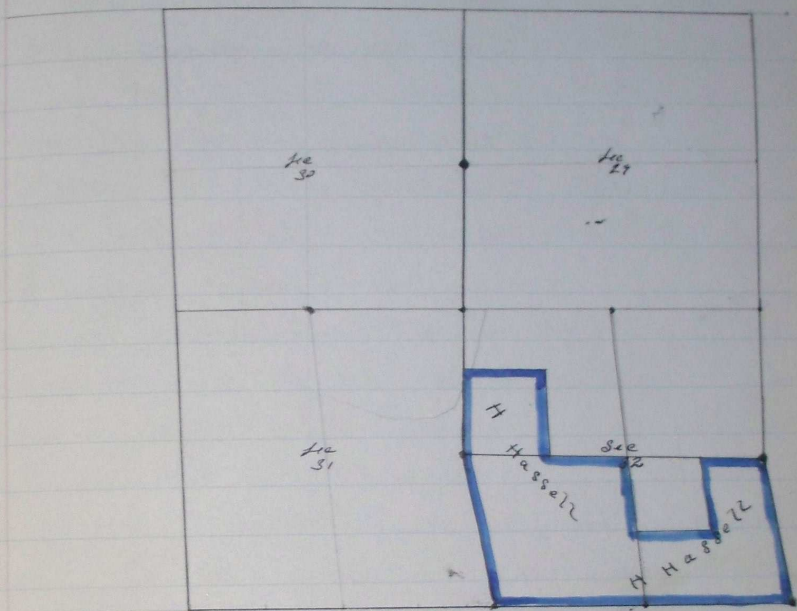

I commenced at the corner to Sec 31 & 32 on township line between T 3 & 4 N R 36 E 100m which is the original corner as described in Government Field Notes. Thence run North on random line $\text{Var } 21^\circ \text{ E}$ descend steep hillside 18 50 cross line or it was crest -
 40 00 could find no $\frac{1}{4}$ Sec corner
 56 00 bearing course S E
 73 76 to Rail Fence course S 8 W as there is no indication of the corner in vicinity I set stake at intersection of fence and proceed to the $\frac{1}{4}$ Sec corner bet Sec 29 & 30 and run North on random line bet Sec 29 & 30 and at 38 50 chains I placed same fence running S 8 W 754.160 crest of North end of First line run North from corner to Sec 31 & 32. This being very unsatisfactory I proceed to the $\frac{1}{4}$ Sec corner bet Sec 30 & 31 and run East on random

Course.	Degree.	Minutes.	Chains.	Links.
---------	---------	----------	---------	--------

line between Sec 30 & 31

2 50 Carine course NW

40 50 Could find no indication of cor to Sec 29-30-31 & 32
I extend this line East and at

46 32 Intersect line run North bet Sec 29 & 30 22nd link
of Stake bet at 3850 chs., and at

54 16 Intersect Stake bet at North end of First line
run from corner to Sec 31 & 32 at 7376 chs.

81 34 Intersect 154 lks South of the original 1/4 Sec. corner
bet Sec 29 & 32 which has been fairly well preserved
from this 1/4 Sec corner I extend line East
bet Sec 29 & 32 and 28 & 33

6 75 Carine course SW

16 75 Barnie course NW

40 70 Intersect 32 lks North of gate said to be corner
to Sec 28-29-32 & 33

Then East bet Sec 28 & 33

40 45 The 1/4 Sec cor bet Sec 28 & 33 as described in
Government Field Notes.

I also retraced the line from the 1/4 Sec corner
bet Sec 28 & 29 North to the point at Gate said
by old settlers to be the corner to Sec 28-29-32 & 33
and find the distance to be 4050 chains

and that from said gate at corner to Sec 28-29-32 & 33

39 83 I find the old 1/4 Sec corner which is old this corner
about 75 lks West of Carine as indicated and
described by old settlers from this corner
N 14° 30' E between Sec 32 & 33

1 15 Carine South

11 42 Top of rock cliff 20 feet high

12 00 Carine runs S W

38 68

Witnessed 55 lbs East of the original corner to Sec 4-6-32 1833 on Spruce as described in U.S. Field notes
~~As~~ I cannot find any person that has ever saw the corner to Sec 29-30-31 1832, but it is said that Wm Kilgore at one time owned the N 8 1/4 Sec 31 I said for him and on the 8th day of July he years on the ground and says he will have nothing to say as to the corner to Sec 29-30-31 1832 which was his N 6 corner when he owned the N 8 1/4 Sec 31 but that he could show me the 1/4 Sec corner bet Sec 31 1832 as he had saw it - and noted locality so I administered to him the following oath

I Wm Kilgore first being duly sworn depose and say that the evidence to be given as regards the original locality of the 1/4 Sec. corner between Sec 31 1832 - in Township 4 North Range 36 East Will. Mer. Oregon shall be true to the best of my knowledge and belief
 Signed Wm Kilgore

Subscribed and sworn to before me this the 8th day of July 1877
 John W. Kimbell County Surveyor
 Present Beay Kimbell and L. M. Smith Chairman and John Lee Ferguson and G. Russell owner of land in Sec 30
 after which we proceed to the place indicated by Wm Kilgore where we find logs and the ground a stone marked 1/4 and pointed out by said Kilgore as at or very near place which he had saw it - years before, this point being or nearly in conformity with the line ^{at corner} North and East as I had found them I accept the point and set the stone in the ground and built a stone mound around it - and run north bet Sec 31 1832

38 24 to a point Equal distant bet 1/4 Sec cor between Sec 29 1832 and 30 1831 as per U.S. Field Notes also - Equidistant -

Course	Degrees	Minutes	Chains	Links
--------	---------	---------	--------	-------

between the 1/4 Sec corner as pointed out by Higgins
 lot No 31132 and the government 1/4 Sec corner
 lot No 29830 as I found it - and in all
 in accordance with Rules and regulations
 as to Reestablishing lost and obliterated
 Corner and the manual of Instructions from
 the General Land Office at Washington D.C.
 From this 1/4 Sec corner as lot No 31132
 the course to the corner to lot No 5-6-31132 on
 the Township line lot No 384 N 6366 is
 S14°30' E 3788 chains

I Commence at the 1/4 Sec corner lot No 29832

Then South on random line through corner No 32

- 9 50 course was S.W.
- 20 10 lot boundary 1/4 corner
- 50 50 lot boundary 1/4 corner
- 00 57 W to 1/4 Sec 1/4 corner
- 69 50 line - Crest into Crest
- 77 08 Intersect - 143.40 north of the 1/4 Sec corner on lot
 boundary No 32 as described in U.S. Field notes
 Thence N 6° W on true line through No 32
- 77 54 The 1/4 Sec corner lot No 29832

Commencing at the 1/4 Sec corner lot No 31132 as lot

Then East on random line through No 32

- 14 53 course true
- 20 50 lot boundary 1/4 corner
- 40 00 lot boundary 1/4 corner
- 44 45 Intersect same N 8° E line through corner No 32
- 60 57 lot boundary 1/4 corner
- 77 45 Intersect - 153.40 north of the 1/4 Sec corner as lot No 32 N 8° W
 Thence N 89° 5' W on true line through No 32

PLAT AND RECORD OF SURVEY No. 7119

Deeds	Degrees	Minutes	Chains	Links	
	15	41			Set Stake for 116 acre
	30	81			Set Stone 32 + 10 + 6 for 116 acre in mid of Stone
	55	13			Set Stone 24 + 10 + 6 for 116 acre
	79	45			The 1/4 Sec were set Sec 31 & 32 these north set Sec 31 & 32
	19	12			Set Stone in middle of Stone for 116 acre these East through center NW 1/4 Sec 32 on true line
	22	20			Set Stone 22 + 6 + 6 in mid of Stone for center NW 1/4 Sec 32
	44	52			The 1/4 acre in center N 1/2 Sec 32 I commenced at the 1/4 Sec acre set Sec 32 & 33 these S 14° 30' 6" on true line
	19	34			Set Stone in mid of Stone for 116 acre these west on true line
	17	71			Set Stone 24 + 10 + 4 for 116 acre
	35	41			Set Stone 20 + 11 + 6 for 116 acre in center S 1/2 Sec 32

John W. Kimbrell, County Surveyor
 assisted by Gray Kimbrell of W. Brasfield & Hartley and
 L. M. Smith, sworn chorismen and John Baker sworn Flagman

Surveyed for A. T. Bunnick and Mrs. J. B. Adams
 Commencing at a point S 6° 20' W 553 feet dist from the SW cor. of Bk. 33
 of the Town of Adams thence S 25° 30' W 205 ¹⁰⁰/₁₀₀ feet
 thence S 60° 30' E 227 feet thence N 80° 30' E 206 ¹⁰⁰/₁₀₀ feet thence N 50° 30' W 177 feet
 to place of beginning John W. Kimbrell County Surveyor