

PLAT AND RECORD OF SURVEY No. 111

Geo Geo Reendschmidt

Oct 3rd 1899

Tp 4 N R 35 E W 1/4 Sec 25

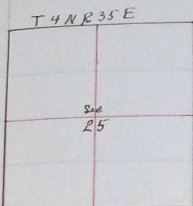

- I Commenced at the S E corner of Tp 4 N R 35 E and ran
 North on blank line on E side Sec 36 True $11^{\circ} W$
- 16 00 $1000 20^{\circ} 35' E$
 - 39 75 Intersect 62 lks W of $\frac{1}{4}$ Sec cor point
 - 80 00 Intersect 205 lks W of old course of Secs 30-31-25 & 36
 Which is a stone under ³ ~~old~~ ^{back} fence which runs South a direct
 from this cor. I ran North bet Secs 25 & 30
 - 40 00 a point 61 lks W of old $\frac{1}{4}$ Sec cor
 - From this $\frac{1}{4}$ Sec cor I ran S $52^{\circ} W$ on true line
 - 20 00 Set Stake 20 x 8 x 6 for $\frac{1}{16}$ cor
 - S $89^{\circ} 51' W$ through center Sec 25
 - 81 65 Intersect 10 lks South of $\frac{1}{4}$ Sec cor bet Secs 25 & 26
 - From the cor to Sec 25-26-35 & 36 I ran East bet Secs 25 & 36
 - 20 00 Set Stake $\frac{1}{16}$ cor
 - 40 00 Set " $\frac{1}{4}$ Sec cor
 - 81 95 Intersect 118 lks South of cor Secs 25-30-31 and 36
 - Thence I ran S $89^{\circ} 9' W$ on true line
 - 20 48 Set Post for $\frac{1}{16}$ cor
 - 40 99 " Stone for $\frac{1}{4}$ Sec cor
 - 61 44 Set Stone for $\frac{1}{16}$ cor
 - South through Sec 25
 - 79 45 Intersect 26 lks East of $\frac{1}{4}$ Sec cor.

John W. Tombell County Surveyor
 A. L. Doyles and Marion Dixon Chairman
 Geo. Reendschmidt Flagman