

I commenced at the  $\frac{1}{4}$  Sec corner bet Sec 31 & 32  
 thence west through the center Sec 31  
 Var  $20^{\circ} 10' E$

- 20 00 Set temporary  $\frac{1}{16}$  corner for center  $E \frac{1}{2}$  Sec 31
- 40 00 Set temporary  $\frac{1}{16}$  corner for center Sec 31
- 60 00 Set temporary  $\frac{1}{16}$  corner for center  $W \frac{1}{2}$  Sec 31
- 78 03 Intersect West Boundary of  $\frac{1}{4}$  Sec 31 & 32

of the  $\frac{1}{4}$  Sec corner bet Sec 31 & 32  
 which is in center of County Road E & W  
 Post decayed I re-establish it by  
 planting below the surface an old  
 Cast Iron cog wheel 15 inches diameter  
 with Edge upwards facing E & W

J. W. Kimbrell  
 County Surveyor

Surveyed for P. M. Coffin June 4<sup>th</sup> 1890  
 by J. W. Kimbrell county surveyor Plat No. 114  
 one July 29 1891 Private Survey

I commenced at the  $\frac{1}{4}$  Sec corner bet Sec 2-3-34 & 35  
 thence South bet Sec 2 & 3  
 Var  $20^{\circ} E$

- 19 80 Set temporary  $\frac{1}{16}$  corner
- 40 07 Intersect  $\frac{1}{4}$  Sec East  
 of the  $\frac{1}{4}$  Sec corner  
 bet Sec 2 & 3  
 which is a mound  
 bet the original corner  
 thence  $N 1^{\circ} E$  on  
 true line

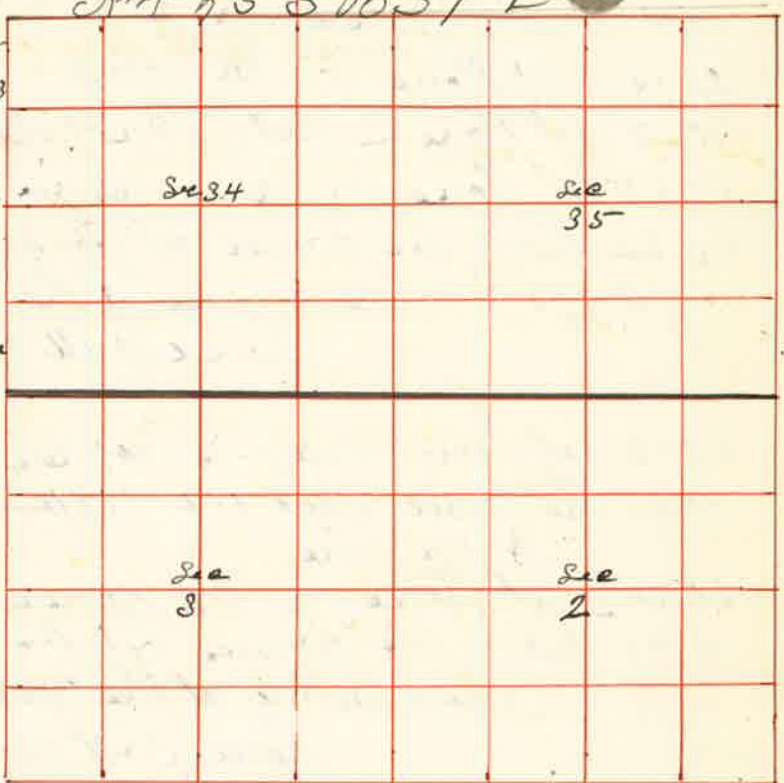

- 20 14 Set Post for  $\frac{1}{16}$  corner
- 40 07 the corner  
 the  $\frac{1}{4}$  Sec corner  
 bet Sec 2 & 3  
 thence South bet  
 Sec 2 & 3 var  $20^{\circ} E$

- 20 00 Set temporary  $\frac{1}{16}$  corner
- 40 00 Intersect - 92 lks West of the corner to Sec 2-3-10 & 11  
 thence I ran  $N 1^{\circ} 19' W$  on true line
- 20 00 Set Post in mound of stone for  $\frac{1}{16}$  corner
- 4 03 the  $\frac{1}{4}$  Sec corner bet Sec 2 & 3  
 thence East through center Sec 2  
 Var  $20^{\circ} 30' E$

- 40 00 Set temporary  $\frac{1}{16}$  corner for center Sec 2
- 60 00 Set temporary  $\frac{1}{16}$  corner for center  $E \frac{1}{2}$  Sec 2
- 81 28 Intersect - 85 lks South of the  $\frac{1}{4}$  Sec corner bet Sec 1 & 2  
 I therefore find the true course of this center  
 E & W line to be  $S 89^{\circ} 4' W$  and  $N 89^{\circ} 4' E$   
 I then commence at the  $\frac{1}{4}$  Sec corner on N. 1/2 Sec 2  
 and run South through center Sec 2  
 Var  $20^{\circ} E$

- 20 00 Set temporary  $\frac{1}{16}$  corner for center  $N \frac{1}{2}$  Sec 2
- 39 85 Intersect true E & W line 85 lks West of the first stake  
 at this point

- 5985 Set temporary 1/16 corner for center 8 1/2 Sec 2
- 8022 Intersect - 293 lks West of the 1/4 Sec corner bet Sec 2 & 11  
Thence N 2° 5' W on line line
- 20136 Set Stone for 1/16 corner in center 8 1/2 Sec 2
- 4027 Set Stone in mid of Stone for 1/16 corner in center Sec 2
- 6027 Set Stone for 1/16 corner in center N 1/2 Sec 2
- 8022 The 1/4 Sec corner bet Sec 2 & 35 - on line  
I commenced at the 1/4 Sec corner bet Sec 1 & 2  
Thence South bet Sec 1 & 2  
Var 20° E
- 2000 Set temporary 1/16 corner
- 4045 The corner to Sec 1-2-11 & 12  
N on line
- 20221/2 Set Stone for 1/16 corner
- 4045 The 1/4 Sec corner bet Sec 1 & 2  
I commenced at the corner to Sec 2-3-34 & 35 -  
Thence East on line  
Var 20° E
- 2000 Set temporary 1/16 corner
- 4024 Intersect 24 lks North of the 1/4 Sec E  
Thence N 89° 48' W on line line
- 2012 Set Stone for 1/16 corner
- 4024 The corner to Sec 2-3-34 & 35 -  
I commenced at the 1/16 corner on West boundary  
NW 1/4 Sec 2  
Thence East through center NW 1/4 Sec 2  
Var 20° E
- 2000 Set temporary 1/16 corner for center NW 1/4 Sec 2
- 4044 The 1/16 corner in center N 1/2 Sec 2  
West
- 2022 Set Post for 1/16 corner for center NW 1/4 Sec 2
- 4044 The 1/16 corner on NW 1/4 Sec NW 1/4 Sec 2  
I commenced at the corner to Sec 2-3-34 & 35.  
Thence N 1° 30' E bet Sec 34 & 35  
Var 20° E
- 2000 Set temporary 1/16 corner
- 4105 The 1/4 Sec corner bet Sec 34 & 35

- from which I run S 1° 30' E on line
- 20524 Set Stone in mound of Stone for 1/16 corner
- 4105 The corner to Sec 2-3-34 & 35 -  
I commenced at the 1/16 corner bet Sec 34 & 35 -  
Thence West through center Sec 34  
Var 20° E
- 2000 Set temporary 1/16 corner for center E 1/2 Sec 34
- 4000 Set temporary 1/16 corner for center Sec 34
- 6000 Set temporary 1/16 corner for center W 1/2 Sec 34
- 8275 The 1/4 Sec corner bet Sec 33 & 34  
from which  
a pine N.E.  
a pine S.W.  
Thence East on line
- 2026 Set Stone for 1/16 corner in center W 1/2 Sec 34
- 4052 Intersect True N & S line bet Post in mid of Stone  
for center Sec 34
- 8275 The 1/4 Sec corner bet Sec 34 & 35 -  
I commenced at the 1/4 Sec corner bet Sec 33 & 34  
Thence North through center Sec 34  
Var 20° E
- 2000 Set temporary 1/16 corner.
- 4095 Intersect True S & W line 165 lks West of 1<sup>st</sup> Stake for center
- 7977 Intersect 114 lks West of the 1/4 Sec corner bet Sec 27 & 34  
Thence S 0 49' W on True line through center Sec 34
- 3882 The center Sec 34
- 6019 Set Post for 1/16 corner in center S 1/2 Sec 34
- 7977 The 1/4 Sec corner bet Sec 2 & 34  
I commenced at the 1/4 Sec corner bet Sec 2 & 11  
Thence East bet Sec 2 & 11  
Var 20° 30' E
- 2000 Set temporary 1/16 corner
- 3750 Intersect 9 lks South of the corner to Sec 1-2-11 & 12  
Thence S 89° 52' W on line line
- 1875 Set Stone for 1/16 corner
- 3750 The 1/4 Sec corner bet Sec 2 & 11

I commenced at the corner to Sec 1-2-11 & 12  
thence East bet Sec 1 & 12  
Var 20° E

20 00 set Stone for 1/16 corner for South Boundary S 8 1/4  
thence South set Stone for 1/16 corner for center NW 1/4  
I commenced at the corner to Sec 1-2-11 & 12  
thence South bet Sec 11 & 12  
Var 20° E

20 00 set temporary 1/16 corner  
40 20 intersect 50 lbs west of the 1/4 Sec corner bet Sec 11 & 12  
from which I run N 40° W on true line

20 10 set Stone in Mid. of Stone for 1/16 corner  
40 20 the corner to Sec 1-2-11 & 12

J.W. Kimball county surveyor

Survey completed July the 26<sup>th</sup> 1891

I commenced at the 1/4 Sec corner bet Sec 34 & 35 -  
thence North bet Sec 34 & 35 -  
Var 21° 30' E

9 00 Rock cliff 10 feet high course NW 1/4 S E  
13 55 Rocky cliff 15 feet high descend.

20 00 set Stone in Mid. of Stone for 1/16 corner  
40 00 the corner to Sec 26-27-34 & 35

I commenced at the 1/4 Sec corner bet Sec 27 & 34  
which is original Post in Mid. of Stone  
from which

a Spring bears S 41° W 1400 lbs dist -  
from this corner I run East bet Sec 27 & 34

18 85 top of bluff 40 feet high N 1/4 S descend  
20 00 set Stone in Mid. of Stone for 1/16 corner  
40 00 the corner to Sec 26-27-34 & 35 -  
from which I run west

20 00 to 1/16 corner on N 1/4 NE 1/4 Sec 34  
thence South through NE 1/4 Sec 34

6 50 top of high ridge S W 1/4 S E  
20 00 set Stone for 1/16 corner in center N E 1/4 Sec 34

J.W. Kimball Private Surveyor

by J.W. Kimball county Surveyor Plat No. 115

I commenced at the J. S. R. H. O. E.

1/4 Sec corner between  
Sec 5 & 6  
thence East through  
center Sec 5  
Var 20° E



15 00 Var 18° E  
18 00 Var 22° 30' E  
20 00 set temporary 1/16 corner  
Var 22° E

24 00 var 19° 15' E  
25 50 var 17° 15' E  
30 30 fence S 1° 28' E  
top of hill

31 00 descend very steep hillside  
40 00 set temporary 1/16 corner  
80 40 intersect 55 lbs south  
of the 1/4 Sec corner

bet Sec 4 & 5  
thence S 89° 45' W on true line

40 57 true center Sec 5  
from which I mark  
a Pine 3 ins dia bet S 61° E 1 1/2 lbs dist

80 40 the 1/4 Sec corner bet Sec 5 & 6  
I commenced at the 1/4 Sec corner bet Sec 5 & 8  
~~thence North through center Sec 5~~  
from which

a Pine 5 ins dia bet S 8 1/2° E 38 lbs dist  
a Pine 5 " " " N 4° W 33 " "  
thence I run North through center Sec 5  
Var 20° E

20 00 set temporary 1/16 corner  
39 45 intersect 17 lbs west of first stake set on E & W line

80 22 intersect at the 1/4 Sec corner bet Sec 5 & 8  
thence South on line through center Sec 5

19 34 set Post for 1/16 corner for center N 1/4 Sec 6 -  
from which  
a Pine 8 ins dia bet N 89° W 28 lbs dist