

Field Note of the Subdivision of Sec 22 & 23 Twp 2 S, R 33 E

for Chrisman & Spains by J.W. Kimbrell Dep't. Co Survey Nov. 5/1887

I started at 1/4 Sec corner on East Side of Sec 23 thence west at 40 chains set stake for temporary center of Sec 23 at 60 chains set stake for 1/6 corner at 8036 chains the 1/4 Sec corner between Sec 22 & 23 thence west through Sec 22 at 20 chains set post 1/6 corner at 40 chains set stake for temporary center. I extend the line by alignment but did not chain the balance of the line and missed the 1/4 Sec corner 5 links on the south. Note this corner I found the day before by digging up the soil and found the point of the stake. it was considered lost as none of the settlers had ever seen it. Also the Sec corner to Sec 13-14-28 & 24

Some of the settlers thought there never was a corner put there by the U.S. Deputy but the point of the original stake chased was about 8 inches under the grasses sod and base bushes.

The 1/4 Sec corner on South Side of Sec 22 from which I run North on 20° E at 20 chains set stake for 1/6 corner at 40 chains set stake for temporary center at 60 chains set stake for temporary 1/6 corner at 8045 chains the 1/4 Sec corner on North Side of Sec 22 from which I run South and at 2011 chains set stake for 1/6 corner at 4023 Planted stake for center of Sec 22 at 6034 chains set stake for 1/6 corner and afterwards planted a stone from which I run East and at 2011 chains I planted a stone for 1/6 corner thence North 2015 chains and planted a stone for 1/6 corner and at 4030 chains planted a stone for 1/6 corner. Note I run some of these subdivisional lines by alignment as the corner was in sight of each other. The 1/4 Sec corner on North Side of Sec 23 from which I run South at 20 chains set stake for 1/6 corner at 40 chains set stake for temporary center and at 8050 chains the 1/4 Sec corner on South Side of Sec 23 thence I started at 1/2 corner on South Side of S.W. 1/4 Sec 23 from which I run North and at 4036 chains set stake for 1/6 corner and at 6054 chains set a stone for 1/6 corner

J.W. Kimbrell Dep't Co Surveyor

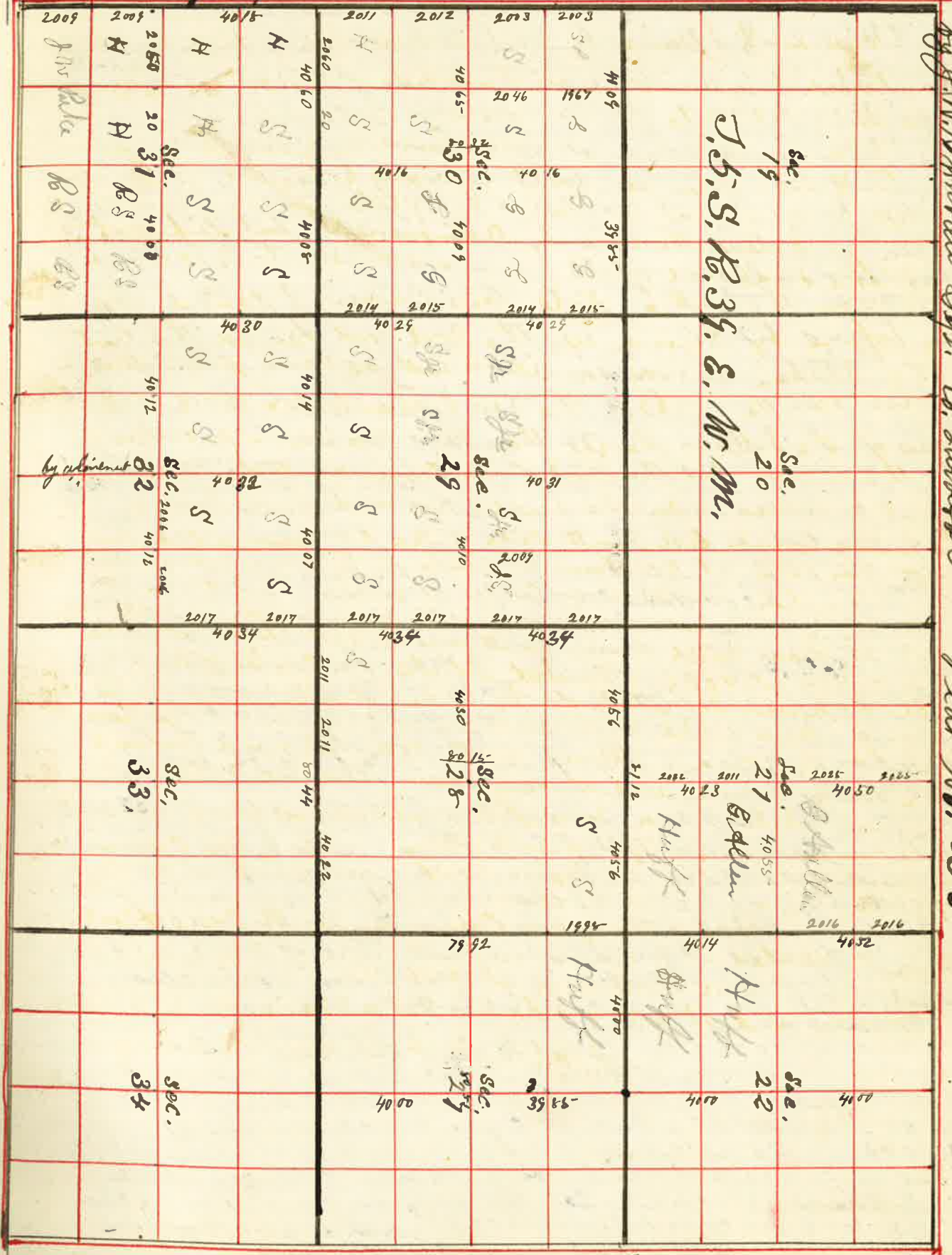

by J.W. Kimbrell Dep't. Co Surveyor

Plat No. 22

Field Notes on Next Page

Field Notes of Subdivisions of Sec. 21=22=27=28=29=30=31 & 32

J.S. R. 33, E. W. M., by J.W. Kimbrell Supt. Co. Surveyors on Nov. 11-12-13-14 1815/1867

I started at the 1/4 Sec corner between Sec 31 & 32 from which I run North and at 6079 chains set stakes on random line and at 12079 chains the Sec corner to Sec 19=20=29 & 30 at which point I had an excess of 79 links. I therefore run South var 20° E, and at 2015 chains set Post for 1/8 corner and at 4029 chains set Post and built mound for 1/4 Sec corner between Sec 29 & 30 and at 6044 chains set Post for 1/8 corner and at 8059 chains planted Post in north side of creek for Sec corner. I then started at Sec corner to Sec 19=20=29 & 30 thence West 3985 chains to 1/4 Sec corner on north side of Sec 30 thence South through Sec 30 setting Random stakes at every 20 chains and at 8032 chains the 1/4 Sec corner on south side of Sec 30. from which I run East at 40 chains set stake at 8023 chains the 1/4 Sec corner between Sec 29 & 30 from which I run West and 4012 chains the Sec corner to Sec 29=30=31 & 32. 4008 chains thence I then started at the 1/4 Sec corner between Sec 29 & 30 thence West through Sec 30 at 40 chains set stake for center at 60 chains set Random stake for 1/8 corner at 8074 chains the 1/4 Sec corner on west side of Sec 30. thence North at 20 chains set Random stake for 1/8 corner at 4006 chains the Sec corner to Sec 19=30=24 & 25. Thence East at 20 chains set stake at 4102 chains the 1/4 Sec corner. I therefore run West and at 2019 chains set Post and built mound of Stone for 1/8 corner thence South 1967 chains and set Post built mound of Stone for 1/8 corner and at 4013 ch set Post in mound of Stone for 1/8 corner. I then started at 1/4 Sec corner on west side of Sec 30 thence South at 40 chains set stake at 4022 Sec corner to Sec 30=31=25 & 36 from which I run North and at 2011 chains set Post for 1/8 corner the N.W. corner of Sec 31 from which I run South at 20 chains set Random stake and at 40 chains set Random stake at 60 chains set Random stake at 8036 chains the S.W. corner of Sec 31 from which I run North on June line and at 2009 chains set stake for 1/8 corner and at 4018 chains set Post for 1/4 Sec corner between Sec 31 & 32 and at 6027 chains set Post for 1/8 corner. I then started at 1/4 Sec corner on west side of Sec 31 thence East at 40 chains set stake for center and at 8050 chains the 1/4 Sec corner between Sec 31 and 32. I started at 1/4 Sec corner on north side of Sec 32 thence South through center at 4032 chains the center thence South by agreement of 1/4 Sec corner on south side of Sec 32. I started at 1/4 Sec corner between Sec 30 & 31 thence West at 40 chains set stake at 4060 chains the N.W. corner Sec 31, from which I run East at 2060 chains set stake in mound of Stone at 4060 the 1/4 Sec corner thence South at 4013 chains the center of Sec 31 from which I run North on June line and at 2006 chains set stake for 1/8 corner thence West 20 chains planted Post for 1/8 corner in center of N.W. 1/4 Sec 31. I started at 1/4 Sec corner between Sec 31 & 32 thence East at 40 chains the center at 60 chains set Post at 8024 the 1/4 Sec corner between Sec 32 & 33 thence West 2006 chains set Post for 1/8 corner. I then started at the 1/4 Sec corner between Sec 32 & 33 thence North var 20° 30' E and set a stake at 6079 20 chains and at 12104 chains the Sec corner to Sec 20=21=28 & 29 at which point I had an excess of 104 links on the 1/2 mile. I therefore run South and at 2017 chains set Post for 1/8 corner and at 4034 chains set Post for 1/4 Sec corner between Sec 28 & 29 and at 6051 chains set Post for 1/8 corner and at 8068 Grove Stake for Sec corner to Sec 28=29=32 & 33 thence South 2017 set Post for 1/8 corner thence West 2007 chains and set Post for 1/8 corner in center of N.E. 1/4 Sec 32.

Field Notes of Subdivisions of Sec 21=22=27=28=29=30=31 & 32, E. W. M., by J.W. Kimbrell Supt. Co. Surveyors

I started at Sec corner to Sec 28=29=32 & 33 thence West at 20 chains set stake for 1/8 corner at 4007 chains the 1/4 Sec corner to Sec 29 & 32 from which I run East at 2003 chains set Post for 1/8 corner. I started at 1/4 Sec corner between Sec 29 & 32 from which I run South and at 4032 chains I raised center stake on first line E & W with the Sec 32. I then started at 1/4 Sec corner between Sec 29 & 32 thence North through center of Sec 29 to center from which I chained at 20 chains set stake and at 4031 chains I raised West 1500 feet 33 links East of corner from which I then run South 822 June line and at 2015 chains set Post for 1/8 corner. I then started in center of Sec 29 thence East East and at 4010 chains the 1/4 Sec corner from which I run West and at 2005 chains set Post for 1/8 corner from which I run North and at 2009 chains set Post for 1/8 corner in center of N.E. 1/4 Sec 29. I then started at N.W. corner Sec 28 thence East at 40 chains set stake for temporary 1/4 Sec corner at 8112 chains the Sec corner to Sec 21=22=27 & 28 from which I run West and at 4056 chains planted Post for 1/4 Sec corner between Sec 21 & 28. I started at Sec corner to built mound and dug pits N & S, South of Post. I started at Sec corner to Sec 21=22=27 & 28 thence North at 20 chains set stake and at 2007 chains corner between Sec 21 & 22 from which I run South the 1/4 Sec corner between Sec 21 & 22 from which I run West at 4055 chains the center of Sec 21, set Post for 1/8 Sec corner built mound of Stone the center of Sec 21, Sec 21 & 22 from which I run West at 4055 chains thence North at 20 chains I then started at the 1/4 Sec corner between Sec 21 & 22 from which I run South and at set stake at 4023 chains the center at 6023 chains set Post for 1/8 corner and at 4050 the 1/4 Sec corner on North side of Sec 21 from which I run South for 1/8 corner drove 2025 chains Grove Stake and built mound of Stone for 1/8 corner between chains planted Post for center of Sec 21 and at 6061 chains Grove Stake and built mound for 1/8 corner. I started at 1/4 Sec corner between Sec 21 & 28 thence South at 20 chains set stake the 1/4 Sec corner between Sec 21 & 28. I started at S.W. corner of Sec 28 thence East at 20 chains set stake at 40 chains set stake for temporary 1/4 Sec corner and at 8044 chains the S.E. corner of Sec 28 from which I run West and at 4022 chains set stake for 1/4 Sec corner between Sec 28 & 33 and at 6033 chains corner planted Post for 1/4 Sec corner between Sec 28 thence North at set stake for 1/8 corner. I started at S.E. corner of Sec 28 thence North at 40 chains set stake for temporary 1/4 Sec corner to Sec 21=22=27 & 28 40 chains set stake for temporary 1/4 Sec corner to Sec 21=22=27 & 28 temporary 1/8 corner, at 7992 chains set Post for 1/8 corner, from which I run South and at 1998 chains set temporary 1/8 corner at I started in center of Sec 28 thence West at 20 chains set temporary 1/8 corner at 4036 ch the 1/4 Sec corner on west side of Sec 28 from which I run East 2018 chains thence South 2015 chains Grove Stake built mound for 1/8 corner in center of S.W. 1/4 Sec 28. Thence West 2014 chains to 1/8 corner. I started at 1/4 Sec corner between Sec 27 & 28 thence East at 40 chains set stake at 8051 chains the 1/4 Sec corner between Sec 26 & 27. I started at 1/4 Sec corner between Sec 21 & 22 thence North at 20 chains set Post at 4032 the Sec corner to Sec 15=16=21 & 22 from which I run South at 2016 chains planted Stone for 1/8 corner. I started at 1/4 Sec corner between Sec 15 & 22 thence South at 40 chains built mound of Stone for center of Sec 22 at 80 chains the 1/4 Sec corner between Sec 22 & 27 thence South at 20 chains set stake for 1/8 corner temporary and at 3985 chains the center of Sec 27 at 40 chains further on South the 1/4 Sec corner between Sec 27 & 34 from which I run North on June line and at 5932 chains planted Stake built mound dug pits & C for 1/8 corner.

J.W. Kimbrell Supt. Co. Surveyors