

Surveyed for the Mrs. A. J. French Estate Per. L. B. Holmes Sept. 8 1888

By J. W. Kimbrell County Surveyor Plat No. 48

I Commenced at  $\frac{1}{4}$  corner on west side of N. W.  $\frac{1}{4}$  Sec. 31 Regularly Established on Guide Meridian. Thence I run North var  $20^{\circ}$  and at 60 chains set stake for temporary  $\frac{1}{4}$  sec corner on west side Sec 30 and at 40 24 chain further on north the corner to Sec 24-25-18830 making an excess of 24 links over U.S. field notes I therefore run South 40 10 chains and notes I therefore run South 40 10 chains and planted a stone 5 x 6 x 17 inches marked  $\frac{1}{4}$  S. on west face for  $\frac{1}{4}$  sec corner between Sec 25 and 30 Thence I run East var  $20^{\circ}$  E at 20 chains set stake for temporary  $\frac{1}{4}$  sec corner at 40 chains set stake for temporary center Sec 30 8 118 chains East Boundary Sec 30 but found no  $\frac{1}{4}$  sec corner. I then proceeded to the N.E. corner Sec 30 and run south and at 80 90 chains I intersect South Boundary of Sec 30 at the S.E. corner I therefore run I north on true line between Sec 29 and 30 and at 40 45 chains set stake established the  $\frac{1}{4}$  sec corner between Sec 29 and 30 set post in mound of stone from which I run west and at 40 58 chains set stone marked C.S. for center Sec 30. J. W. Kimbrell County Surveyor

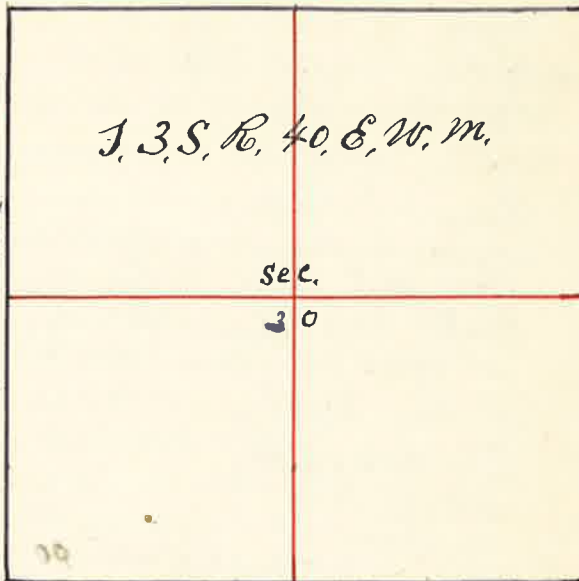

Surveyed for J. L. A. Ritchison & Cameron Sept. the 23<sup>rd</sup> 1888

By J. W. Kimbrell County Surveyor Plat No. 49

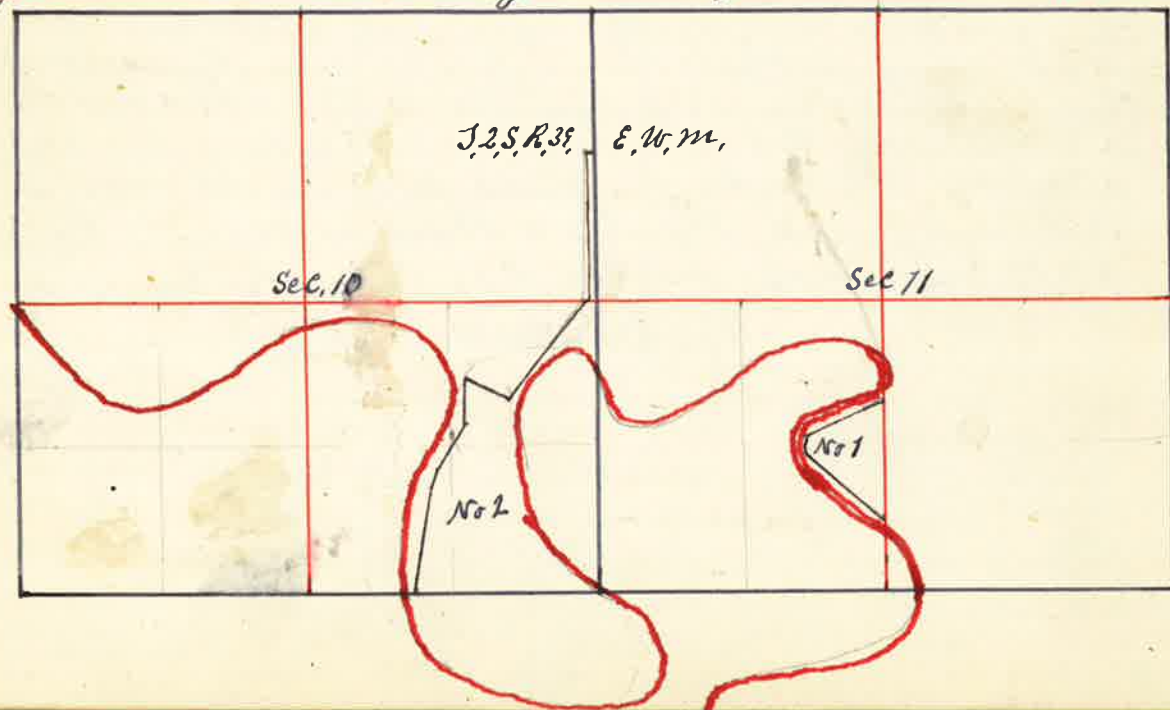

See Plat No. 49 on Page 50 J. L. A. Ritchison & Cameron

I Commenced at corner to Sec 2-3-108 11 Thence East on Random line between Sec 2 and 10 at 40 10 chains found No  $\frac{1}{4}$  sec corner but at 80 60 the corner to Sec 1-2-118 12 from which I run west and at 40 30 chains set stone marked  $\frac{1}{4}$  S for  $\frac{1}{4}$  sec corner between Sec 11 Thence South through center Sec 11 40 00 chains set stake for temporary center Sec 11 46 00 chains offset East 300 links Thence South on offset 8 00 chains and set back west 300 chains on true line Thence South on line 70 40 chains Grand Round River 225 links wide 80 60 chains intersect South Boundary Sec 11 found no  $\frac{1}{4}$  sec corner and set temporary stake. I then started at the S.E. corner Sec 11 Thence west 34 63 chains Grand Round River 152 links wide 40 05 chains intersect first Random stake 78 00 Grand Round River 270 links across this corner to Sec 10-11 14 15 being in the river and no sign of witness corner. I run on west 25 42 chains Grand Round River 195 links wide 40 13 chains no  $\frac{1}{4}$  sec corner 80 26 chains no sec corner Thence west 79 40 chains no corner but at 80 00 chains the corner to Sec 8-9-108 12 making an excess of 60 links or 20 links to each mile over U.S. Field Notes I therefore make the South Boundary Sec 11 80 09 chains and set stone marked  $\frac{1}{4}$  S for  $\frac{1}{4}$  sec corner between Sec 11 & 14 Equidistant between or 40 04 1/2 chains from each sec corner I then started at N.W. corner Sec 11 Thence South 40 chains found no  $\frac{1}{4}$  sec corner and set Random stake for temporary  $\frac{1}{4}$  sec corner 50 62 chains Grand Round River 622 links wide 78 00 chains Grand Round River 245 links wide. Thence South 25 05 chains Grand Round River 200 links wide. 41 10 chains the  $\frac{1}{4}$  sec corner between Sec 14 & 15 making an excess of 110 links in  $\frac{1}{2}$  miles over U.S. field notes I therefore run North var  $20^{\circ}$  E 40 37 chains and planted a stone marked for corner to Sec 10-11-14 & 15 and at 80 73 chains planted stone marked  $\frac{1}{4}$  S for  $\frac{1}{4}$  sec corner between Sec. 10 & 11 Thence west through center Sec 11 and at 40 07 chains the center Sec 11 a stone marked C.S. 80 20 chains  $\frac{1}{4}$  sec corner on west side Sec 11 From this corner I proceeded to survey a Fractional Lot No. 2 as follows to wit North var  $20^{\circ}$  E 20 chains west 50 links South 20 chains Thence S  $36^{\circ} 15' W$  17 61 chains Thence N  $66^{\circ} 15' W$  706 chains to center of Grand Round River Thence S  $20^{\circ} W$  22 rods Thence S  $35^{\circ} W$  34 rods Thence S  $20^{\circ} W$  14 rods Thence South  $10^{\circ} W$  54 rods to South Boundary Sec 10 in center of Grand Round River Thence East on sec line 104 rods to S.E. corner Sec 10 I then established witness corners to Fractional lot in the East side of S.W.  $\frac{1}{4}$  Sec 11 marked No 7 on Plat as follows Meander corner No. 1 52 rods 20 links South of center Sec. 11 on South East side of Grand Round River a stone marked m. 1 from which a willow 3 inches bears N  $28^{\circ} 30' E$  21 lks distant. The true corner is 4 rods North in River Thence S  $55^{\circ} W$  12 rods a stone marked m. 2. S. 2 rods from true corner Thence S  $67^{\circ} W$  37 rods a stone marked m. 3. S.E. 2 rods from true corner Thence S  $2^{\circ} E$  10 rods a stone marked m. 4. N.E. 2 rods from true corner in River Thence S  $50^{\circ} 30' E$  56 rods a stone marked m. 5. North 4 rods from true corner in Grand Round River Thence North 67 rods to meander corner No. 1 J. W. Kimbrell County Surveyor