

Surveyed for J. F. Smith Wm Booth & A. E. Eaton Aug 27 1889

By J. W. Fairbairn County Surveyor Plat No. 89

For the re-estabishment of the corner to Sec 28=29=32 & 33 on 29=30=31 & 32 and 1/4 Sec corners between Sec. 28 & 29=32 & 33=31 & 32=29 & 30 and subdivision of Sec 29 & 32 in T. 2. S. R. 40 E. W. M.

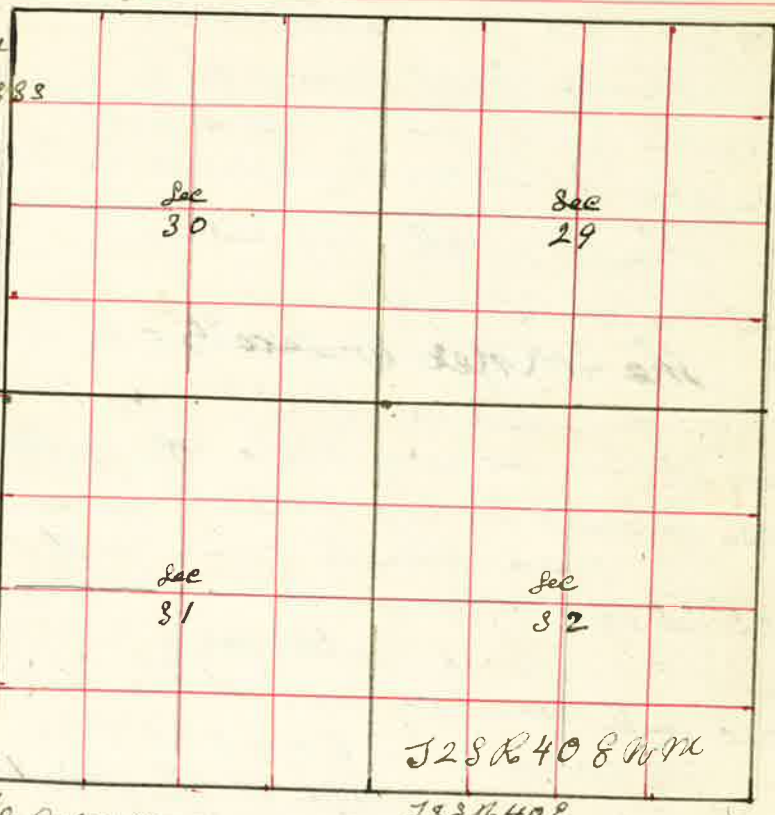

I commenced at the established corner to Sec 20=21=28 & 29

Thence South var 19° 45' E

4000 Set Temporary 1/4 Sec corner

8000 Set " Post for corner to Sec 28=29=32 & 33

Thence South var 19° 45' E

2000 Set Stake for Temporary 1/8 corner

4000 " " " " 1/4 Sec corner

6000 " " " " 1/8 corner

8084 Intersect South Boundary Township at the corner to Sec 4=5=32 & 33 making an excess of 84 links over U.S. Field Notes

I therefore run North

2010 1/4 Set Stone 6 x 8 x 16 inches for 1/8 corner

4021 Set Stone 9 x 11 x 20 inches for 1/4 Sec corner bet Sec 32 & 33

6081 1/4 Set Stone 8 x 9 x 16 in for 1/8 corner

8042 Set Stone 6 x 8 x 16 " for corner to Sec 28=29=32 & 33

Thence North var 19° 45' E

4027 Set Stone 11 x 12 x 22 inches for 1/4 Sec corner bet Sec 28 & 29

The corner to Sec 27=28=32 & 34

Thence West var 21° 45' E

8000 Set Stake for Temporary corner to Sec 28=29=32 & 33

Thence West var 20° E

4500 Offset North 400 lbs

Thence West on offset var 20° E

5850 Offset South on line 200 lbs to Grand River 200 lbs wide runs N 80° W

Surveyed for J. F. Smith Wm Booth & A. E. Eaton Aug 27 1889

Thence West on line var 20° E
5970 Set Stake for Temporary 1/8 corner
7960 Set " " " corner to Sec 29=30=31 & 32

Thence West var 20° 15' E
8135 Intersect West Boundary of Township 50 lbs north of one to be making an excess of 135 lbs over the U.S. Field Notes

I therefore run East and at
8045 Set Post for corner to Sec 29=30=31 & 32

Thence East
2002 1/2 Set Stone 6 x 8 x 20 " for 1/8 corner
8010 The corner to Sec 28=29=32 & 33 a Stone 6 x 8 x 16

Thence East var 20° E
8045 The corner to Sec 27=28=33 & 34

The corner to Sec 5=6=31 & 32 on T. line
Thence North var 20° E

4020 The 1/4 Sec corner bet Sec 31 & 32

8041 The corner to Sec 29=30=31 & 32

Thence North var 20° E
3634 Grand River 297 lbs wide runs S 35° W

4020 Set Temporary 1/4 Sec Post
8046 The corner to Sec 19=20=29 & 30 making an excess of 86 lbs over U.S. Field Notes

I therefore run South
4022 1/2 Set Stone 7 x 6 x 21 inches for 1/4 Sec corner bet Sec 29 & 30
8048 The corner to Sec 29=30=31 & 32

Thence South
4021 The 1/4 Sec corner bet Sec 30 & 32

Thence East
2003 Set Stone 6 x 8 x 12 for 1/8 corner in center of Sec 32
2807 Grand River 147 lbs across runs North

4010 Set Stake for center
8022 East Boundary Sec 32. from which you west-
4011 Set Stone 8 x 8 x 21 for center Sec 32

Thence South var 20° E
4022 The 1/4 Sec corner on South Boundary Sec 32 from which you North
2011 Set Stone 7 x 8 x 12 for 1/8 corner in center of Sec 32

J. W. Fairbairn County Surveyor