

Surveyed for John McKinis, E. Wade Brooks & J.S. Clark Oct 22 1889

Thence South var 0° E  
 around Round River 238 lks across runs East-  
 around mo 1/4 sec corner  
 and no line

Thence South  
 and no 1/4 sec corner  
 to Sec 27-28 = 33 & 34 making an Excess  
 of 92 lks over U.S. Field Notes I therefore run  
North var 20° E allowing 30 lks to the mile  
 to stake for corner to Sec 15-16 = 21 & 22

Thence North var 20° E  
 to stone 5x12x28 for 1/4 corner  
 to stone 5x16x22 for 1/4 sec corner bet Sec 15 & 16  
 to corner to Sec 4-10 = 15 & 16  
 1/4 sec corner bet Sec 15 & 16  
Thence west through center Sec 16 var 20° E

Temporary cut Sec 16  
 intersect west boundary 7 lks North of 1/4 sec corner bet Sec 16 & 17  
 from which

run East  
 center Sec 16  
 to boundary at 1/4 sec corner  
 the 1/4 sec corner bet Sec 9 & 16  
Thence South var 20° E

intersect E & W line at center  
 intersect South boundary at 1/4 sec corner bet Sec 16 & 21

Surveyed for Steel Bros. A. Tarter C. Gaylord & J. Morgan Nov 7<sup>th</sup> 1889  
 By J.W. Kernell County Surveyor Plat No. 95.

I commenced at the 1/4<sup>th</sup> corner bet Sec 25 & 26  
 1 stone in Pine creek  
 from which  
 a willow 3 in to 358° & 32 lks  
 " " " 31° W 27 "  
Thence East through the  
 center Sec 25 var 20° E  
 leave Pine creek  
 200 Pine creek 60 lks wide S & E  
 2000 let temporary 1/16 corner  
 4000 " temporary 1/16 corner  
 for center Sec 25 -  
 6000 let temporary 1/16 corner  
 for center E 1/2 Sec 25 -  
 8022 intersect East boundary  
 86 lks North of 1/4 sec corner  
 bet Sec 25 & 30 on temporary  
 from which  
run west var 19° 30' E

2021 center E 1/2 Sec 25 - 9 stones 8x10x18  
 4042 center Sec 25 - a stone 8x9x18 from which an apple 4 in to 340° W 105 lks  
 6032 let stone 7x9x16 from which a pine 16 in dia. bro 817° & 28 lks  
 8022 the 1/4 sec corner bet Sec 25 & 26 " 22 " " N 11° & 41 "

the 1/4 sec corner bet Sec 25 & 36  
Thence North var 20° E cottonwood 8 in to 350° W 73 lks  
 " " " N 8° & 5 "  
 725 Pine creek 50 lks wide runs East -  
 2000 let temporary 1/16 corner in center E 1/2 Sec 25 -  
 4000 let temporary State for center Sec 25 -  
 6000 let temporary 1/16 corner in center N 1/2 Sec 25 -  
 8020 intersect North boundary 30 lks west of 1/4 sec corner bet Sec 24 & 25 -  
 from which

run South on true line 20° E  
 to 1/4 sec corner bet Sec 25 & 26

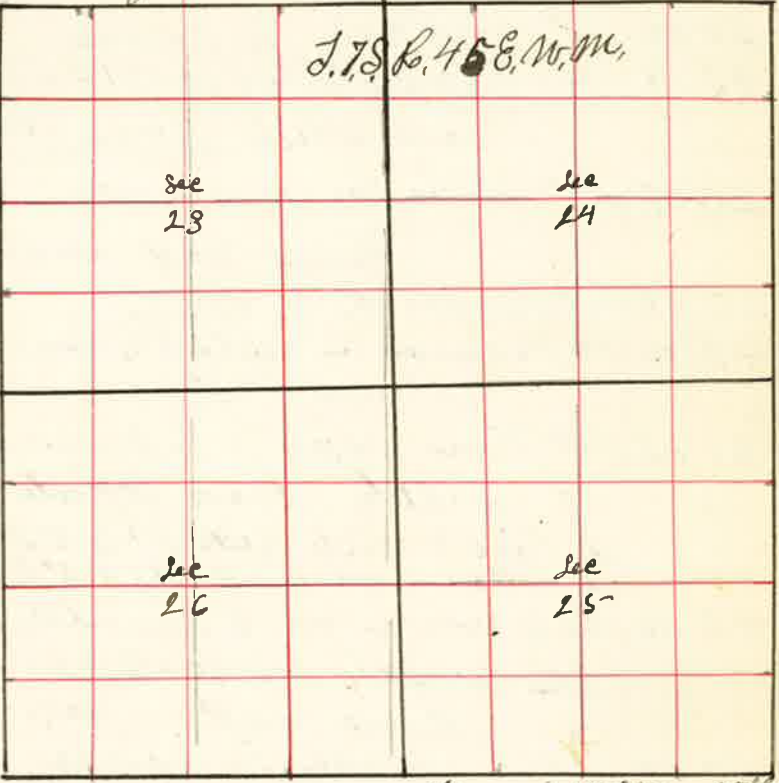

Surveyed for Steel Bros A Tartu C Gaylord & Cug Morgan Nov 1 1889

The 1/4 Sec corner on East Boundary Sec 25 -  
Thence South var 20° E

Let temporary 1/8 corner  
The corner to Sec 30=31=25 & 36 on Range line  
From which I run North

Let Stake for 1/8 corner  
Thence West var 20° 30' E

Let temporary 1/16 corner  
The 1/16 corner in center S 1/2 Sec 25 - from which  
I run East

Let Stone 8 x 11 x 18 inches in mound of Stone in Bed  
of Creek from which  
a Pine 5 inch dia. has N 28° W 80 lbs  
a cotton wood 5 inch dia S 2° E 111 lbs  
The 1/8 corner on E Boundary S 1/4 Sec 25 -  
The corner to Sec 30=31=25 & 36  
Thence West var 20° E

Let temporary 1/8 corner  
The 1/4 Sec corner bet Sec 25 & 36 from which  
I run East  
Let Stone 9 x 11 x 18 inches from which  
a Pine 14 inches has N 30° W 188 lbs  
" 22 " " S 5° 30' W 69 lb  
Thence North var 20° E

The center S E 1/4 Sec 25 -  
The center S 1/2 Sec 25 -  
The corner to Sec 24=25=19 & 30 on Range line  
Thence West var 20° E

Let temporary 1/8 corner  
The 1/4 Sec corner bet Sec 24 & 25 - from which  
I run East

Let Stone 6 x 11 x 18 inches

Surveyed for Steel Bros A Tartu C Gaylord & Cug Morgan Nov 1 1889

The Center S 1/2 Sec 25 -  
Thence West var 20° E

500 Creek runs S E  
1800 " " S E  
2000 Let temporary 1/16 corner in center S W 1/4 Sec 25 -  
4004 Intersect West Boundary Sec 25 -  
42 lks North of 1/8 corner from which  
I run East on True line var 20° 30' E

2002 Let Stone 9 x 15 x 22 for 1/16 corner from which  
an asp 6 inches has S 69° W 88 lbs  
" 5 " " N 47 1/2° E 25 "

4004 The 1/16 corner in center S 1/2 Sec 25 -  
The corner to Sec 25=26=35 & 36  
Thence North var 19° E

~~1445~~  
1445 The 1/8 corner  
79 90 The 1/4 Sec corner bet Sec 25 & 26

The 1/4 Sec corner bet Sec 24 & 25 -  
Thence North var 20° E

2000 Let temporary 1/16 corner in center S 1/2 Sec 24

4000 Let temporary 1/16 corner in center Sec 24  
81 20 Intersect North Boundary 61 lks west of  
1/4 Sec corner bet Sec 24 & 13  
Thence South on True line

81 20 South Boundary Sec 24  
The 1/4 Sec corner on East Boundary Sec 24  
Thence West var 20° E

2000 Let temporary 1/16 corner in center S 1/2 Sec 24  
39 98 Intersect N of S line through center 50 lks North of first stake  
6000 Let temporary 1/16 corner in center NW 1/4 Sec 24  
" Intersect West Boundary 51 lks South of 1/4 Sec corner

