

N.P.R.
 Killian Jc. to Athena Right of Way Plat
 State of Oregon County of Umatilla
 Sec. 27 Township 5 N. Range 34 E. of Willamette Meridian

Scale 400ft. 1. Inch

Note: Boundary of Right of Way denoted thus.....

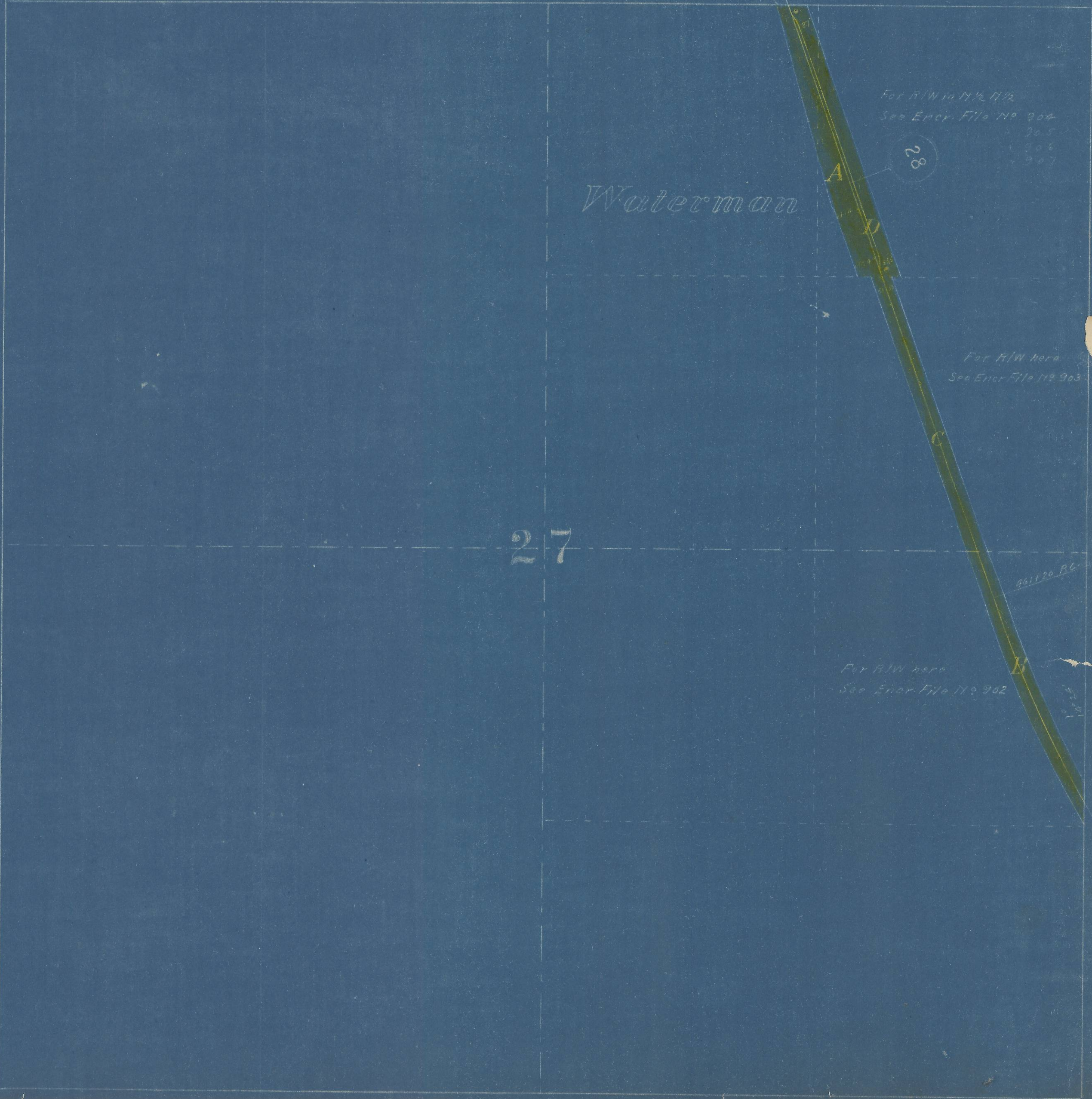

27

Waterman

For R/W in N 1/2 N 1/2
 See Encl. File No 904
 905
 906
 907

28

For R/W here
 See Encl. File No 903

For R/W here
 See Encl. File No 902

961120 P.C.

1072