

UMATILLA INDIAN RESERVATION

Township No. 2 North, Range No. 34 East, Willamette Meridian in Oregon.

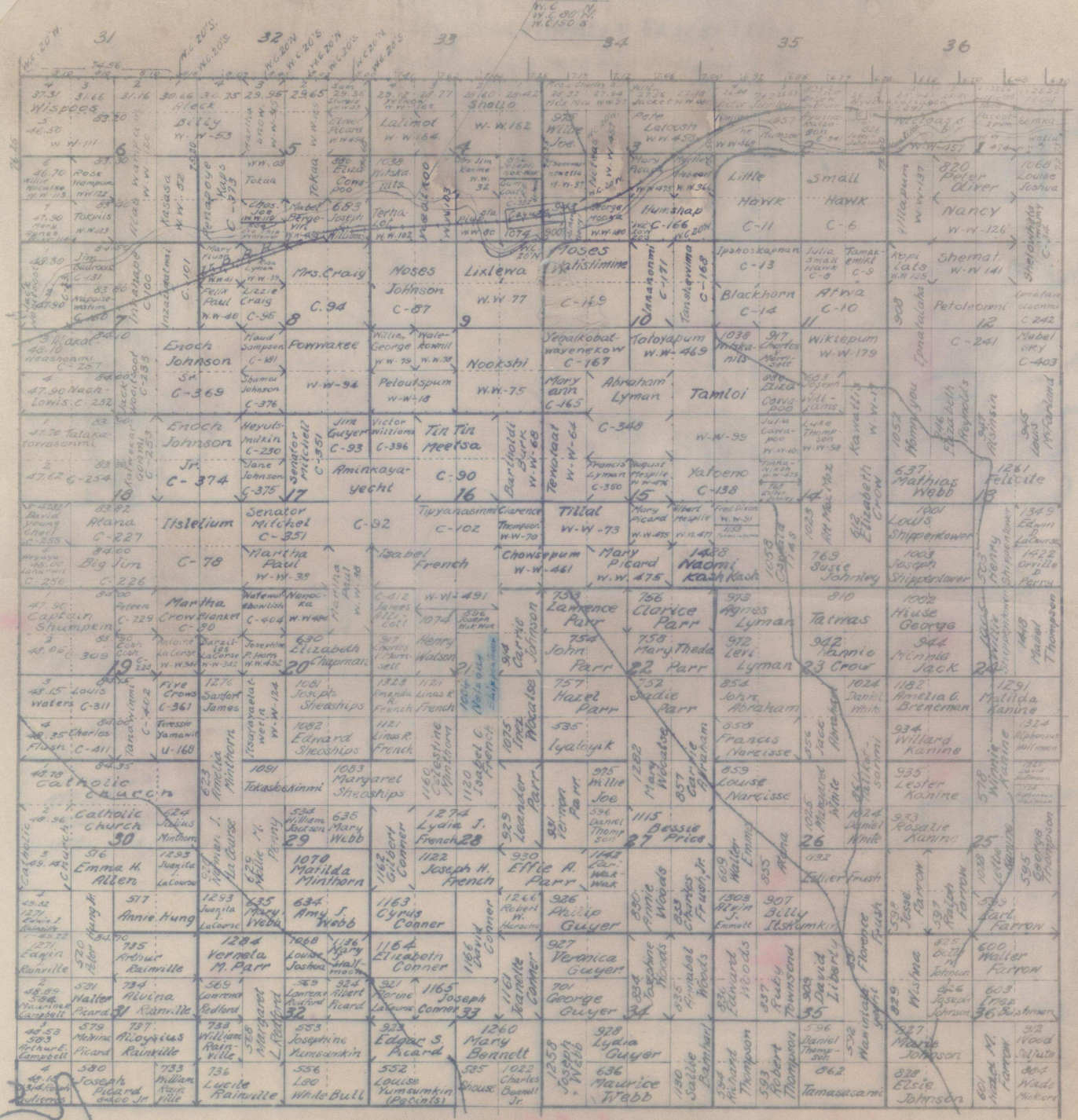

Pat. No. Name

900 Eugene Lavandour. Patented land shown thus reserved from allotment

763 Esther Johnley Railroad shown thus

1153 Townon Yapum. Roads shown thus

1224. Nelson Shippentower.

1074 Henry Watson.