

NE<sup>4</sup> & N<sup>2</sup> NW SECTION 6  
 LOUIS HOFFMAN ET UX  
 W PE-29 6.11 ACRES  
 C/L R/W LENGTH 5326 FT.

NE<sup>4</sup> SECTION 1  
 C. M. WHITE  
 W PE-30 3.01 ACRES  
 C/L R/W LENGTH 2621 FT.

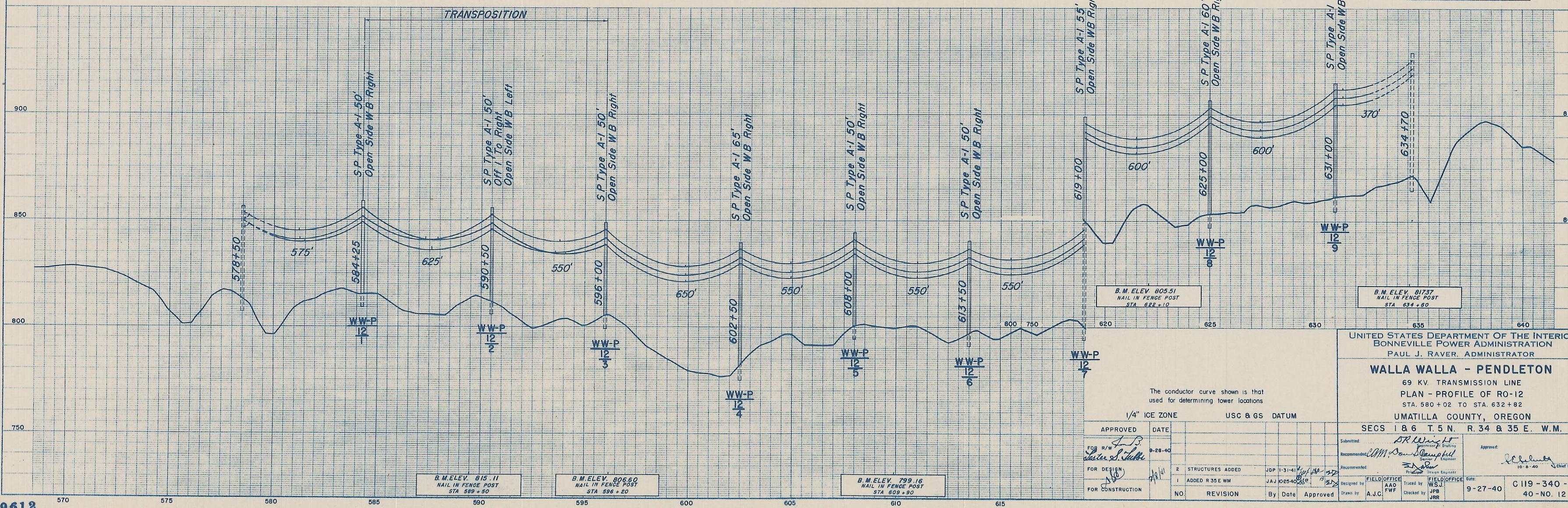
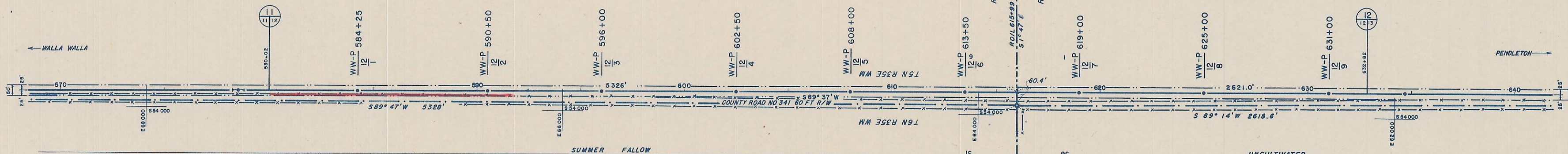

UNITED STATES DEPARTMENT OF THE INTERIOR  
 BONNEVILLE POWER ADMINISTRATION  
 PAUL J. RAYER, ADMINISTRATOR

**WALLA WALLA - PENDLETON**  
 69 KV. TRANSMISSION LINE  
 PLAN - PROFILE OF RO-12  
 STA. 580+02 TO STA. 632+82  
 UMATILLA COUNTY, OREGON  
 SECS 1 & 6 T. 5 N. R. 34 & 35 E. W.M.

APPROVED	DATE	FOR R/W	FOR DESIGN	FOR CONSTRUCTION	NO.	REVISION	By	Date	Approved	Drawn by	Checked by	FIELD OFFICE AAO FWF	FIELD OFFICE JPB JRR	Date	Sheet No.	Project No.
<i>[Signature]</i>	9-28-40	<i>[Signature]</i>	<i>[Signature]</i>	<i>[Signature]</i>	2	STRUCTURES ADDED	JDP	1-31-41	<i>[Signature]</i>	<i>[Signature]</i>	<i>[Signature]</i>	A.J.C.	W.S.J.	9-27-40	C119-340-D1	40-NO. 12